

*A View Towards Excellence*

# **Installation Guide**





## Before You Begin

- Read through the instructions before you begin, and contact technical support with any questions before you begin*
- Installation requires 2 people*
- Each screen system is custom made to each specific application*
- Screens should be stored inside original packaging until the screens are ready to be installed*
- Before installation inspect all products and components*
- Damaged or missing components should be reported immediately to [orders@wizardscreens.com](mailto:orders@wizardscreens.com)*
- It is recommended that you install screens after door installation is complete and finished*
- Do not pull out screen system until tracks are in position*
- Support the pull-bar when handling the housing - The mesh and pull-bar are connected using spline only, allowing the mesh to glide up and down. Be careful the pull-bar doesn't slide directly off the mesh to avoid damaging the endcaps*
- If installing screen system directly onto door frame and threshold, be sure not to fasten into any areas that may impact the performance of the door and hardware. Consult door manufacturer if needed.*
- Depending on the application and installation plan you may need to source different length fasteners to install tracks*
- Upper tracks are fastened HORIZONTIALLY*
- Overtightening the spring may cause damage – before adjusting spring ensure tracks are level, and housing is plumb, level and square*
- When installing, if you have questions, call us before leaving the site if possible 888-949-3667*

## Cutting tracks – Singles, Doubles and Corners

### Measuring cut length for Single Doors

Single doors



Measuring cut length for Double Doors when meeting in middle (Offset doors next page)

Doubles, deduct ½" and divide by 2 for length of each side



### Measuring cut length for Corners

External Corner Configuration\*

Internal Corner Configuration\*

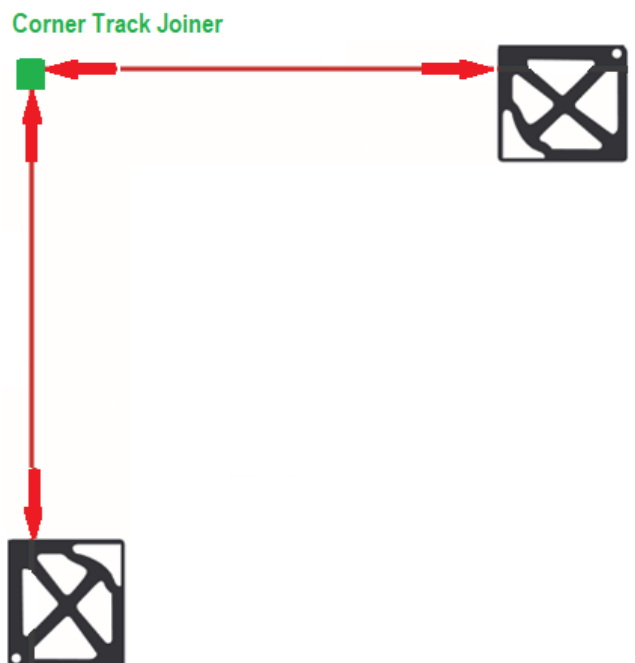
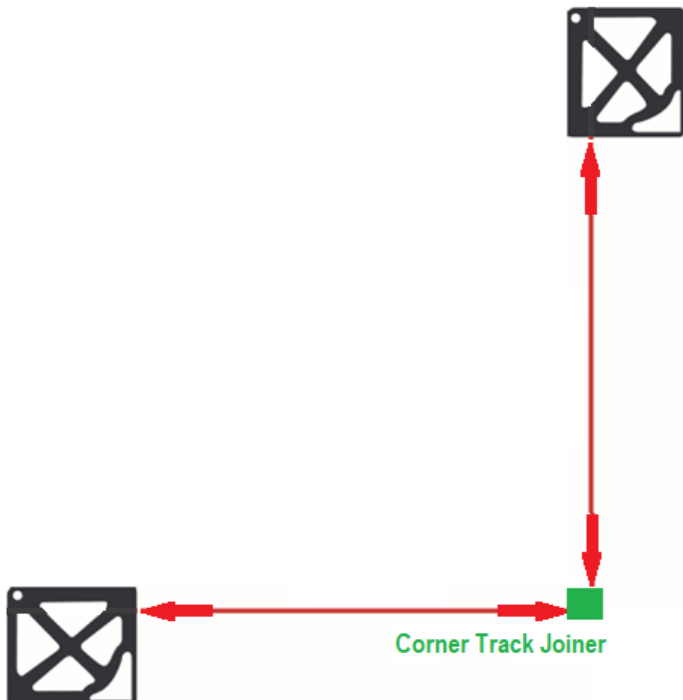

## Measuring track – Double and Corner Doors

Installation of a Double or Corner is similar to a single door – start by setting the two alignment jigs, then measure and cut the track lengths.

Double doors are build to meet in the middle with the pull bars stopping at the track joiners. On double doors that are ordered as “offset, the track joiner is not set at the mid-point, but is “offset” from center.

### Cutting the tracks

*Measuring track for Double Doors that meet in middle*

*Measure as below, from alignment jig to alignment jig, deduct ½” and divide by 2 for length of upper and lower tracks on each side*

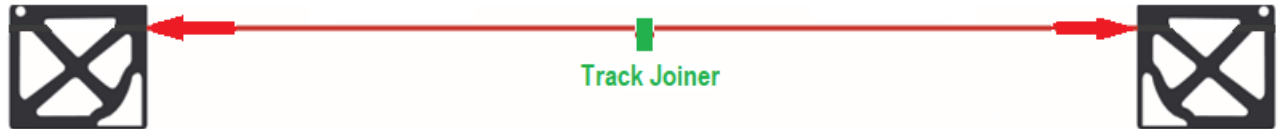

*Measuring track for “Offset” Double Doors – doors that do not meet in the middle*

*To cut tracks on an “offset” door, when the sides were ordered at different sides*

*Install your alignment jigs, and measure to the center-point of where you place the lower track joiner (the point where you want the pull bars to meet), and deduct ¼” from each side, then measure from the inside edge of the alignment jig to the inside edge of the track joiner*



## Upper and Lower Track Components

### Upper Track

#### Upper track Parts

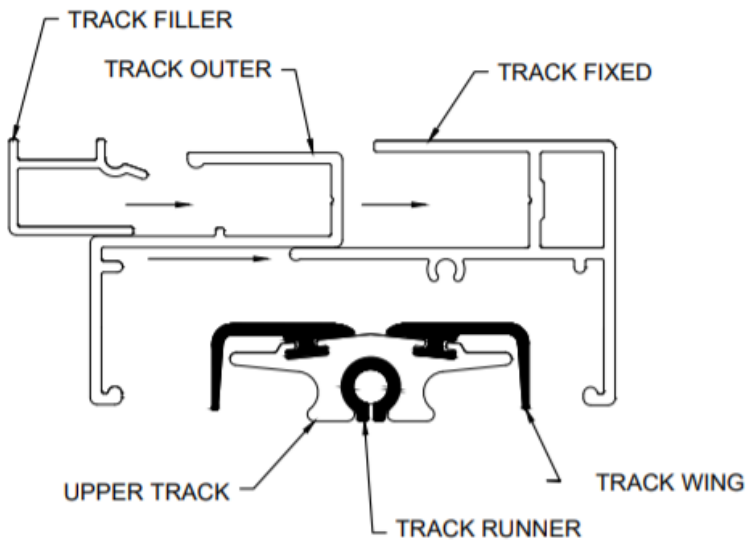

#### Upper Track – Surface Mount

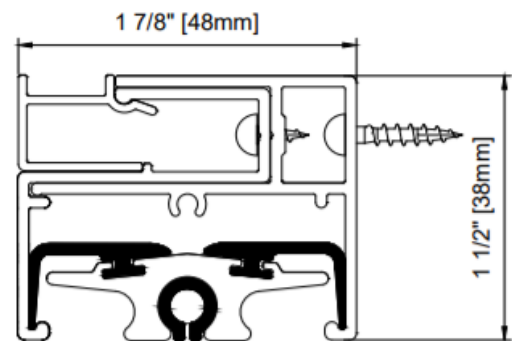

### Lower Track

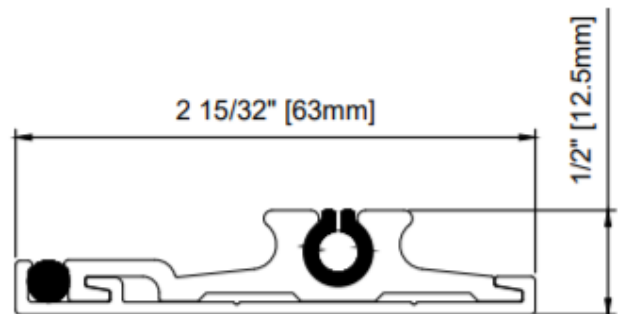
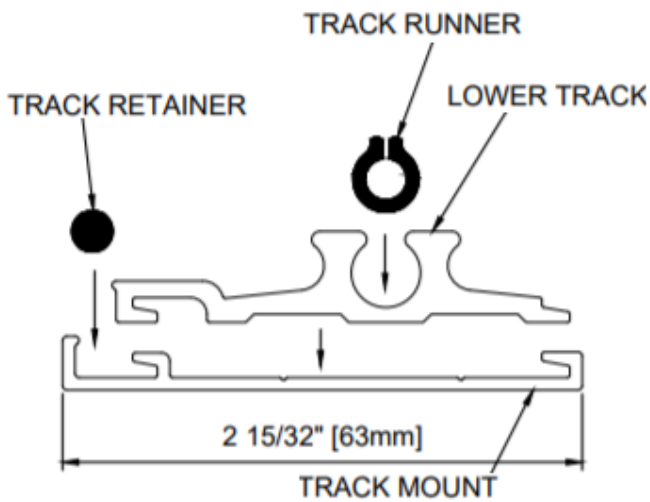

## Track and Box Channel Profiles

### Box Channel

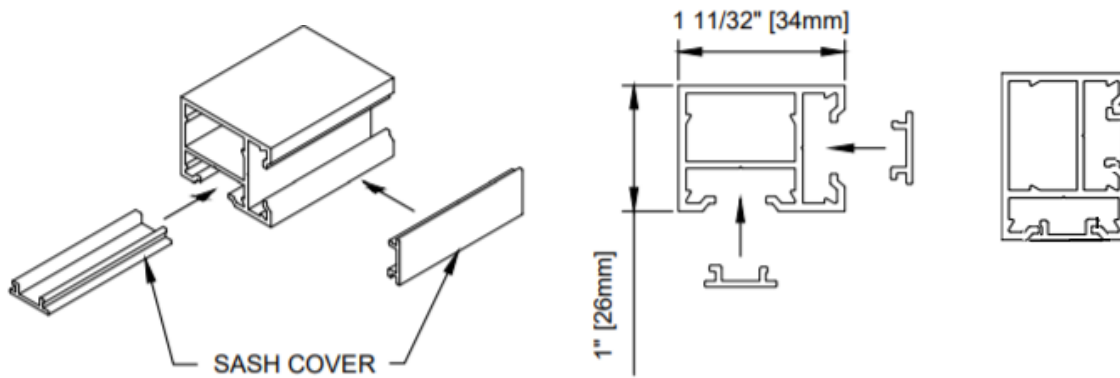

### Upper Track under Header with optional Box Channel (not to scale)

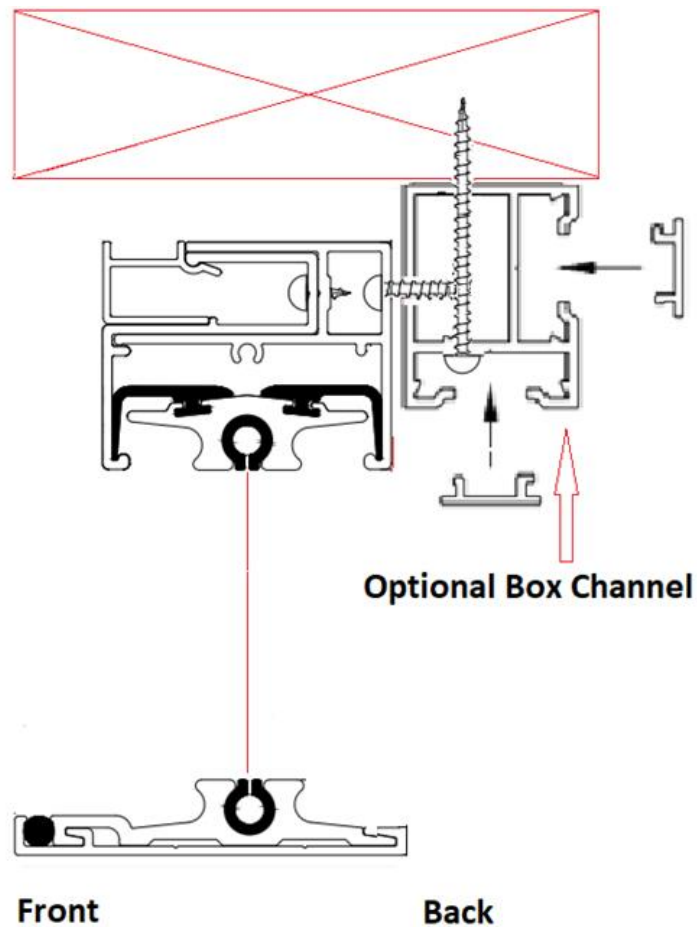

*Track Joiners - Double and Corner Doors*

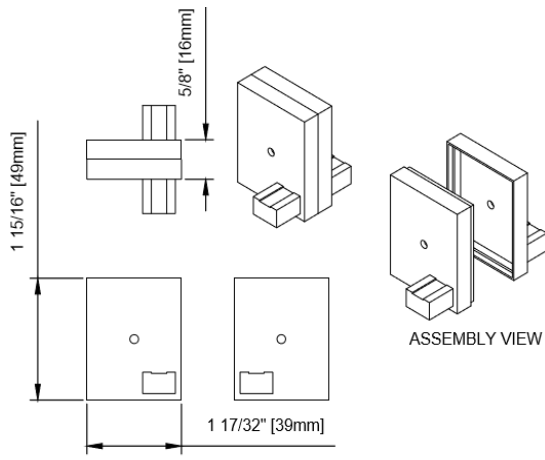

UPPER TRACK DOUBLE DOOR

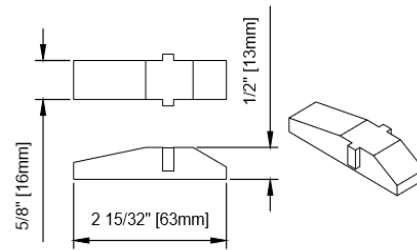

LOWER TRACK DOUBLE DOOR

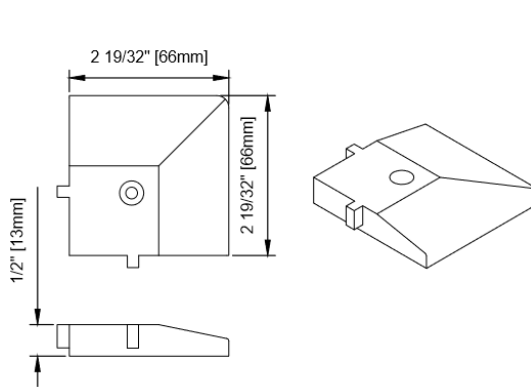

LOWER OUTSIDE CORNER DOOR

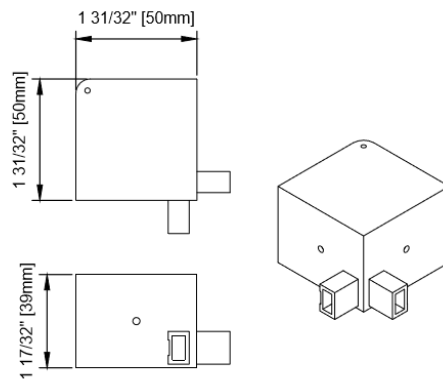

UPPER OUTSIDE CORNER DOOR

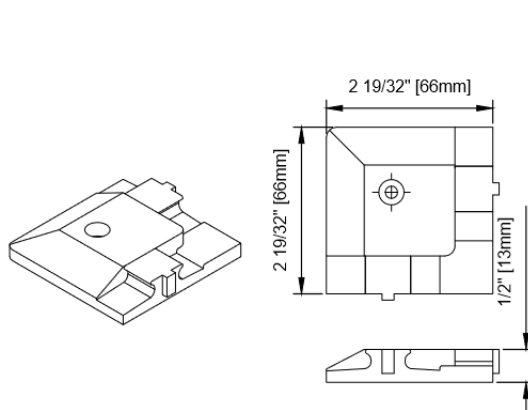

LOWER INSIDE CORNER DOOR

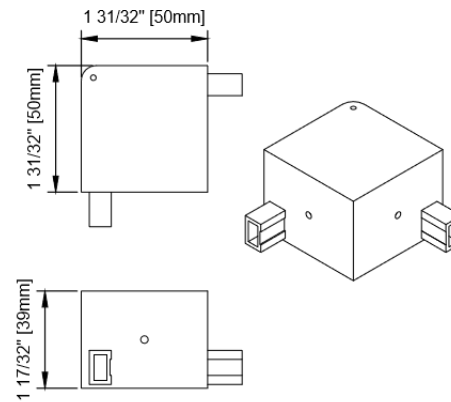

UPPER INSIDE CORNER DOOR



## Track Joiners - Double and Corner Doors

### Double track connectors

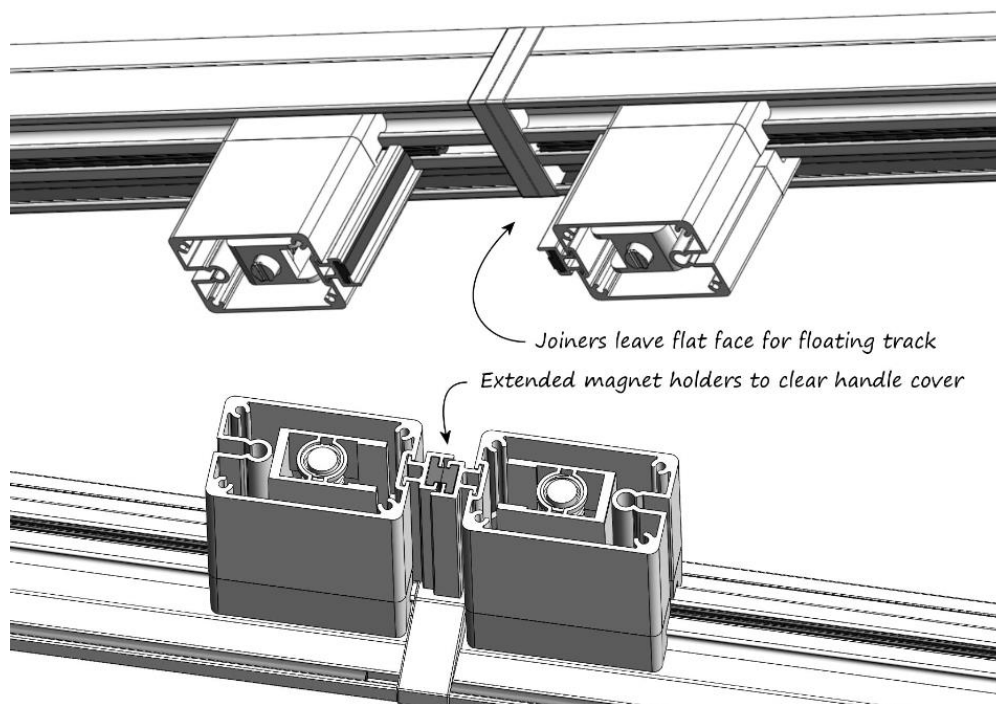

### Corner track connectors

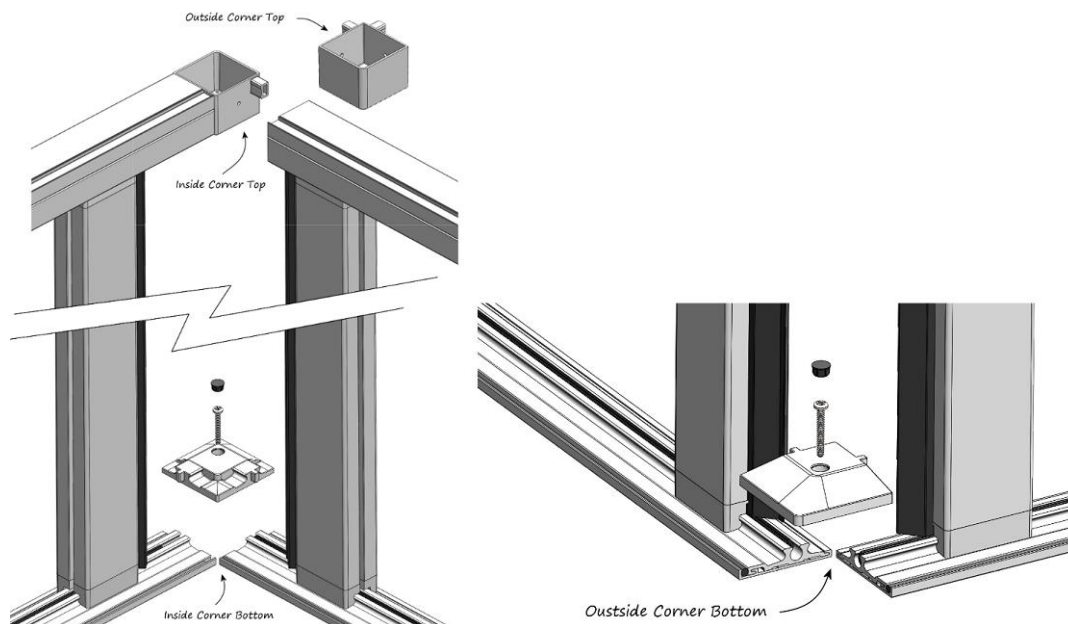



## Installation

Lower track and housing locator pins are fastened vertically down – ensure you have a level, flat mounting surface for the lower track and housing

### Lower Track Components

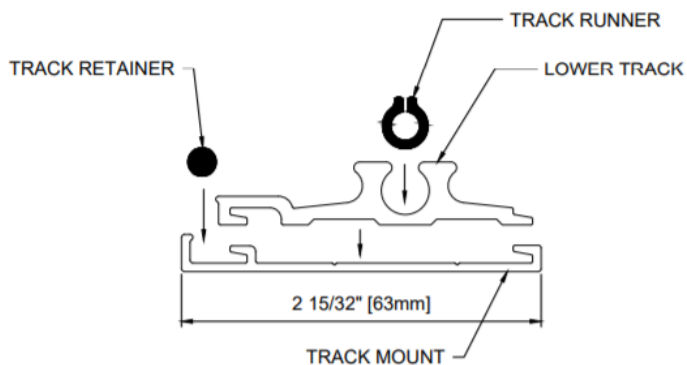

### Level / flat mounting surface

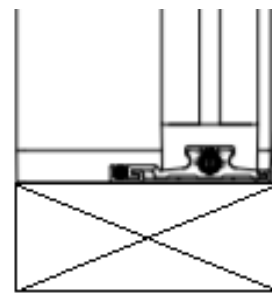

Install Housing Alignment jig, locator pins and lower track mount. Once everything secure remove the Alignment Jig and **Ensure Track Mount is Level Across Doors!**

- Single doors have one Alignment jig
- Double doors / Corners have two Alignment jigs

### Setting alignment pins and track mount

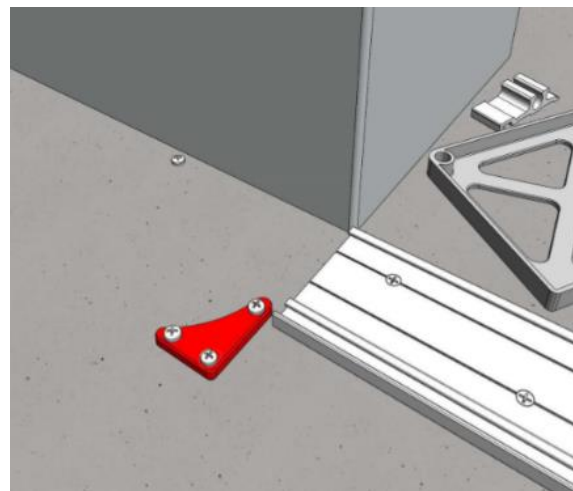
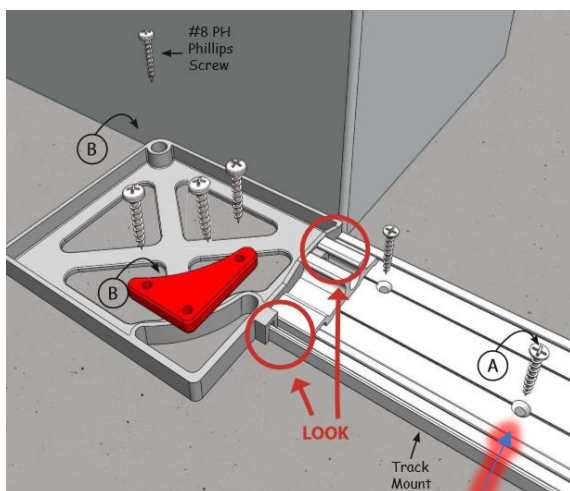

Countersink the screws flush

## Installation

Place Alignment Jig in position and fasten locaters "B" in place. Front locator is fastened with 3 screws, rear locator is a single screw – if the single rear locator cannot be fastened plumb to allow the housing to sit flat, it may be removed as **the housing must sit flat when installed.**

Align the lower track Mount to the alignment jig with a small piece of track and install the lower Track Mount using countersunk #6 stainless steel flat screws, ensuring the screws finish flush or below at "A" (see above) **MAKE SURE** the jig guide and lower track mount maintain alignment!

**Tip!** - use the lower track Mount as a drill guide to mark the hole locations for pre-drilling if required (example: for positioning screw plugs into tile floor)

Lower track: Measure and cut all lower track components at one time: ensure all track parts are flush at cutting end before cutting – see

- a. Single doors: Measure from inside of alignment jig to back of receiver channel location
- b. **Double doors: Measure from inside of the two alignment jigs, deduct  $\frac{1}{2}$ " for the track joiner, and divide by 2 – that is the length of each track**
  - i. **For "offset" doors that are not split 50:50, adjust track lengths accordingly as detailed in the "Offset" section**
- c. **Corner doors: place corner joiner in place and measure from the inside of the alignment jig to the inside edge of the corner track joiner (see Diagram)**

Measure and cut all upper track components at one time, and at the same dimensions as you cut the lower track - ensure all track parts are flush before cutting – after cutting, slide the black Lower Track Runner out and on single doors, remove  $\frac{3}{16}$ " at the housing end, for **Doubles and Corners deduct  $\frac{5}{16}$ " off each of the lower track runners**

## Installation

After cutting tracks, the upper tracks are fitted with the M3 pins to install the M3 pin, screw in, and remove, a screw first in the housing end of the upper track on all systems after cutting the tracks

- a. Singles doors have 1 M3 pin to connect the Upper Track to the housing
- b. *Doubles doors have 2 M3 pins to connect the Upper tracks to each housing*
- c. *Corners doors have 4 M3 pins to connect the Upper tracks to each housing, and also to the Upper Corner Track joiner*

### M3 Pin

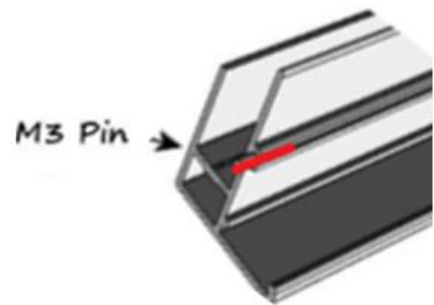
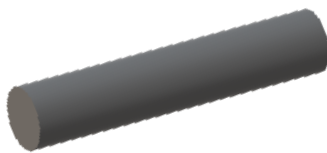
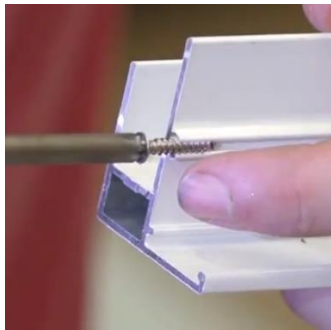

## Installation

*Push firmly down to ensure the housing sits flat and is plumb, front to back, and left to right*

*Housing: FLAT, PLUMB and LEVEL*

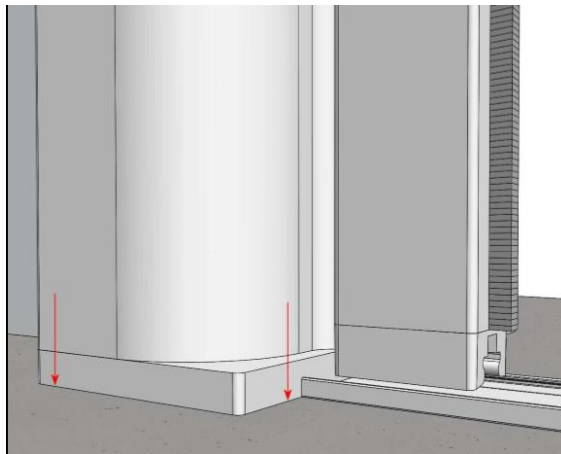

*Level the housing as shown & secure to the wall with #8 x 2" Phillips screws through the backer plate using an extended bit*

**Tip!** *The screws can be inserted into the backer & held with tape prior to fitting to make it easier, or a screw-holder can be used*

*Fastening upper housing through backer plate*

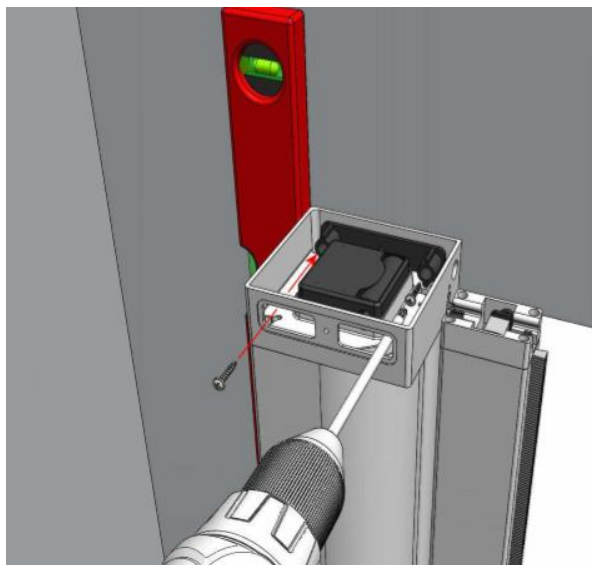



## *Installing track – Double and Corner Doors*

*Set the housings into place, and proceed to install the lower track mounts, then lift the pull bar on one side and gently feed the lower track runner onto the zipper, lower the pull bar and feed the track tight up to the housing in alignment with the spigot, repeat on the other side.*

*Lift tracks at the mid-point, screw in the lower track joiner – ensure the lower tracks are interlocked in the lower track mounts and insert the spline*

## *Lower Track Runners / M3 Pins*

*Single Doors – counter sink track runner after cutting*

<i>Lower track runner</i>	<i>Cut track runner by 3/16"</i>
---------------------------	----------------------------------

*Double Doors – counter sink track runner after cutting*

<i>Lower track runner</i>	<i>Cut track runner by 5/16" – each side</i>
---------------------------	--

*Corner Doors – counter sink track runner after cutting*

<i>Lower track runner</i>	<i>Cut track runner by 5/16" – each side</i>
---------------------------	--

*Install the M3 Pins*

*Single doors have 1 M3 pin to connect the Upper track to the housing*

*Doubles doors have 2 M3 pins to connect the Upper tracks to each housing*

*Corners doors have 4 M3 pins to connect the Upper tracks to each housing, and also to the Upper Corner Track joiner*

## Installation

***Cut a wedge from the packing foam to lock the handle in the open position. This releases the top and bottom brake to allow the tracks to be positioned***

*Cut wedge to hold handle "open"*

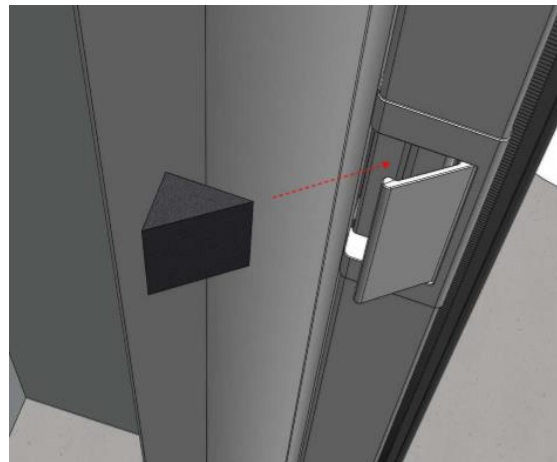

***Install the Lower track by sliding the Runner out of the lower track and GENTLY feed onto the zipper, and feed it flush against the housing***

***TIP! You can use the tip of a flat head screw driver to slide the runner out***

***Supporting pullbar and GENTLY sliding track runner onto zipper***

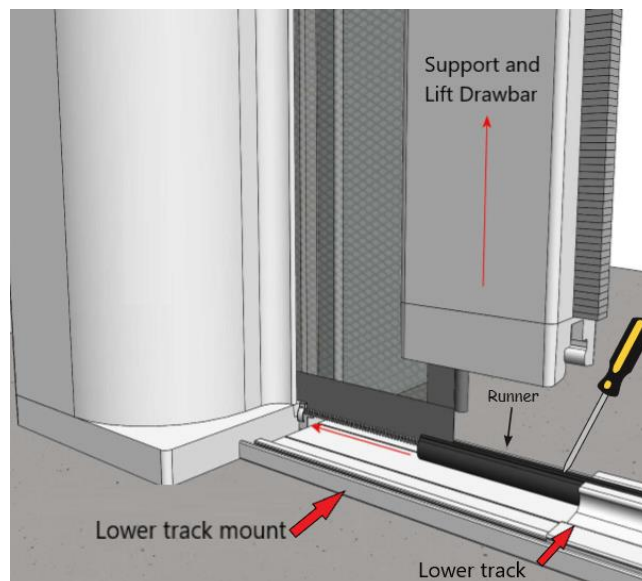

## Installation

*Slide the drawbar back onto the mesh, then slide the track through the drawbar & up to the housing*

*Hook the start of the track into the mounting track then slide it over the spigot on the housing. Ensure the track is pushed all the way up to the housing.*

*Locate the rest of the track into the mounting grooves, then push down & back to hook into place*

*Lower drawbar and feed track up to housing – ensure it is onto the spigot*

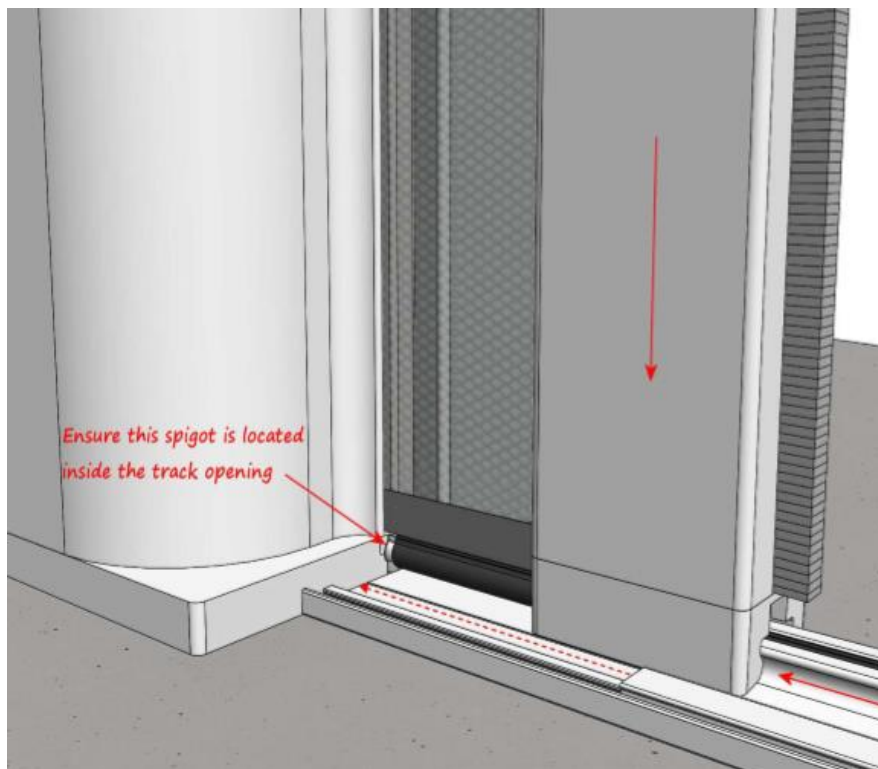



## Installation

*Secure the lower track in place by inserting the tubular spine into the groove, to prevent the track from unhooking from the mount*

*Starting at the opposite end to the housing, use a standard mesh spline roller to roll the spline into place being careful not to stretch it (If you stretch it, it will shrink back later leaving a gap).*

*Hint: Leave some extra spline hanging out at each end to allow a little shrink after fitting. This can be trimmed after the entire installation is completed.*

*When trimming it's best to leave an extra 5/32" & compress it into the track to allow for creeping.*

### Inserting spline into lower track mount

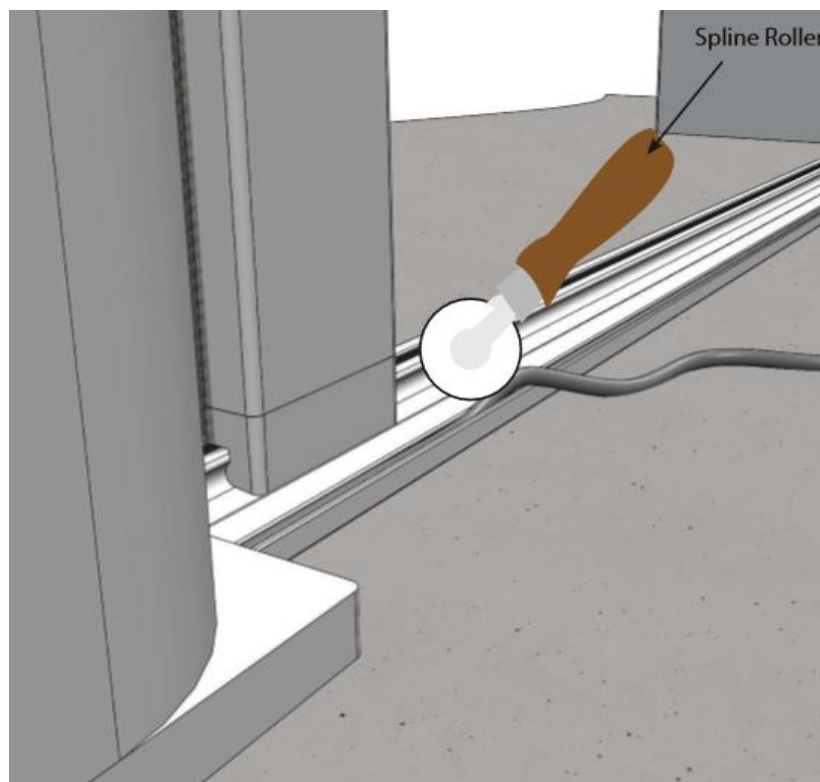

## Installation

*Fit HZL2-TF Track Fixed to the upper housing cap, ensuring the M3 pin is located within the alignment hole*

*Check the pin hasn't pushed back into the track. You should be able to view it through the endcap access window to confirm M3 pin fits into alignment hole*

*HZL2-TF Track Fixed*

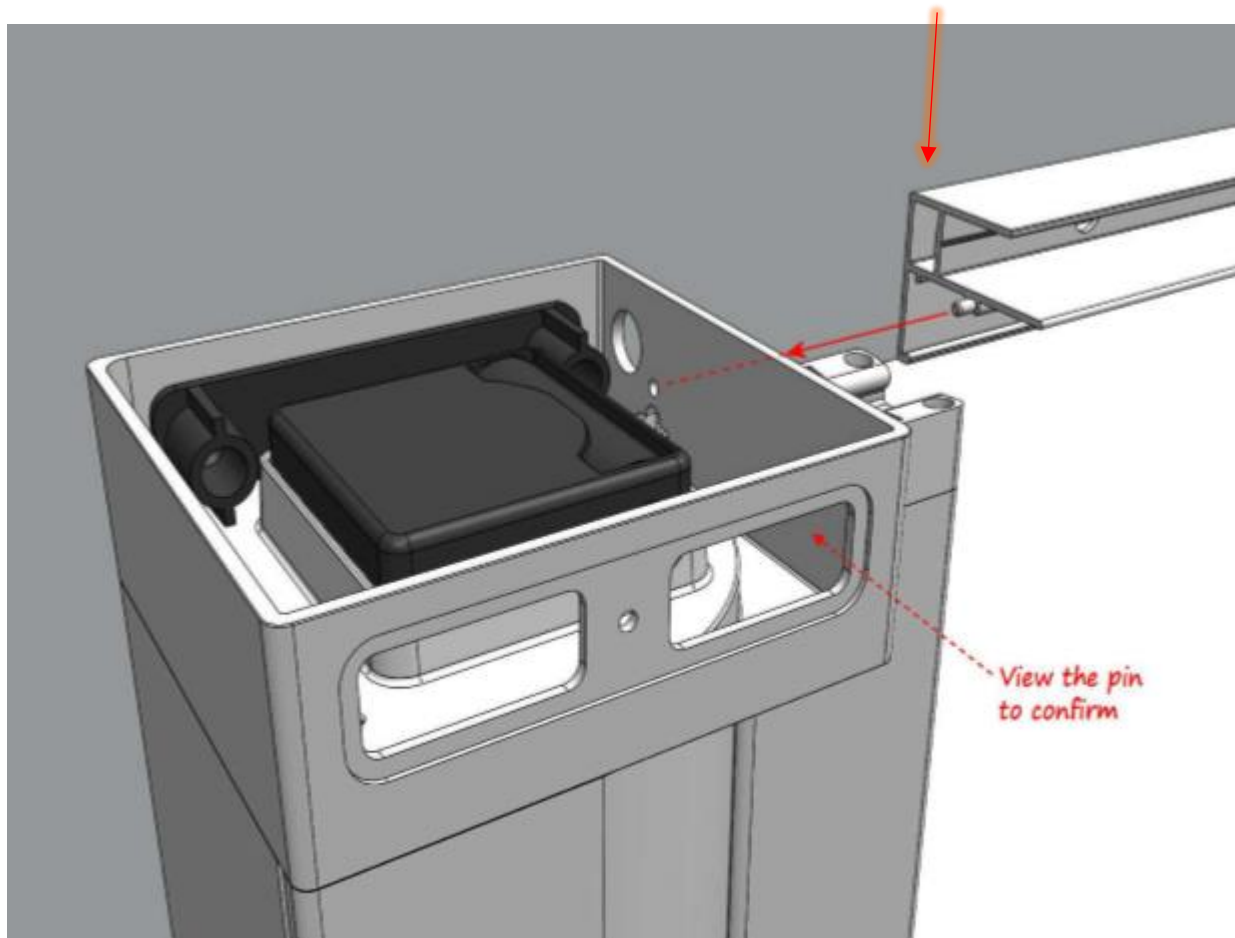

## Installing track – Double and Corner Doors

*Install one upper track fixed end with the pin into each housing – ensuring you are aligning with the alignment pin*

### Installation

*Optional Reveal fit inside the jamb for 100mm Systems*

*Remove the backer plate*

*Predrill a hole through the housing endcap*

*80mm Horizons cannot be mounted this way*

*Installing against the jamb (100mm only)*

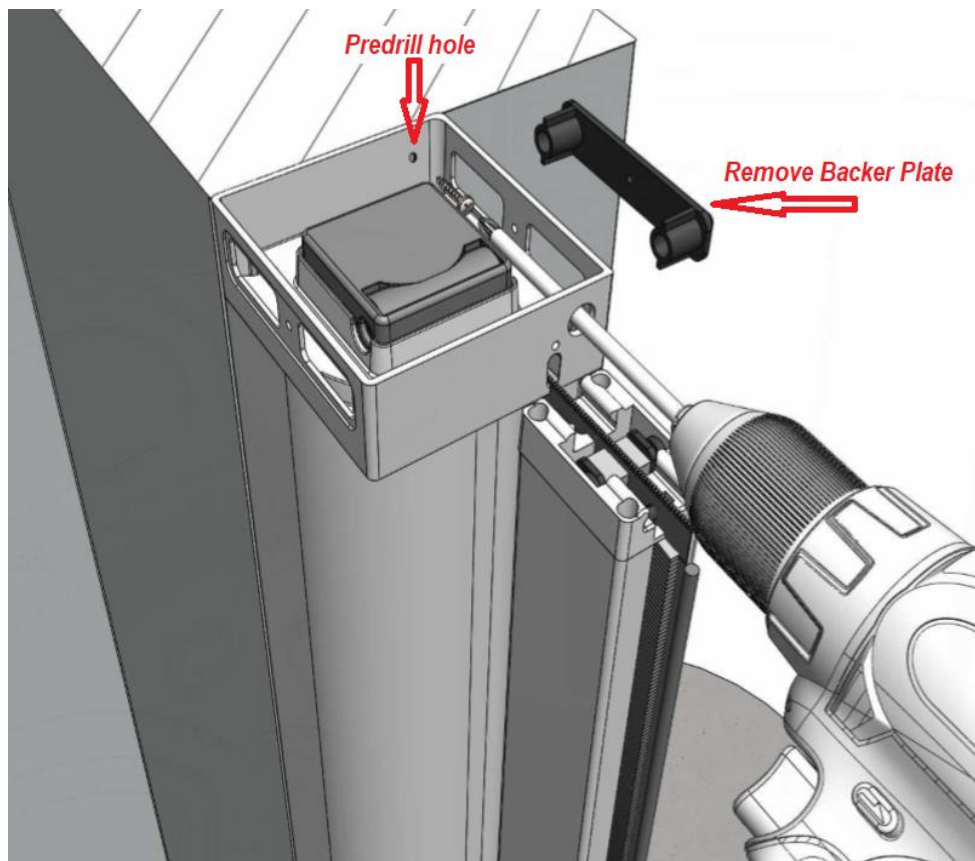

## Installation

Use the receiver to support the far end of the upper track for fixing. This acts as a guide to set the correct height (see next step). At the end of #1 Track Fixed, opposite to housing, place the receiver channel between the “Top and bottom tracks” (“top of the bottom track” to the “bottom of the top track”) and secure the upper track in place using the receiver channel as the height gauge

*Double and Corner doors have a single receiver channel provided only for the measuring to position the upper track*

Repeat the method by positioning the receiver beneath each screw location before fixing to ensure top & bottom tracks remain parallel (see next step)

Receiver channel is used to set correct upper track height

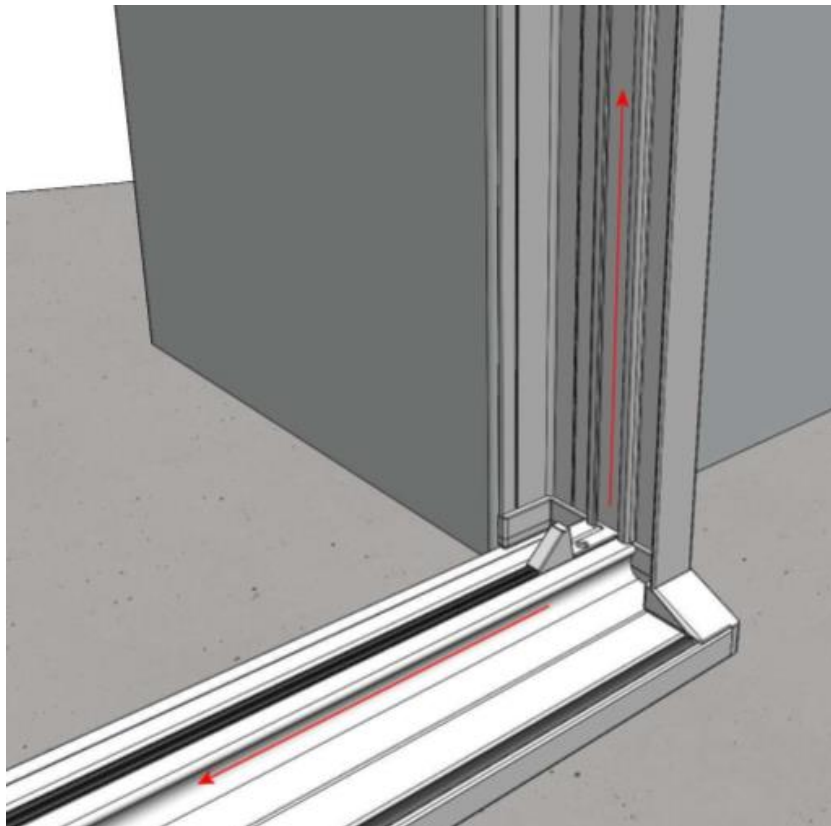

## Installation

*With the top track supported by the receiver, fix in place with #6 x 1" screws through the pre-drilled mounting holes*

*Repeat previous step for all mounting holes to ensure both tracks remain parallel*

*Fastening upper track outer mount, using receiver channel for correct height gauge*

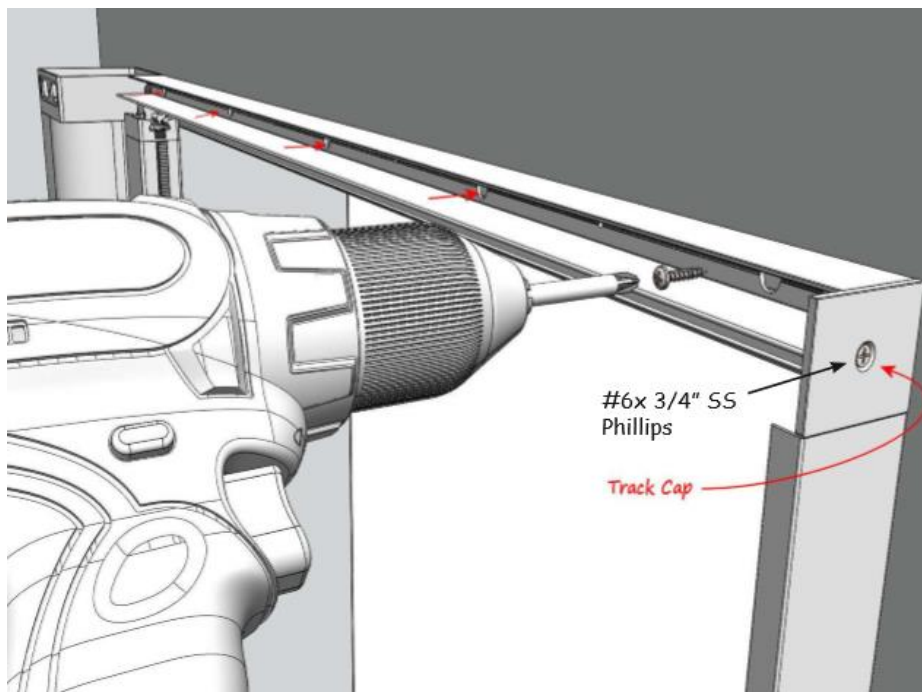

## Installing track – Double and Corner Doors

*Using the receiver channel provided, temporarily fasten the opposite ends of the upper track with a single screw (with the upper track joiners) with single screw, repeat on the other upper track, and set the correct height on this track by using the receiver channel as you would on a single door. When this side is correctly positioned, remove the single screw on the other side and using the receiver channel to set the track to the correct height.*

## Installation

*Lift the upper track into position adjacent the upper drawbar cap*

*Allow the far end to flex downward to allow it to fit within a reveal during installation. (this diagram shows face fit) – support both ends*

### Installing upper track

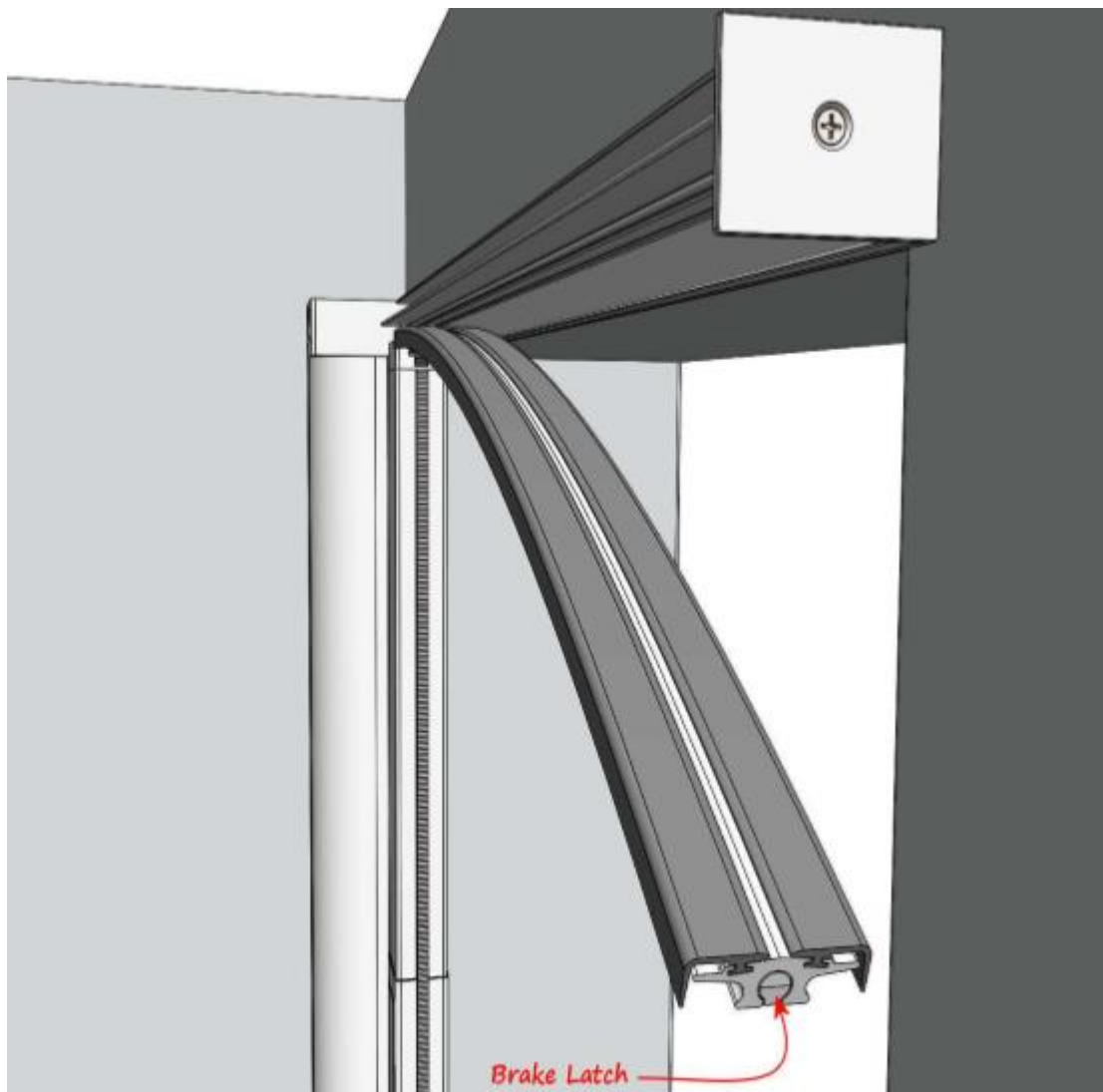

## Installing track – Double and Corner Doors

*Once both sides are at the correct height, install the upper track and wings, and screw in the outer track cover on both sides – install the track filler strip.*

### Installation

*Ensure the “track runner” is protruding approximately 6” to allow easy feeding over the zipper*

*Gently feed track runner onto zipper like the lower track*

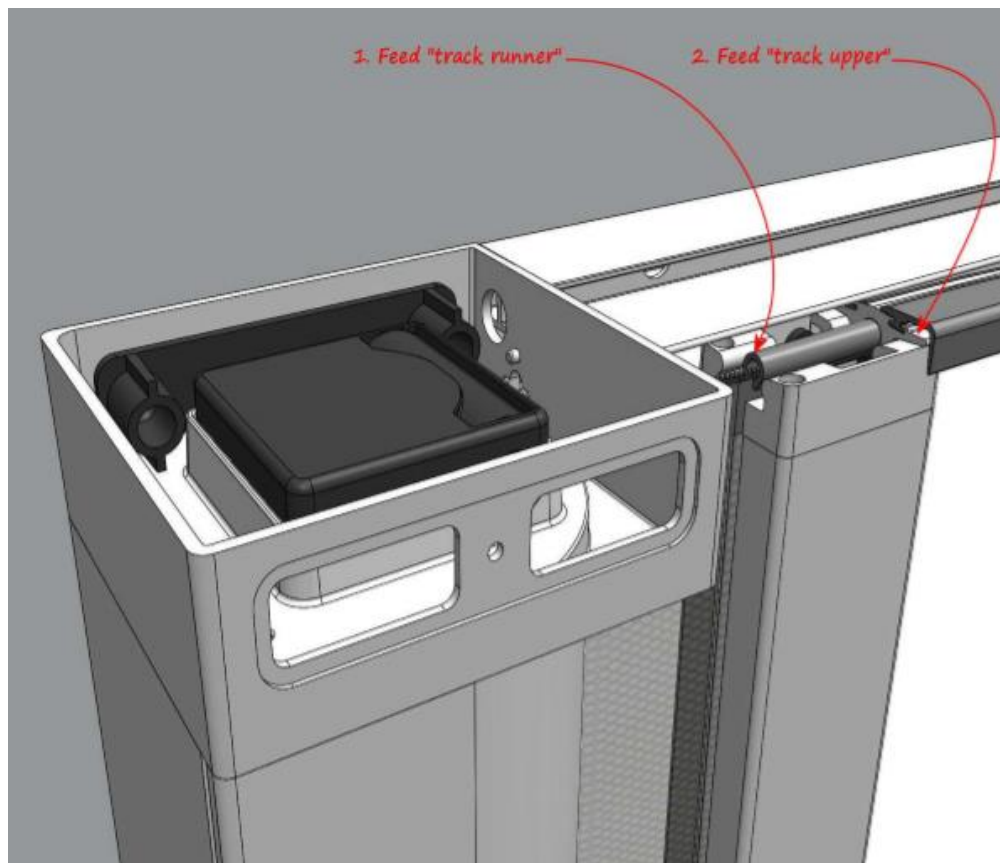

*Once the runner is located over the zip, continue to gently feed the upper track through the drawbar & up to the housing.*



## Installation

*Insert HZL2-TO Track Outer & screw into position using #8 x 1/2" screws in the pre-drilled holes*

*Next clip the "Track-filler" into place to cover the screws.*

*Note: Ensure the "wings" on the top track are tucked into position on both sides.  
(See detail)*

### Installing outer track and filler

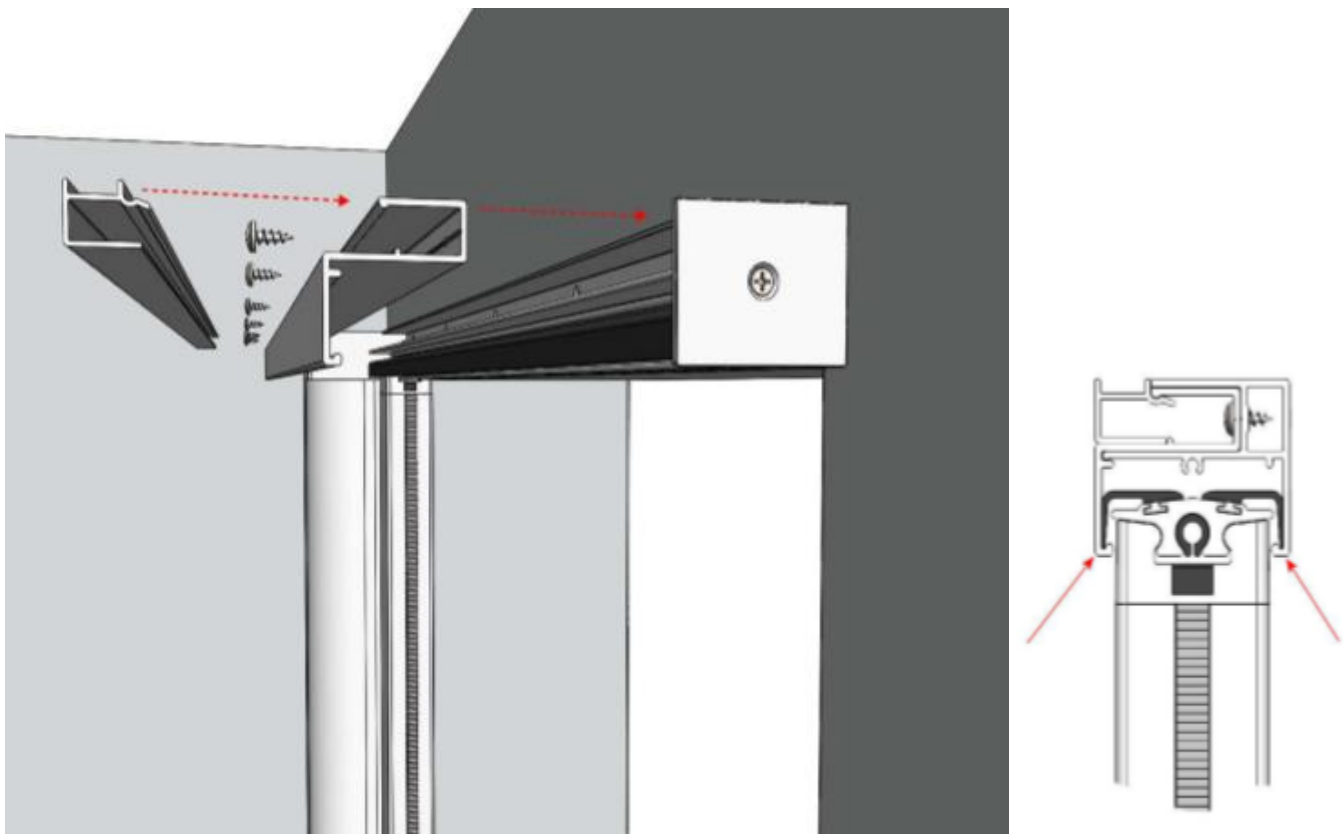

## Installation

*Screw "Receiver" into position using #6 PH screw (painted)*

*Fasten receiver channel*

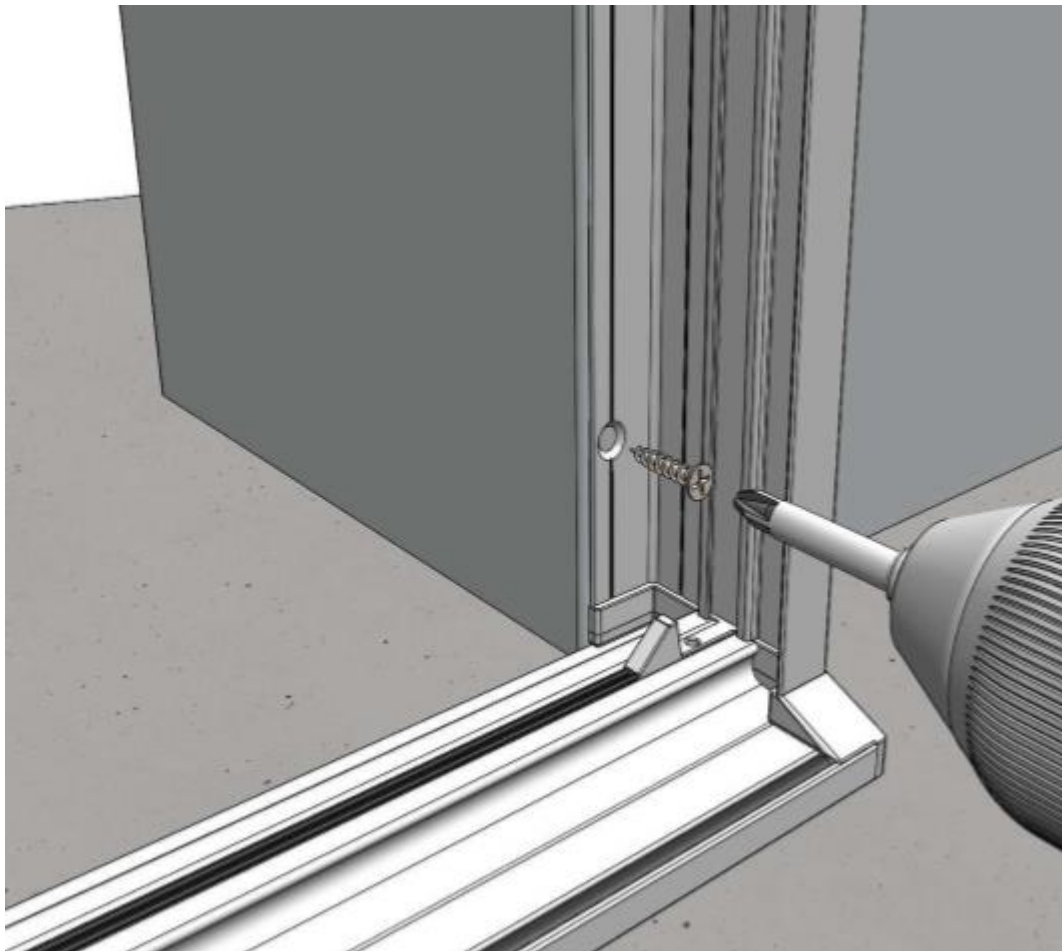

*Spray bottom track & runner with silicone spray wiping away any excess.*

*Slowly pull the drawbar across to test. If any resistance is felt immediately stop & allow the screen to retract again.*

*Repeat this process until the screen fully opens & retracts freely.*

## Installation

*Apply the logo decal over the access window opening.*

*Fit the “Endcap plug” into the top of the housing(s)*

*Note: On tight installations or reveals this may need to be fitted prior to installation.*

### Housing top endcap plug

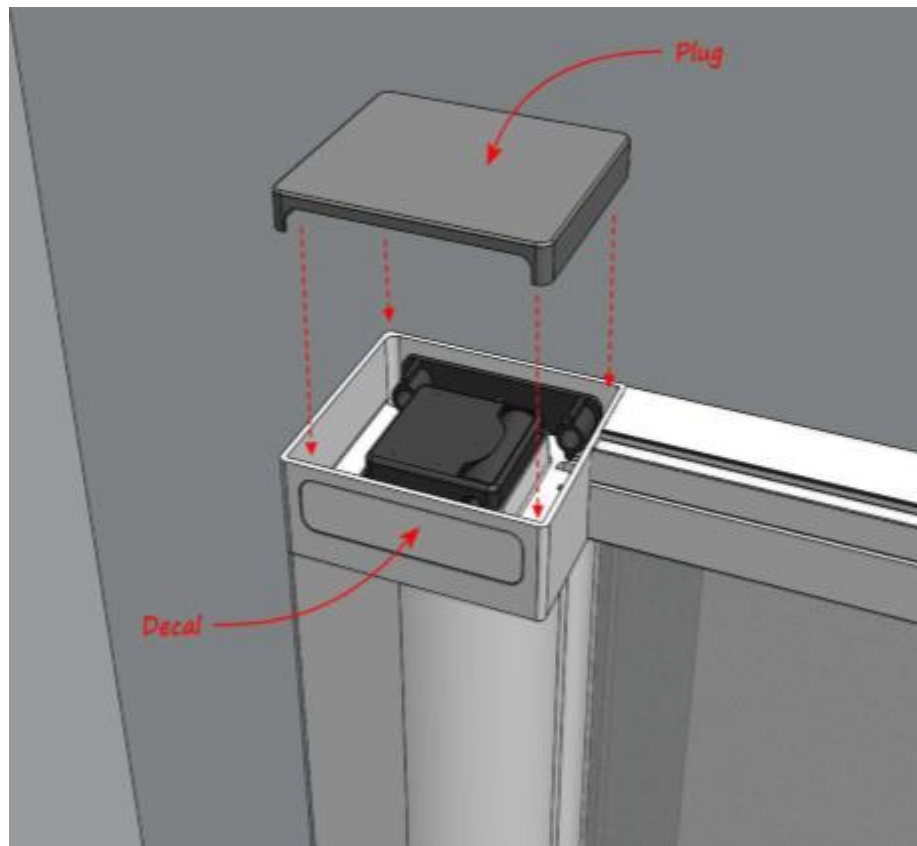

## Reference

Installation Videos, Parts Lists and CAD files at : [www.wizardscreens.com/technical](http://www.wizardscreens.com/technical)  
or click on the links below

### Horizon

[Installation Video](#) YOUTUBE

[Reverse Installation Video](#) YOUTUBE

[Single Horizon Screen](#) .pdf

[Double Horizon Screen](#) .pdf

[Corner Horizon Screens](#) .pdf

[Horizon Components](#) .pdf

[Horizon Double and Corner Components](#) .pdf

[Horizon Door and Components DXF](#) .dxf

[Horizon Double and Corner Units DWG](#) .dwg

[Horizon Parts List](#) .pdf

## Optional Install

Top track can be turned 180° to allow fastening from the front or back

