



# **3-Sided Frame**

## **100mm Double Screen Installation**

Minimum **2** installers required

**!** Call 604-299-4426, or email [support@wizardcreens.com](mailto:support@wizardcreens.com) prior to starting if you have any questions

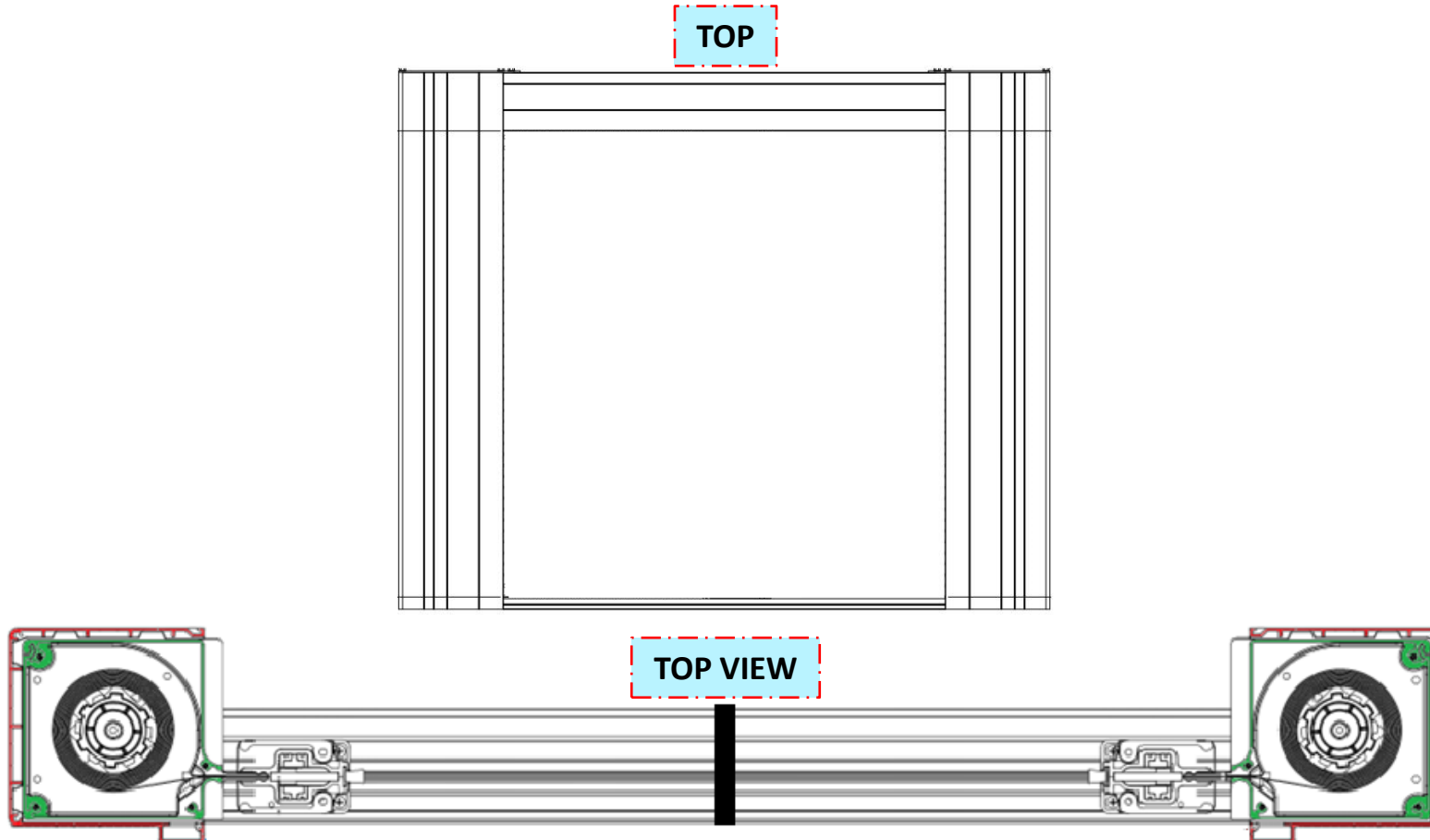

Spray track  
runners *only* with  
dry silicone.

## REQUIRED

Level



Tape Measure

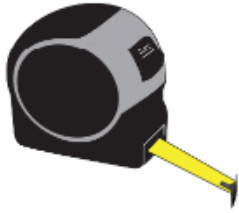

Pencil



Shims



9/64 and 1/8  
Drill Bits



#1 and #2  
Robertson  
Driver Bits



Dry Silicone  
Spray



2-way Laser Level



Chop Saw

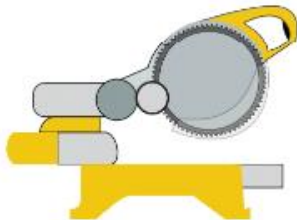

Drill



Step Ladder



Vacuum



## OPTIONAL

Laser Distance Measure



**FIRST**  
Confirm the frame is  
**plumb, level, straight,  
and square.**

Carefully remove temporary  
jamb fillers.



1. Put housings in place.



2. Release brakes using supplied **RED** wedges.

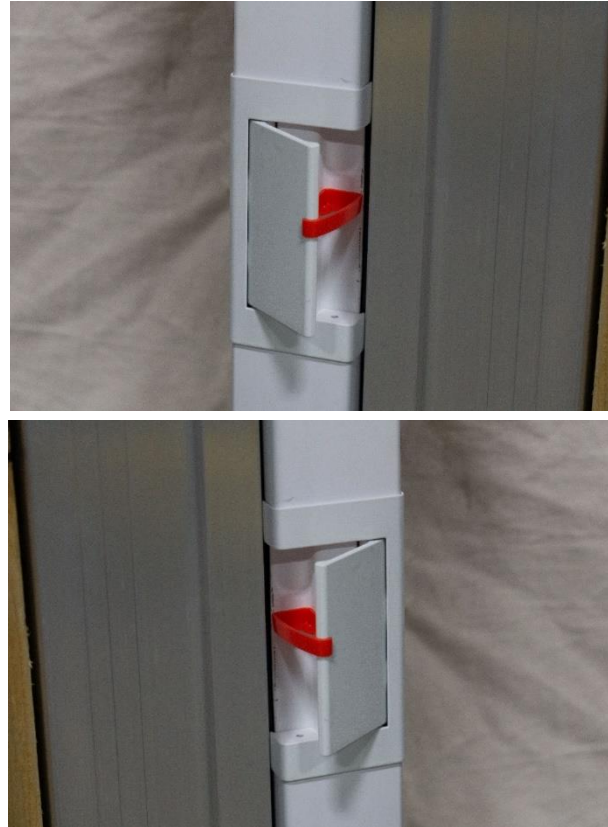

3. At the top *and* bottom, measure across between **housing endcap** and **housing endcap**. Record top and bottom measurements.

**\*Jambs must be plumb and parallel, therefore measurements should be identical. No more than 1/8" difference.**



## Cutting both headers

1. For each insert, determine **half** of recorded **top** measurement and **subtract** another **1/8"**.
2. Mark and cut header inserts.



## 3. Attach header inserts.

\* Ensure **track channel** is on the correct side where screen will run!



## Lower tracks:

1. Measure at **bottom** between **housing endcaps** and **desired joint location**. Record.
2. Flush lower track components at one end and cut to recorded **bottom** measurement.
3. *Subtract* another **5/16"** (*half* of lower track joiner thickness) from *only* each lower track (track mount *not* included) and cut.
4. Cut track runners to fit between the **lower endcap spigot** and the **track joiner connector**.

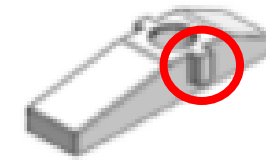

## Upper tracks:

1. Measure at **top** between **housing endcap** and **desired joint location**, then *subtract* [**insert measurement**] (*half* of upper track joiner thickness). Record.
2. Flush upper track components at one end and cut upper tracks to recorded **top** calculation.
3. Cut track runner to fit between the **upper endcap** and the **track joiner latch**.



**\*DO NOT CUT TRACKS NOR TRACK RUNNERS TOO SHORT\***

## Prepare track runner **entry ends**

*Slightly counter-sink.*



*Barely trim the corners off.*



Deburr and clear debris.

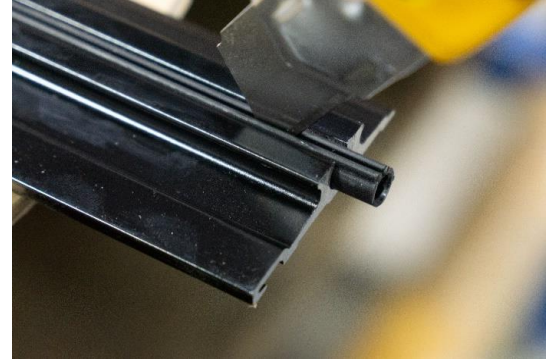

Pull it out approx. 8"





1. Lay down lower track mount.
2. Insert supplied track cut-off through the pull-bar. Push track fully against housing so that it encompasses spigot. Housing and track mount *must* be square to each other – **no gaps**.
3. Drill and countersink the lower track mount as shown below and fasten with #6 stainless steel FH screws.
4. Drill remaining holes every 18" in pairs and fasten. Shim where necessary. **Housing and lower track mount must maintain alignment.**

**Tip!** - use the lower track mount as a drill guide to mark the hole locations on floor surface for pre-drilling if required (ie. Tile or concrete floor that requires screw plugs).

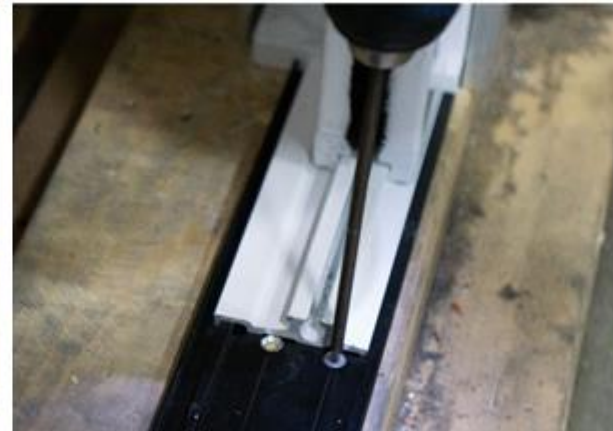
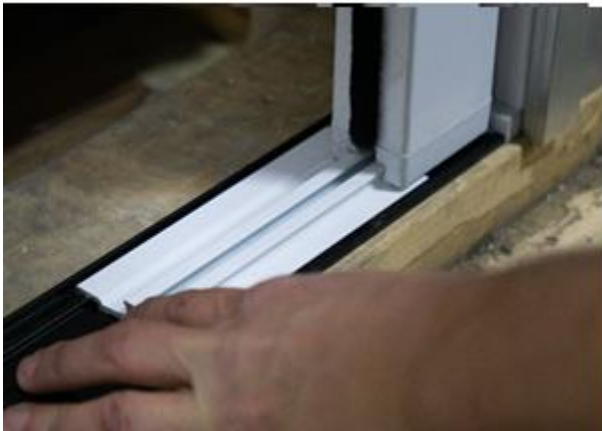

1. Remove track cut-off.



2. Lift pullbar. Slide track runner along zipper.



3. Feed lower track through pullbar.



4. Push fully against housing – **no gaps**.



5. Interlock track and insert spline into groove.



6. Attach lower track joiner



1. Insert upper tracks into the header insert track channel and release them. Tracks will initially overlap.



2. Feed track runner along zipper, then track through pullbar endcap, pushing fully against housing – **no gaps**. Repeat on other side.





3. Ensure track floats freely and that bottom of track is even with bottom of header insert.



4. Affix track joiner.



**!IMPORTANT:** It *may* be necessary to cut the *top* of the upper track joiner **shorter**. Test functionality first.

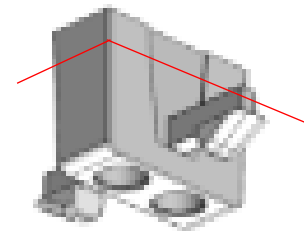



## Test the unit.



Check the following:	✓ or ✗
Frame is Plumb, Level, Square, and not twisted?	
Housing on the ground AND plumb?	
Housing mesh slot has not been squeezed during the install?	
Tracks are fully against the housing?	
The track limiters are on the entry end of the upper track?	
Tracks are fully against the housing?	
Track runners are not cut too short?	
Zippers are following through the housing endcap keyholes?	
Track runners have been sprayed inside with <b>dry silicone</b> ?	

If necessary, review **The Horizon Troubleshoot Manual**