

Minimum **2** installers required

1. Screens are tested prior to packaging.
2. Store screens in original packaging until installation.
3. Inspect all products and components prior to installation.
4. **Photograph and Report** damaged or missing parts immediately to orders@wizardscreens.com
5. **Do NOT draw out screen until tracks are installed.**
6. If affixing screen system directly onto door frame and threshold, ensure fastening will NOT negatively impact the performance of the door and hardware. Consult door manufacturer.

If you have questions, refer to the **troubleshoot manual** and **maintenance & service guide** first. If necessary, contact support **while on-site:** support@wizardscreens.com
604-299-8878

CLICK



Spray
tracks *only*
with dry
silicone.

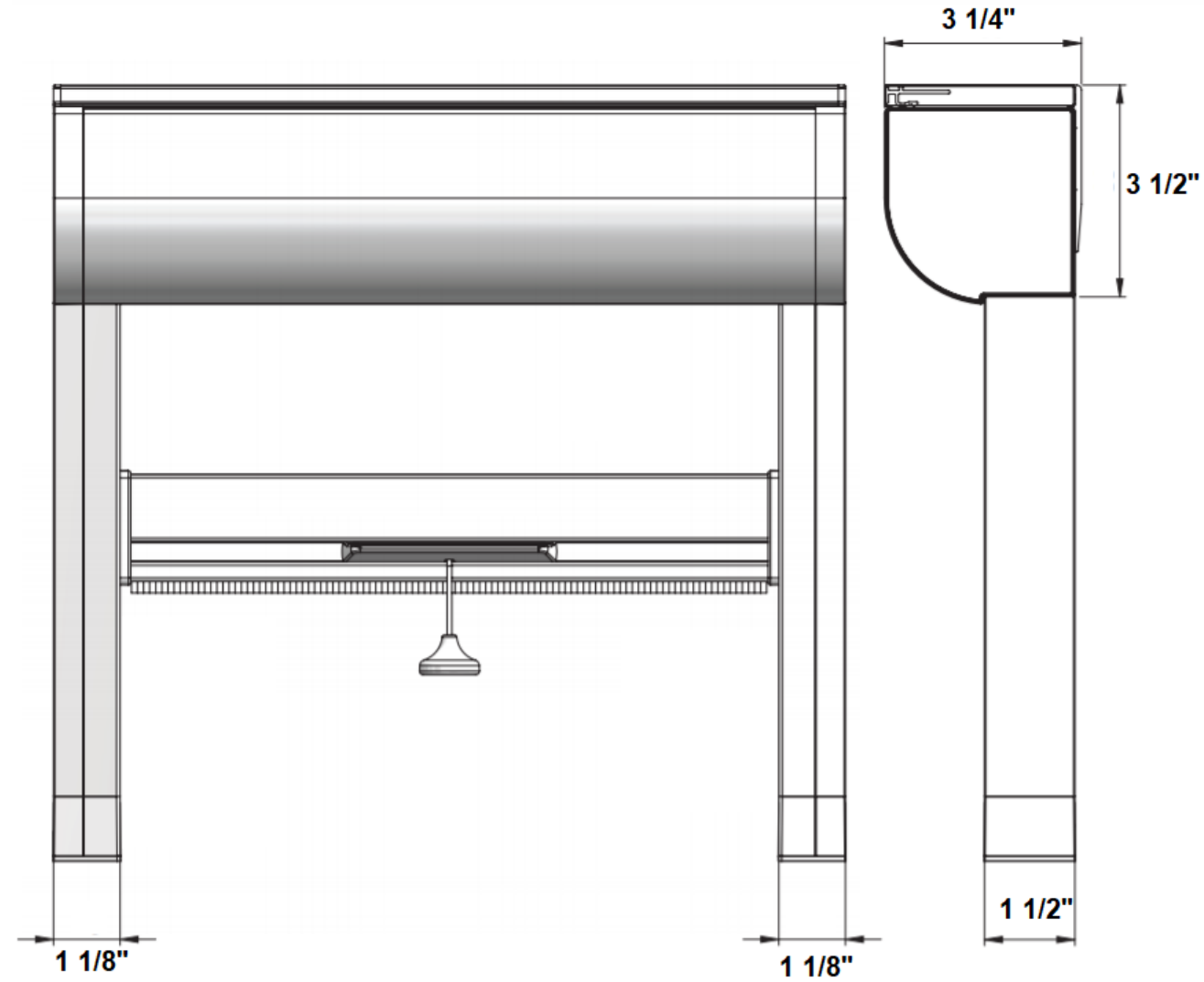
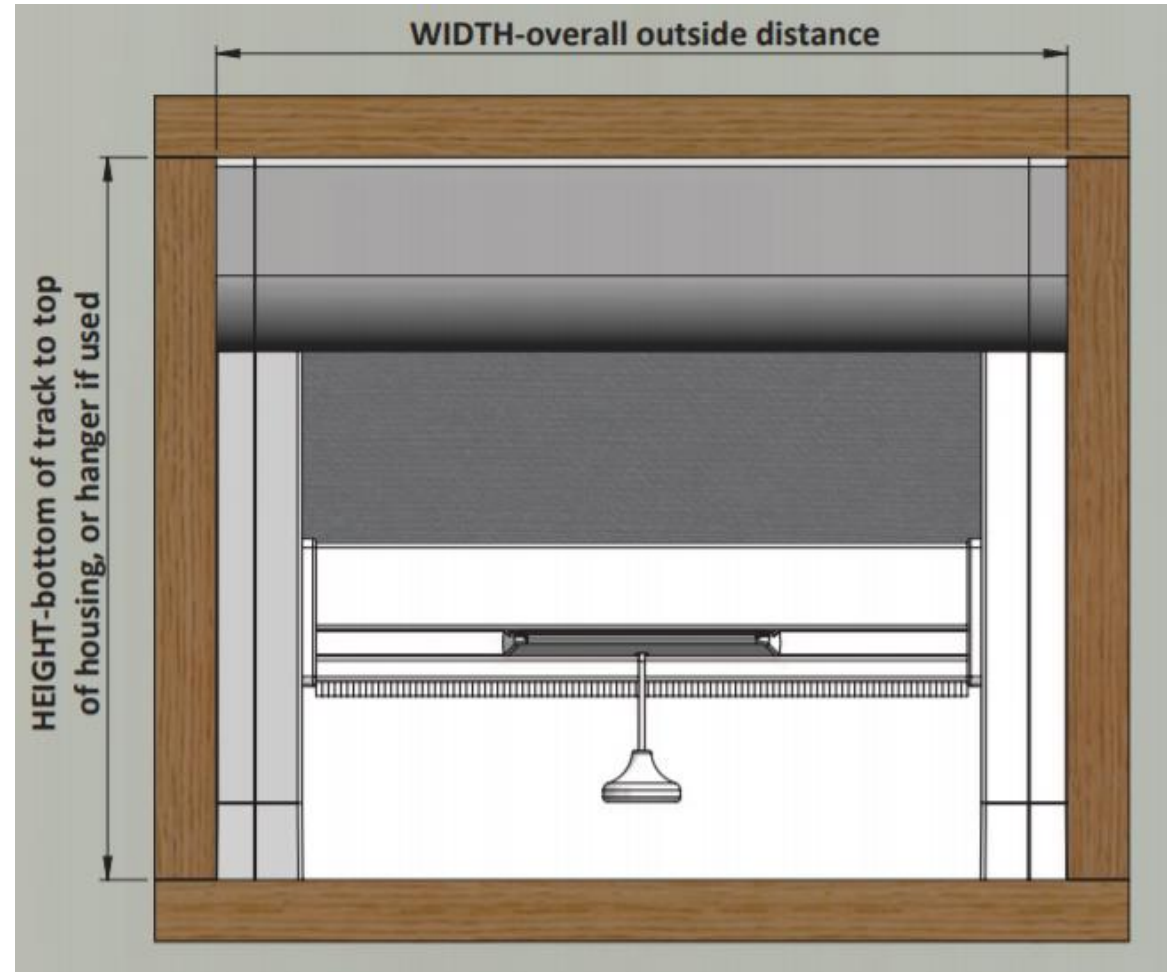

Track drilling procedure for FACE FIT

Drill "Fixed Track" as shown

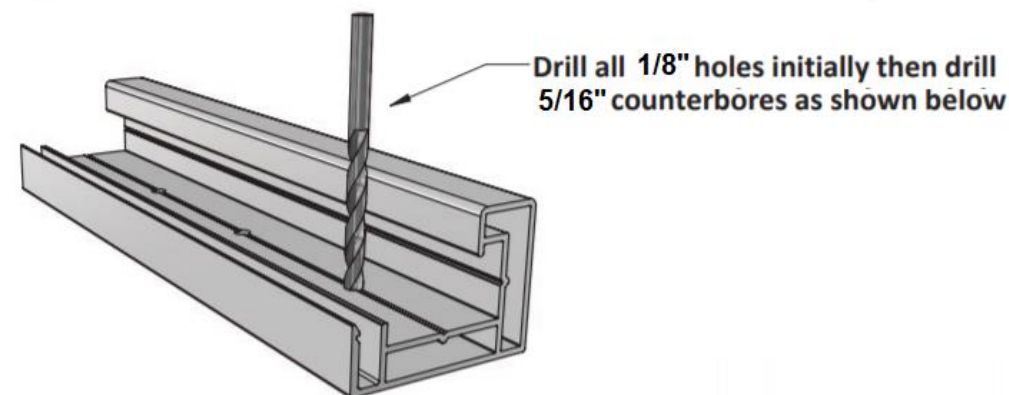
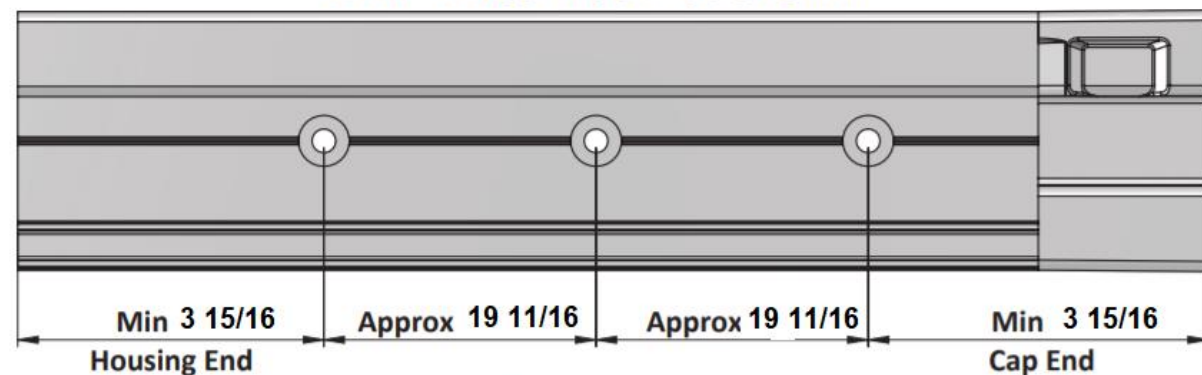

**1/8"
DRILL**

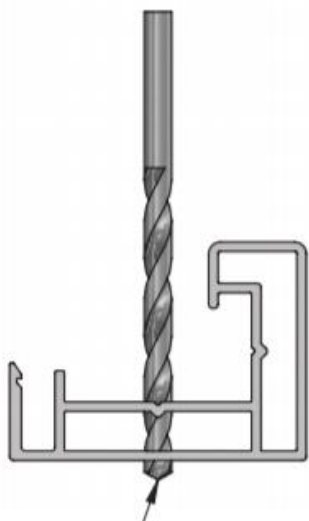

Be sure to drill through both walls of the track

**5/16"
DRILL**



Be careful not to damage the track

Be sure to drill through only the inner wall of the track

Drill "Housing Hanger" (for 80 screens only)

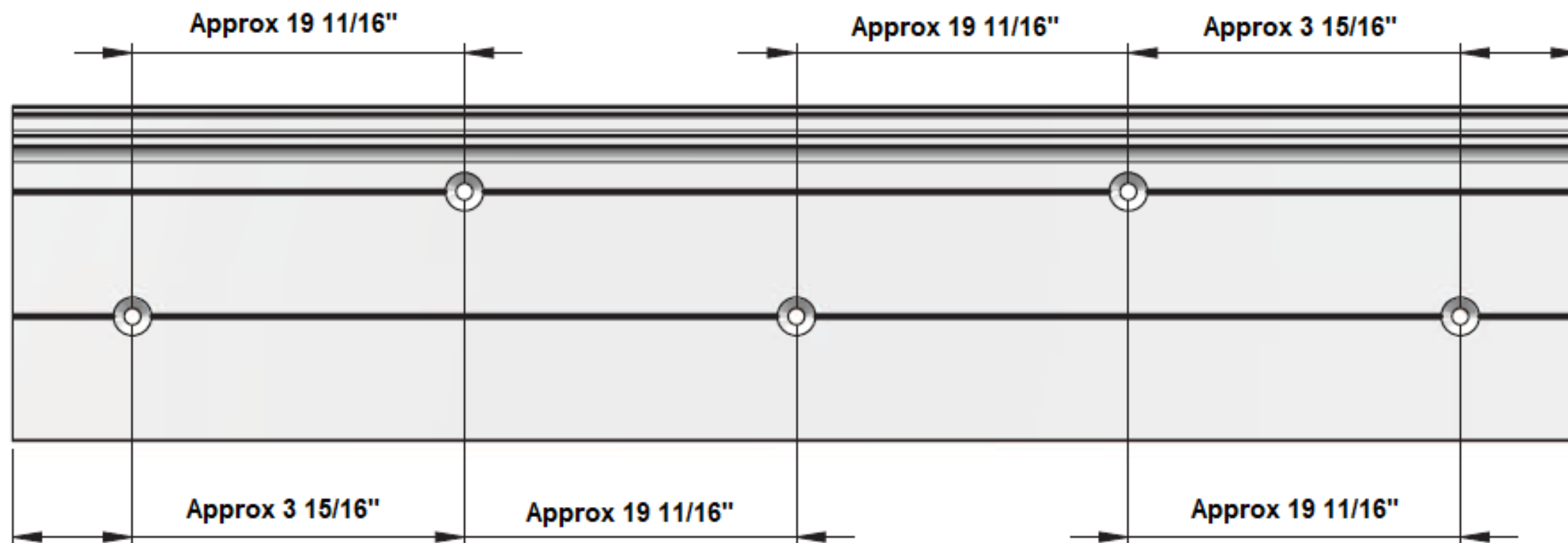

Drill "Housing Hanger" (for 80 screens only)

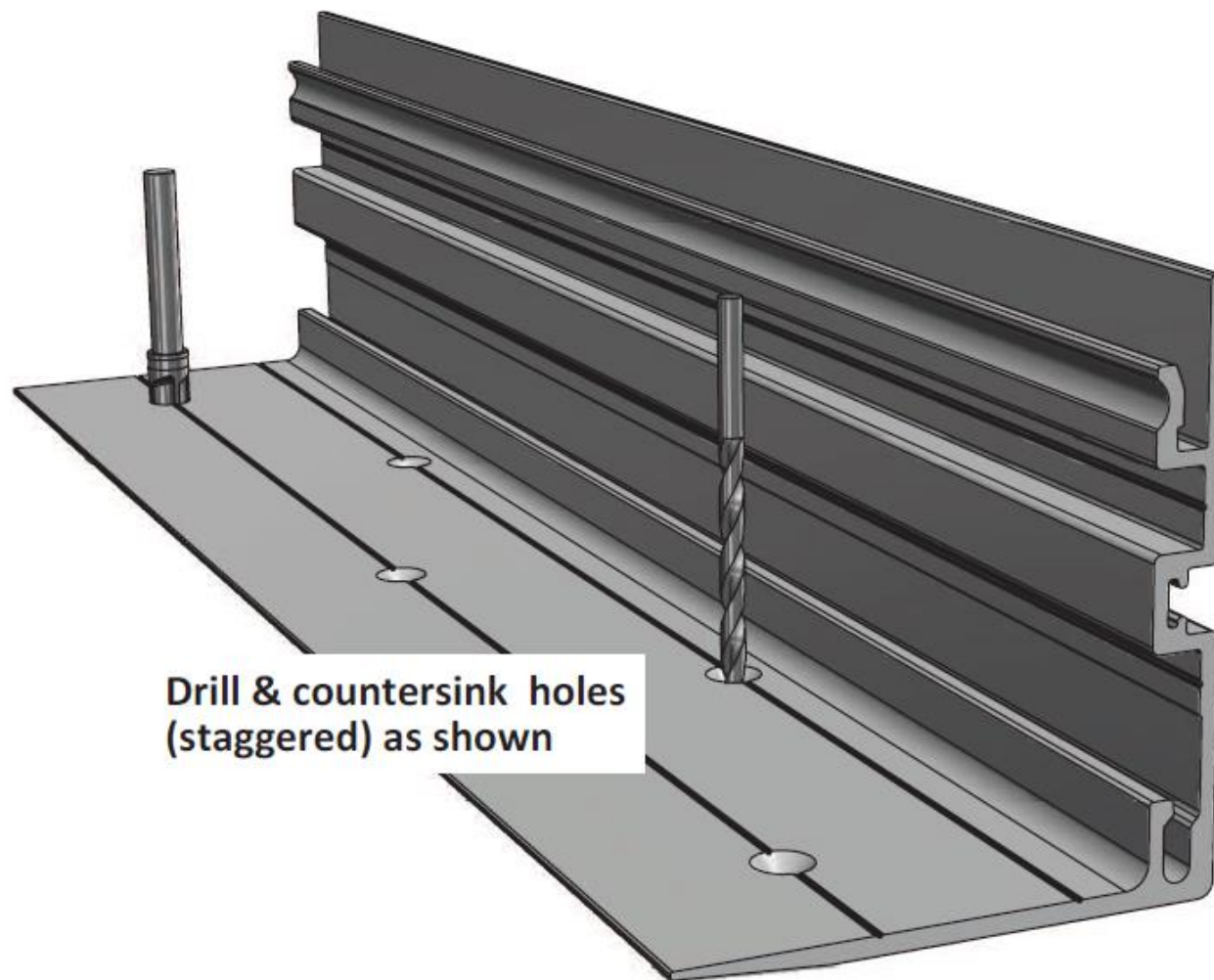
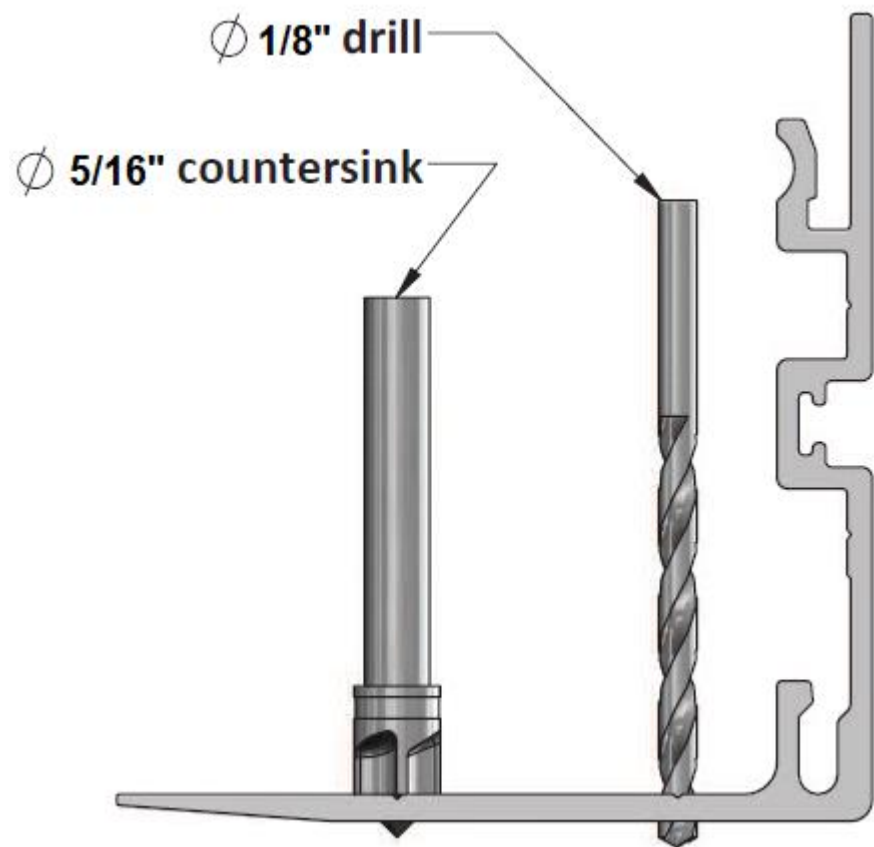

Mount "Housing Hanger"

Use packers if needed to ensure housing hanger is mounted both level & flat across it's entire length

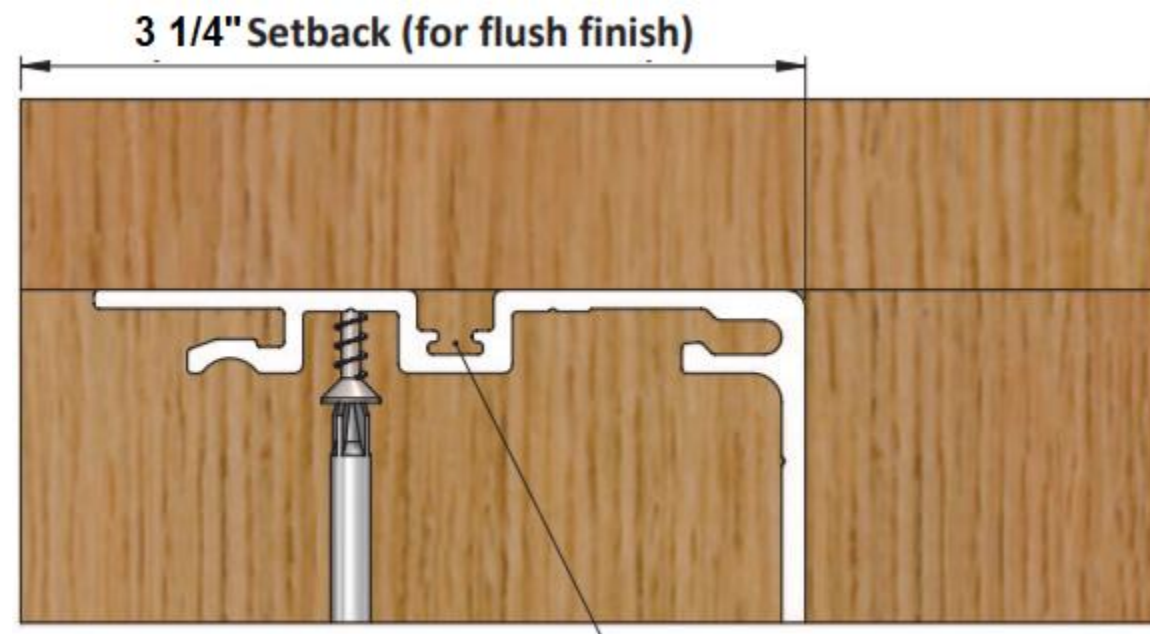

Use appropriate fluff in this channel if gap is present due to packers being used (not shown)

Mount "Housing"

Lift & support the housing locating the prongs into hanger opening. Ensure it remains firmly against the underside on the hanger, then starting at one end push the housing toward the wall, working your way along the entire length to engage the securing clip.

Ensure this clip is engaged before fitting the "housing lock"

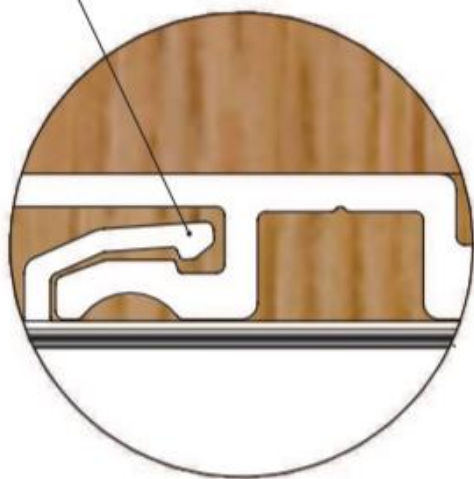

Slide "housing lock" into hanger & press firmly until it clips into place

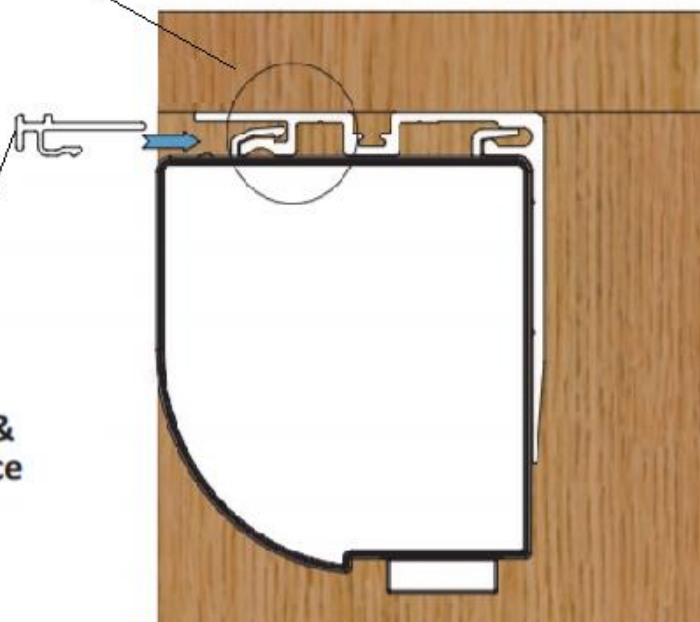
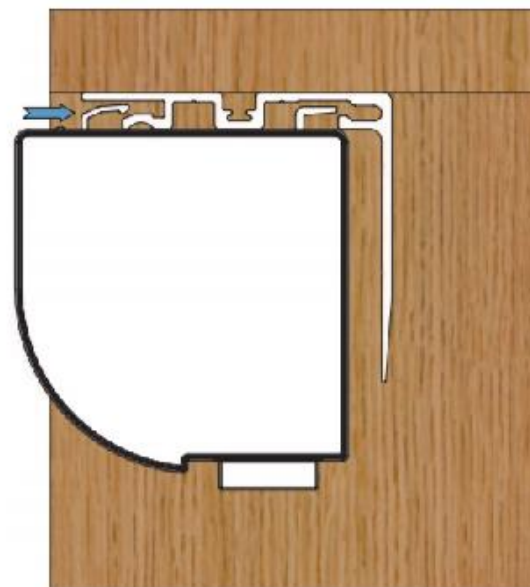

Mount "Fixed Tracks"

Tilt & flex the tracks into place ensuring they correctly engage the tabs located on the housing end caps

Once positioned screw in place as per 2 3/8" procedure shown on the following page

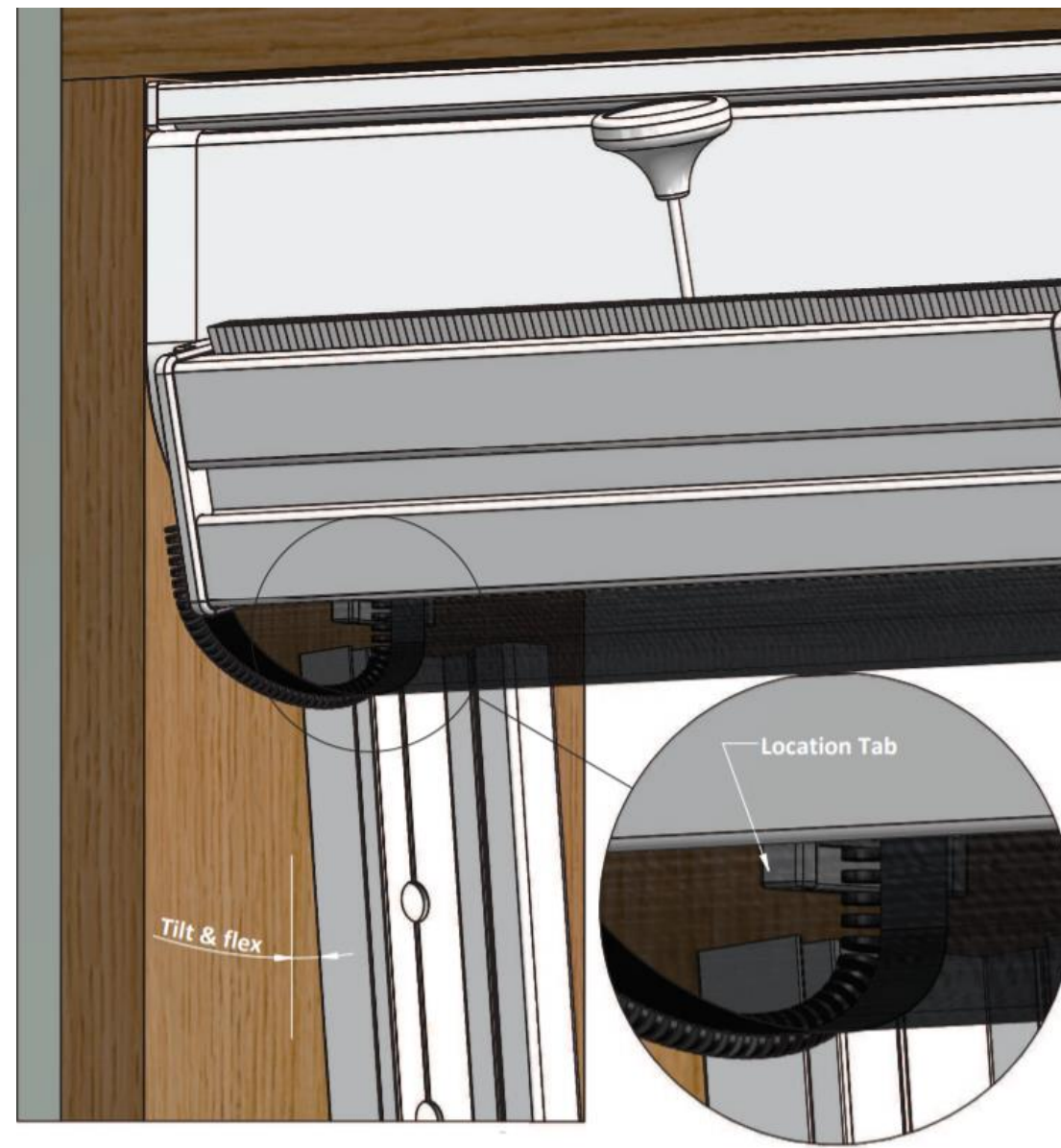

Feed mesh edge into "Zip Track"

Pull the "Drawbar" down 2" or more to make it easier to feed the zipper into the tracks. Repeat for both sides

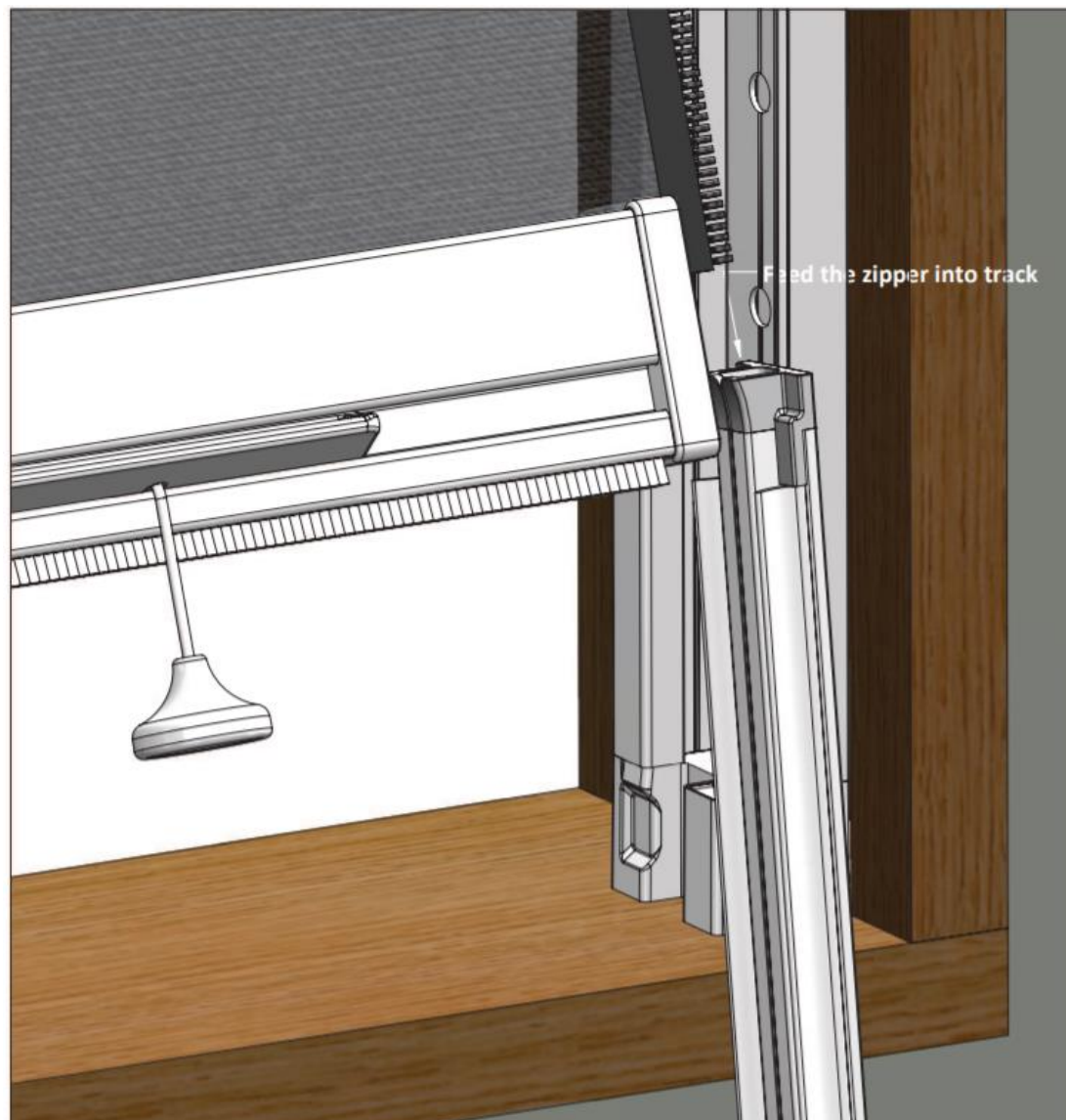

Complete the "Track" assembly for one side only

Ensure the "Drawbar" is correctly located within the track as shown

1- Rotate Zipper Track into position

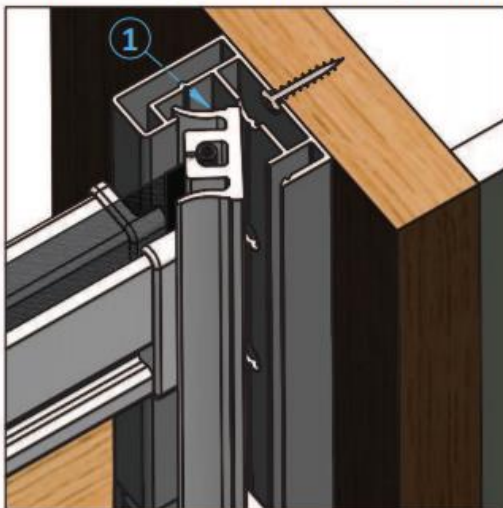

2- Ensure the flexible wing is fully seated

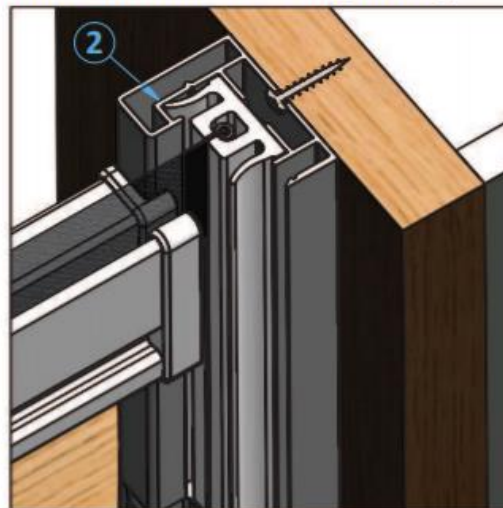

3- Align the "inner track" as shown

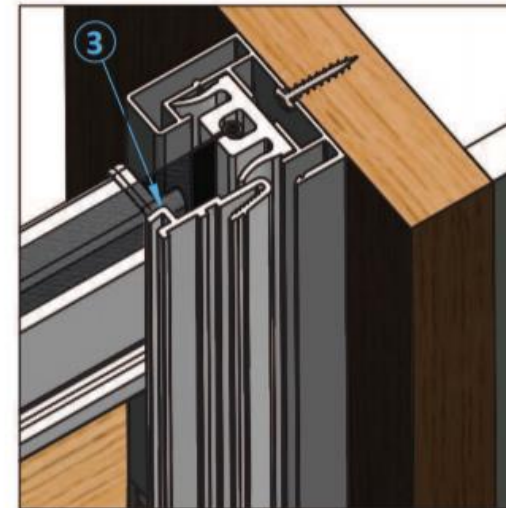

4- Press firmly ensuring it clicks into place

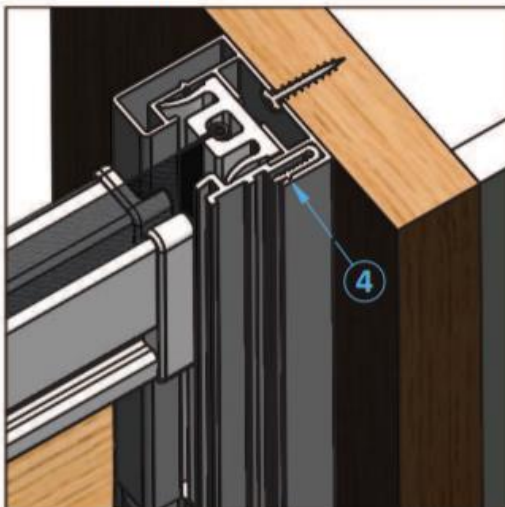

5- Align the "track retainer" as shown

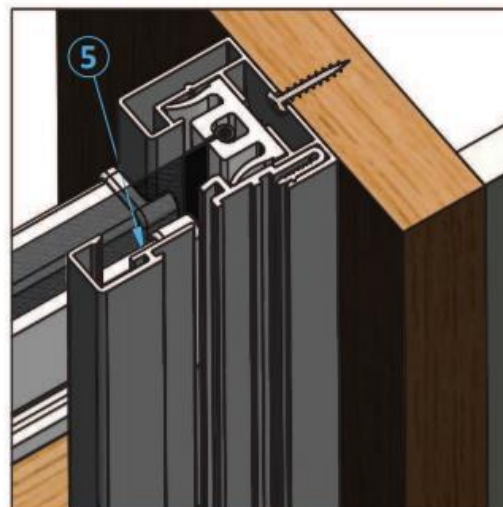

6- Press firmly or soft mallet until seated

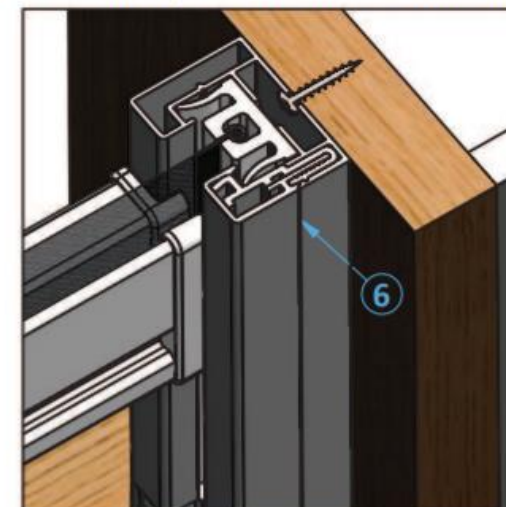

Mount "Sill" (where required)

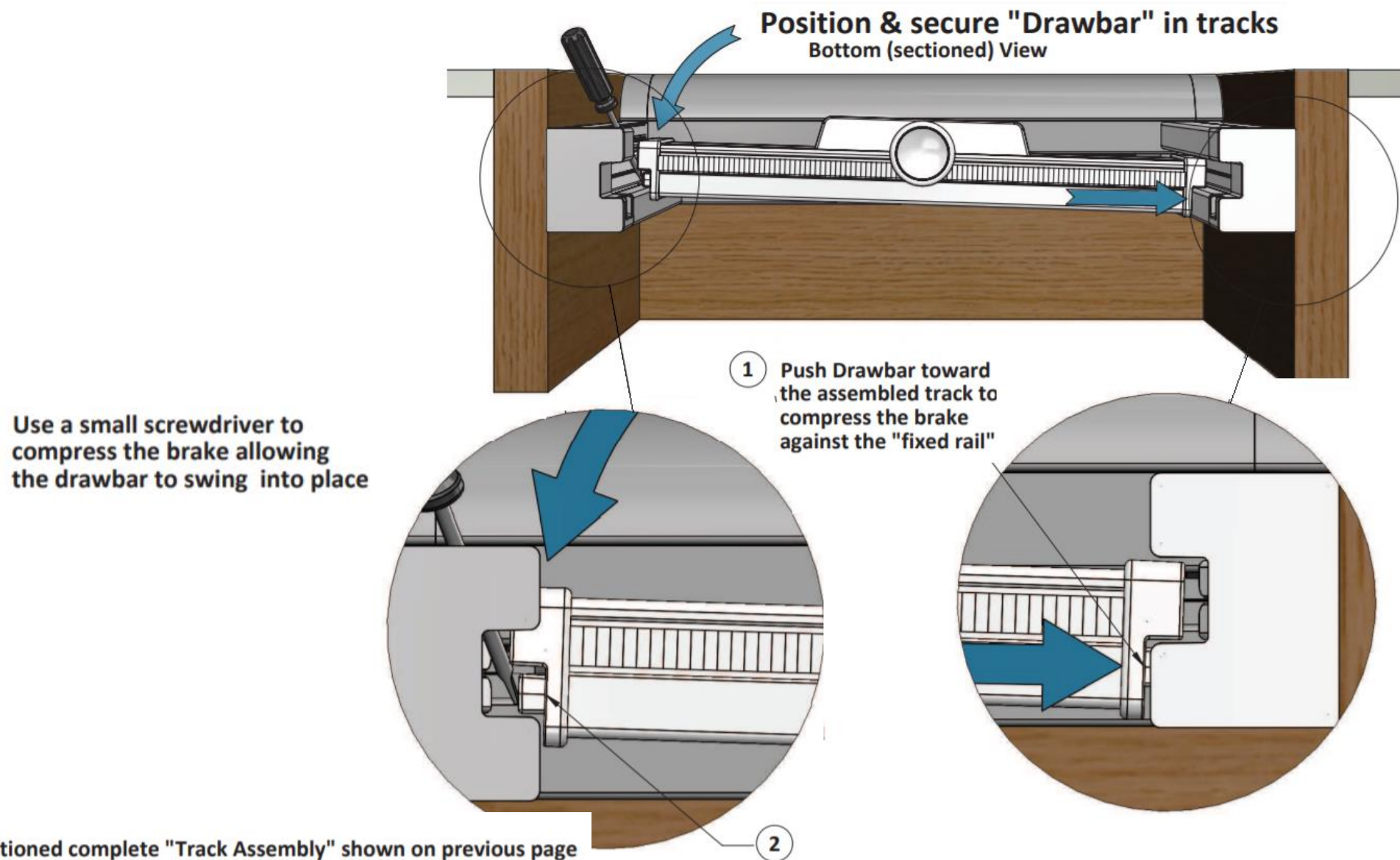

Check the blind operation

With the screen now assembled, spray a small amount of silicone spray into the zipper tracks. Be careful not to spray the outer tracks or braking surface.

Run the drawbar up & down to check the blind operates smoothly & locks into the "track caps" correctly. For windy areas, or areas with uneven ground the "drawbar locks" can be fitted. Refer fitting instructions herein.



Step-1-
Push lock into drawbar groove
until it snaps into place

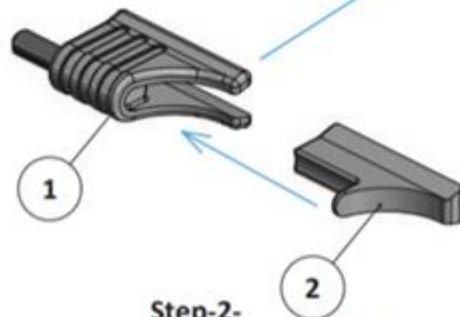

Step-2-
Slide key into lock groove
to secure it in drawbar

Step-3-
Mark location of lock-pin & drill hole
through track. Multiple holes can be
drilled at desired locations along the
track as needed

