



Integrated System

Order Measurements



Frames can be:

A) 3-sided – 2 Jambs, Header, Header Insert

B) 4-sided – 2 Jambs, Header, Header Insert, Sill

After determining Integrated Frame dimensions, the architect and builder *must* add minimum $\frac{1}{4}$ " shim space per side (3 or 4-sided frame) to the **Rough Opening W x H.**

Frame *must* be installed **plumb, level, straight, parallel, square, and free of twist.**



1. Illustrations are not to scale.
For dwgs: <https://www.wizardscreens.com/technical/>
2. When selecting “Frame and Screen” or “Frame”:
Entering **FRAME OUTSIDE DIMENSIONS** will output the following dimensions in 1/16^{ths}:
 - **FRAME DAYLIGHT OPENING DIMENSIONS**
 - **SCREEN UNIT DIMENSIONS** (height not shown in illustrations)
3. When selecting “Screen”:
Enter **FRAME DAYLIGHT OPENING DIMENSIONS** in the following way:
 - a) **WIDTH** = round **UP** to the nearest **INCH**
 - b) **HEIGHT** of “**FRAME DAYLIGHT OPENING**”

The Horizon Integrated System will only be warrantied
and supported for interior applications - **NOT** exterior!

Orientation of **screen** and **frame** in relation to the door.

BIRD'S EYE VIEW

INTERIOR

EXTERIOR

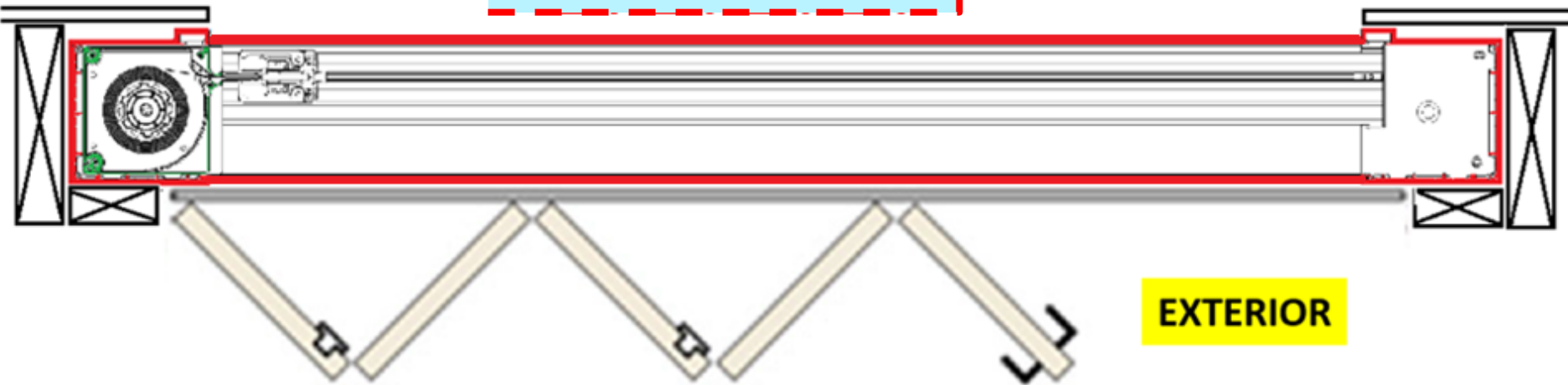

**“Top of Frame”
includes the
screw heads**

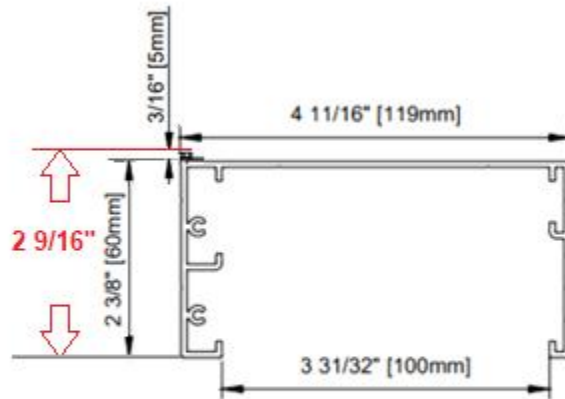

CONCEALED HEADER

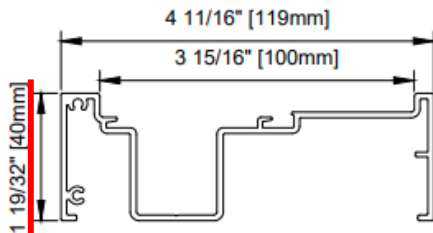
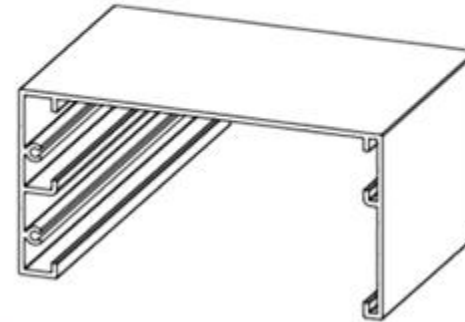

CONCEALED SILL RAISED

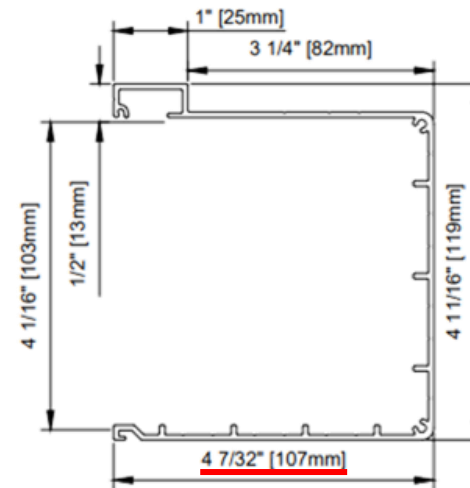
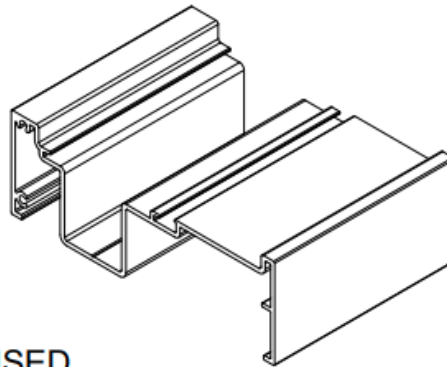

CONCEALED JAMB

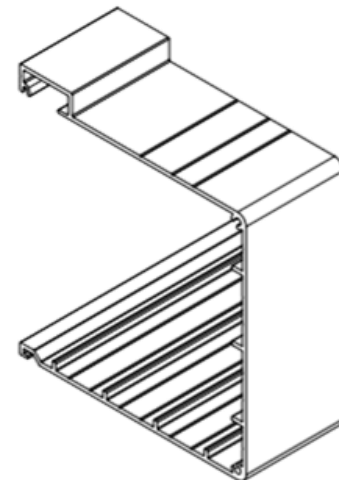

**BIRD'S EYE
VIEW**

3-SIDED FRAME Position "A"

ELEVATION VIEW

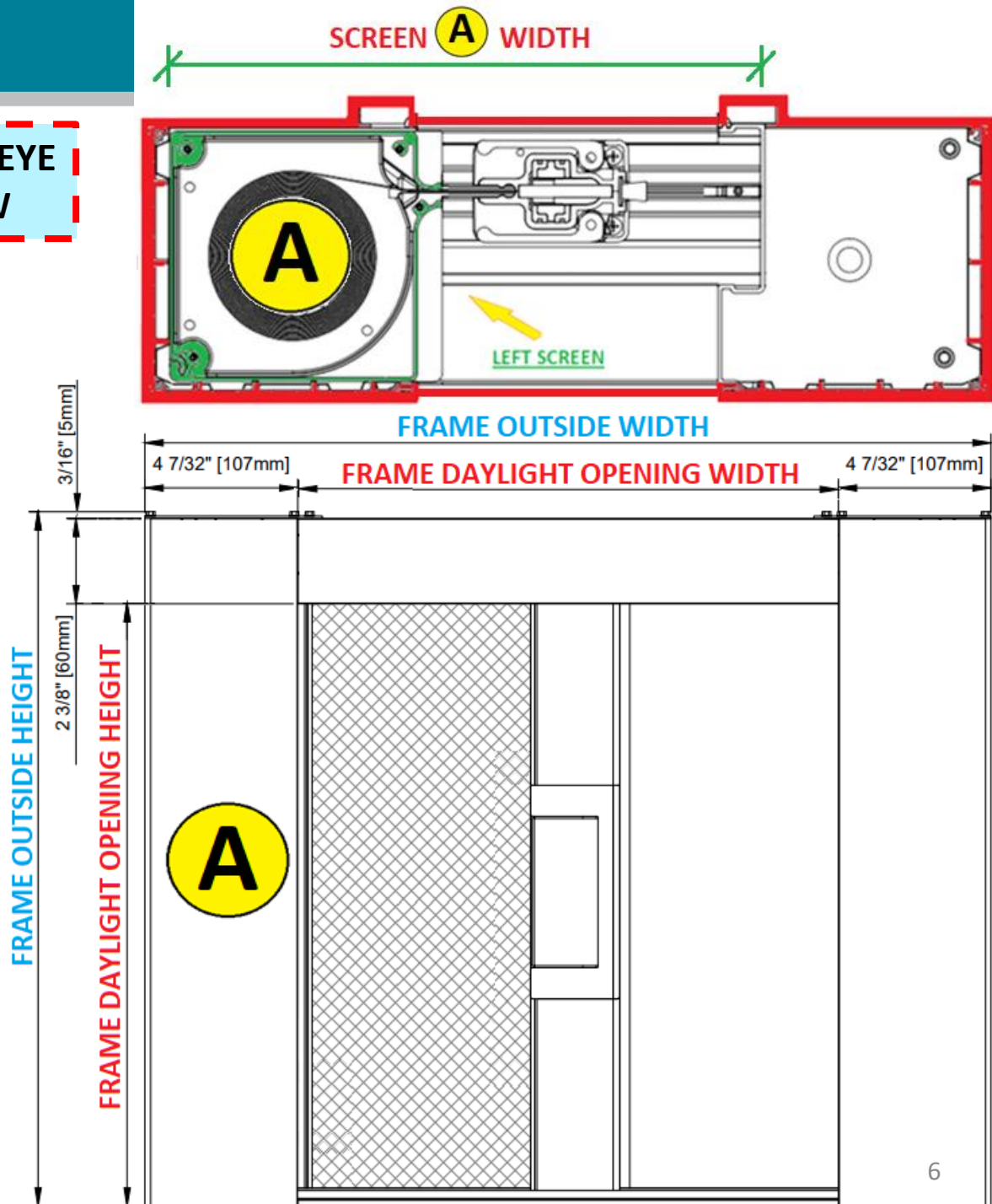

**BIRD'S EYE
VIEW**

3-SIDED FRAME Position "B"

ELEVATION VIEW

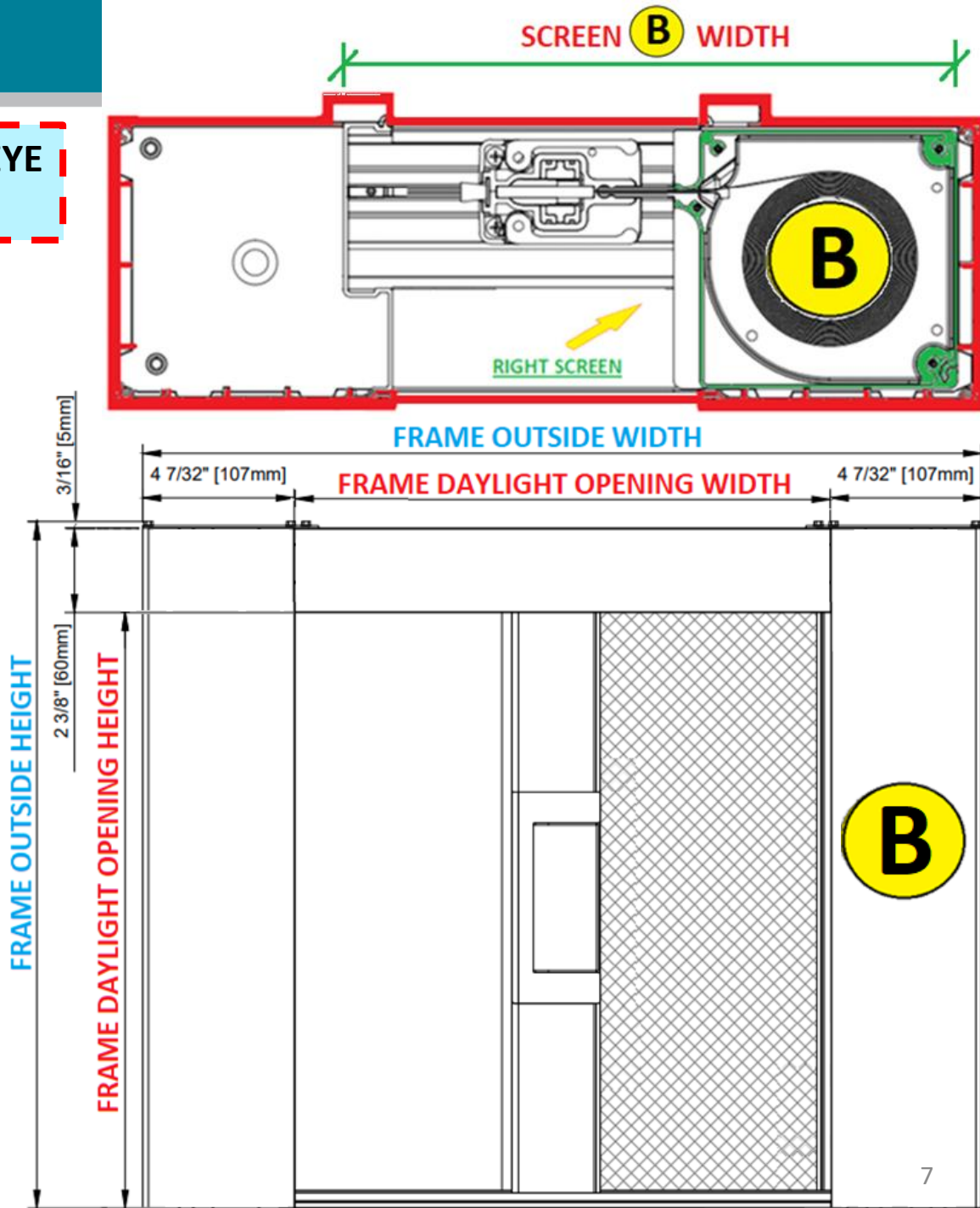

***Pullbars meet
in the *middle****

ELEVATION VIEW



**BIRD'S EYE
VIEW**

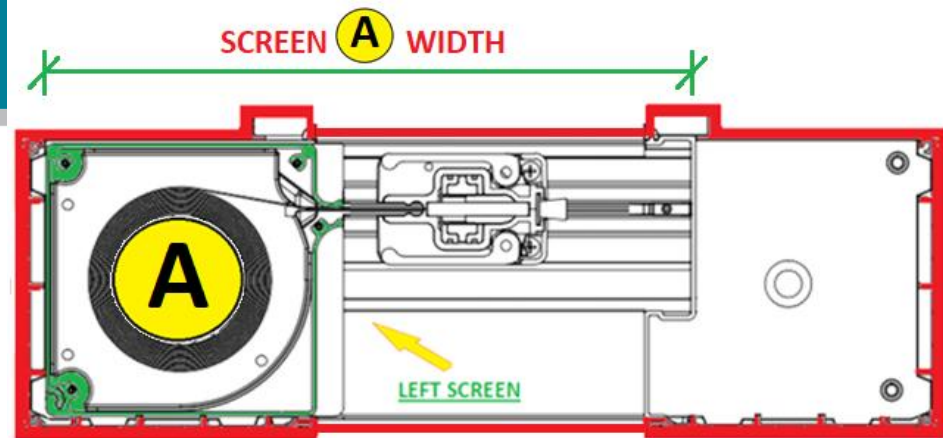

4-SIDED FRAME Position "A"

ELEVATION VIEW

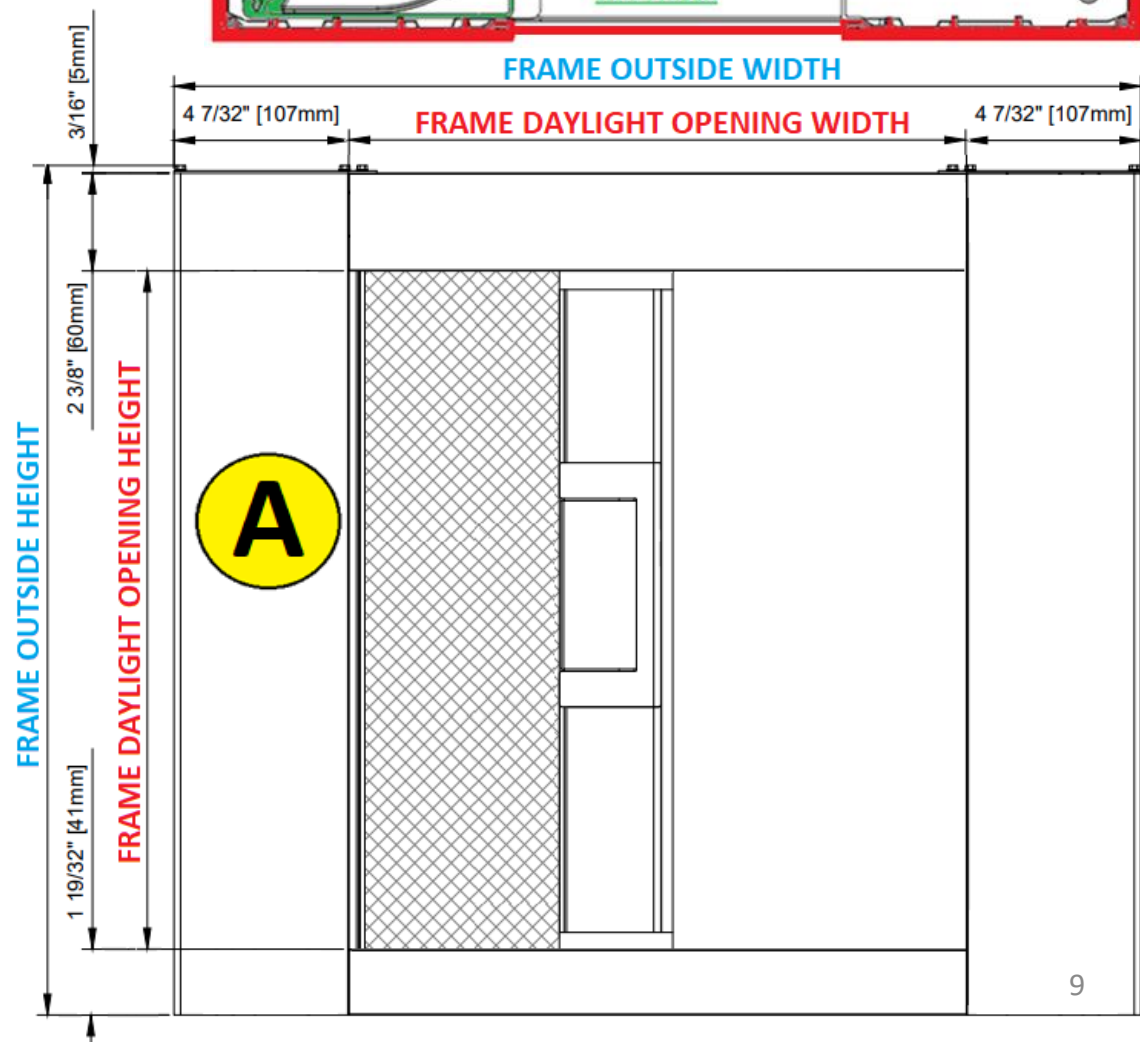

**BIRD'S EYE
VIEW**

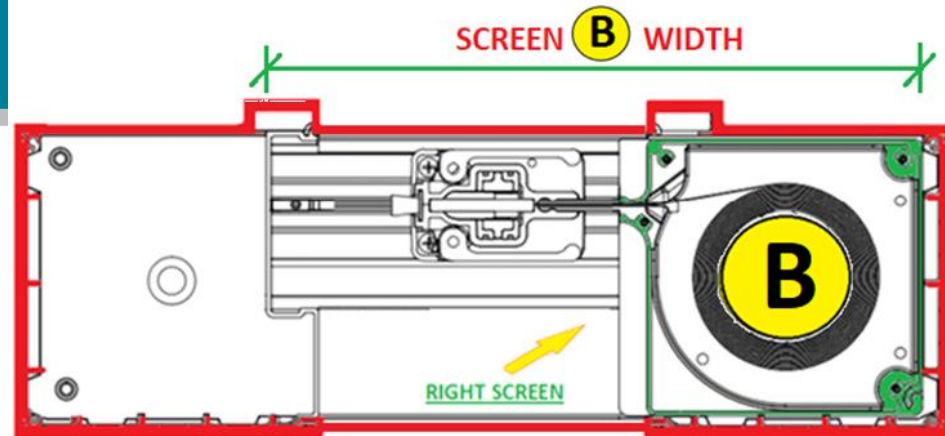

4-SIDED FRAME Position "B"

ELEVATION VIEW

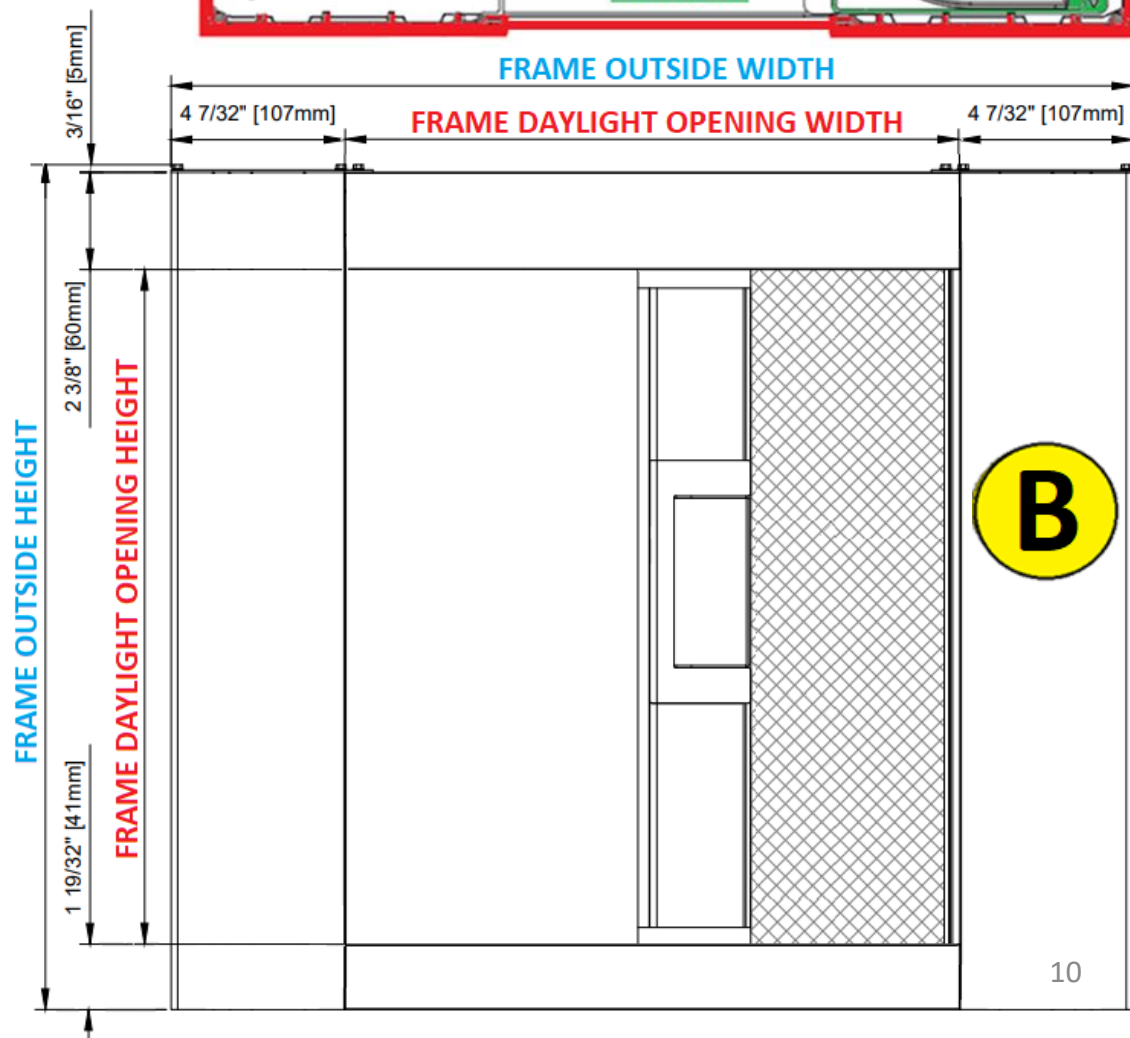

**BIRD'S EYE
VIEW**

4-SIDED FRAME Position **"DOUBLE"**

***Pullbars meet
in the *middle****

ELEVATION VIEW

