

VistaView™ Plus

Reveal-Fit Installation Guide



Product tech. support:

support@wizardscreens.com 1-888-949-3667

First things

- **READ INSTRUCTIONS BEFORE PROCEEDING.**
- If there is a glazed door, it must be in place *before* screen installation.
- If concealed, screen unit must be **removable & serviceable**.

Unpackaging

- Unit and parts may be inspected at shop, but should be packaged when transiting to site.
- Closely inspect product for damage.
- **If there is damage, report to Wizard Screens with pictures *immediately*.**

Preparation

- Ensure zippers are in housing endcap slots. **Figure 1**
- Leave track supports **ON** *until* attaching tracks. **Figure 2**
 1. Replace lower support with lower track. Affix track.
 2. THEN, replace upper support with upper track. Affix track
- Brakes must be *disengaged* when operating. Do *not* remove handle lock until installation complete. **Figure 3**
- **Do NOT draw screen out on bench.**

Figure 1



Figure 2



Figure 3



#8 Robertson
Screwdriver



9/64 and 1/8
Drill Bits



#1 and #2
Robertson Driver
Bits



Dry Silicone
Spray



Small
Countersink Bit



Utility Knife



Chop Saw

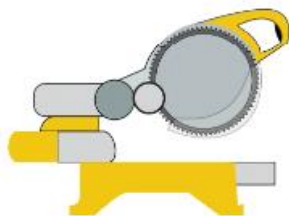

Drill



Step Ladder



Vacuum



Rubber Mallet



Level



Tape Measure

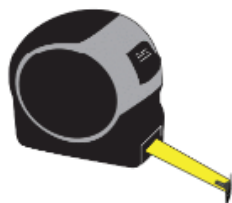

Pencil



Shims



OPTIONAL
2-way Laser Level Kit



STEP-1

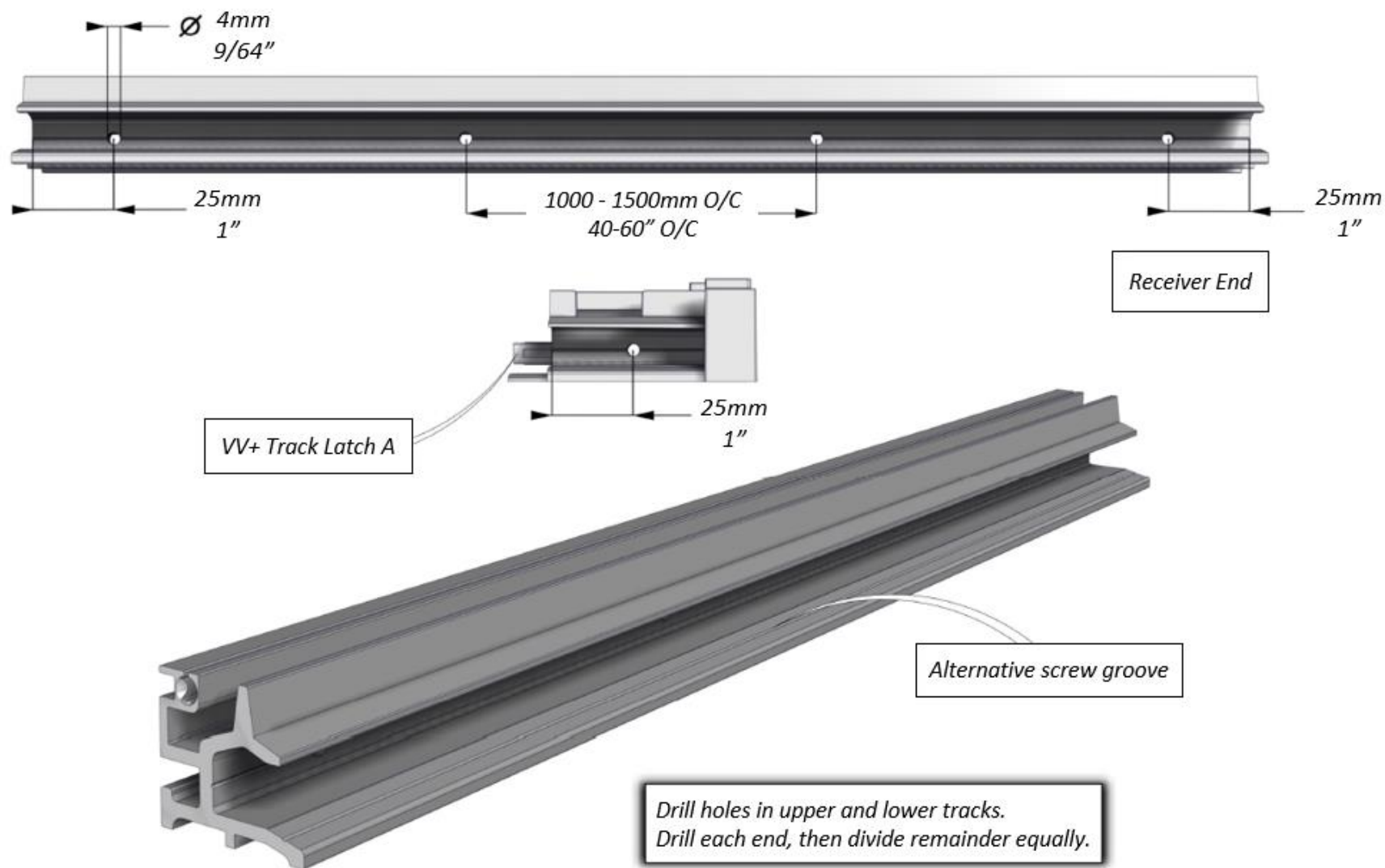

STEP-2

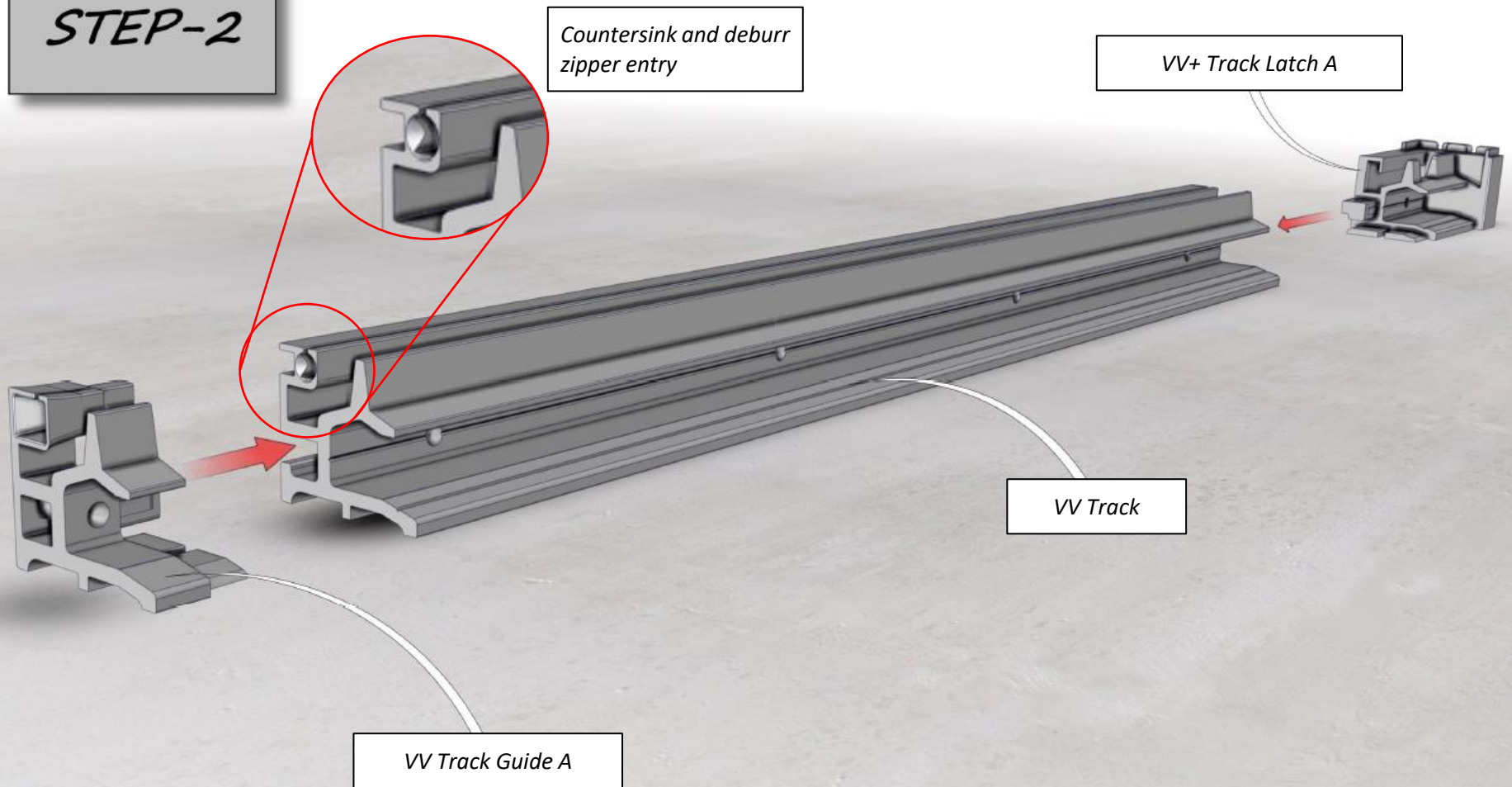

Attach **track guides** and **track latches** onto the **track** using a soft mallet

NEW

April 1

2025

VistaView™ Track Splicer

**| This page is applicable only if you |
| opted for tracks to be spliced. |**



***NOTE:** The **upper & lower tracks** will arrive cut *in-half* with extra. If you wish for the **track splicer** to be *centered*, you will need to follow **steps 1 & 2**.



1. For upper & lower **track pieces 1**, measure identical length & mark.

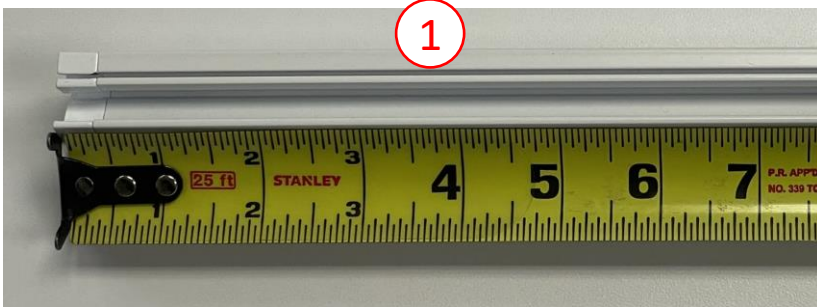

2. Cut lower & upper **track pieces 1**.

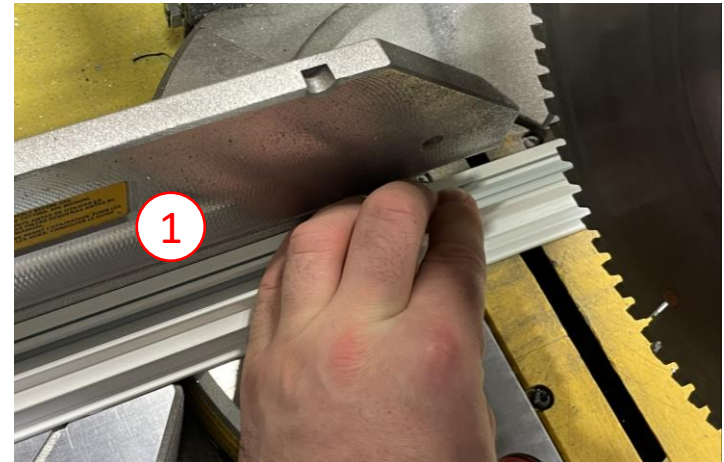



VistaView™ Track Splicer

**| This page is applicable only if you
| opted for tracks to be spliced. |**

3. Mallet track splicers onto track pieces 1.

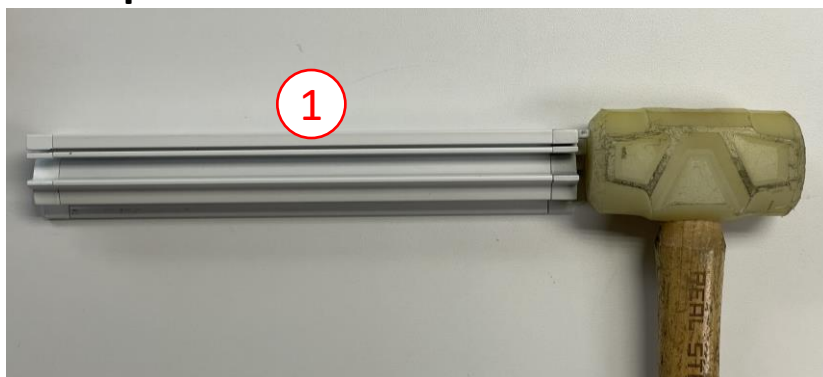

4. Connect track pieces 2.

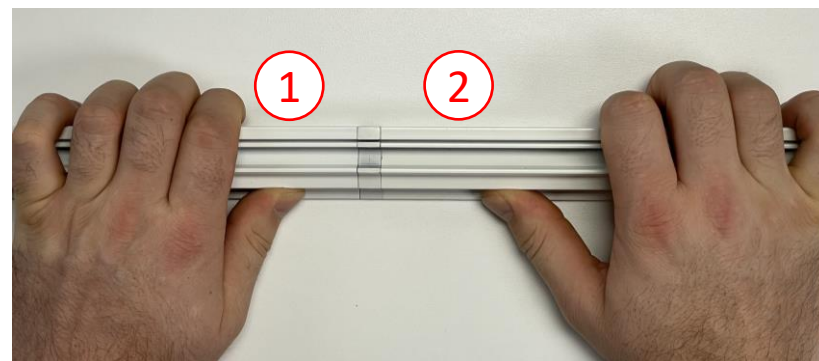

5. Measure connected track to desired length and mark.

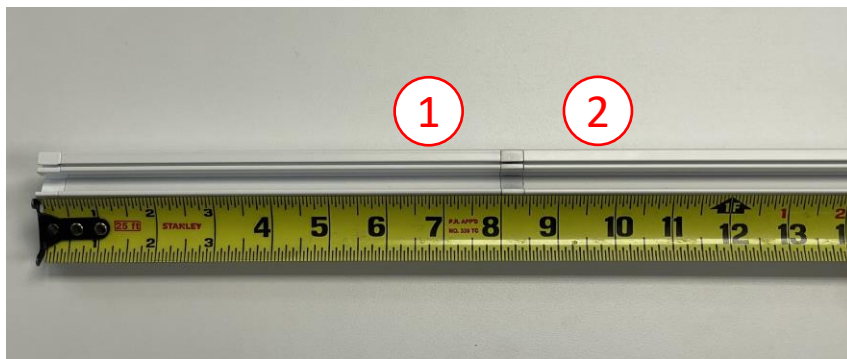

6. Cut connected track.



STEP-3

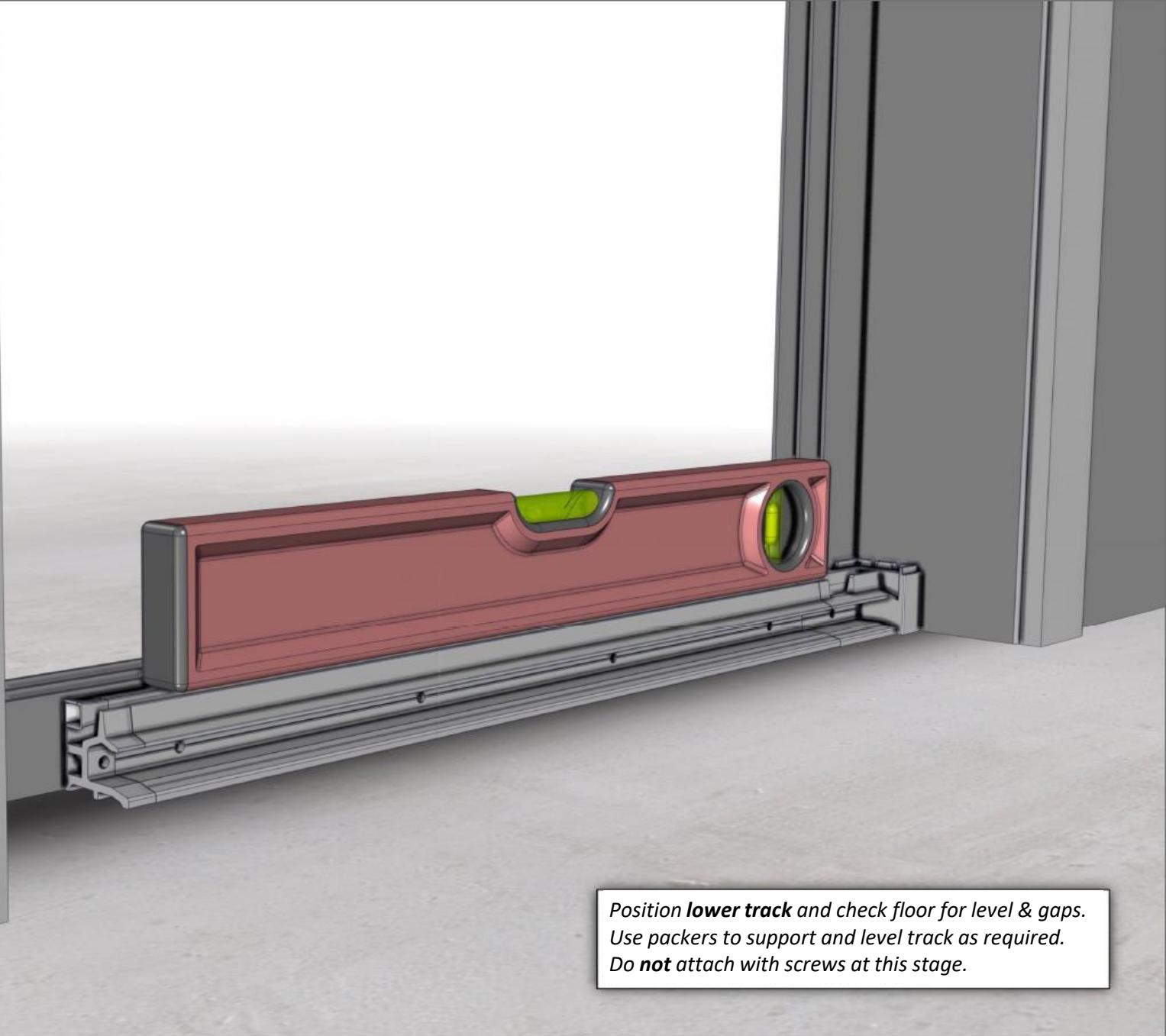

Position **lower track** and check floor for level & gaps.
Use packers to support and level track as required.
Do **not** attach with screws at this stage.

STEP-4

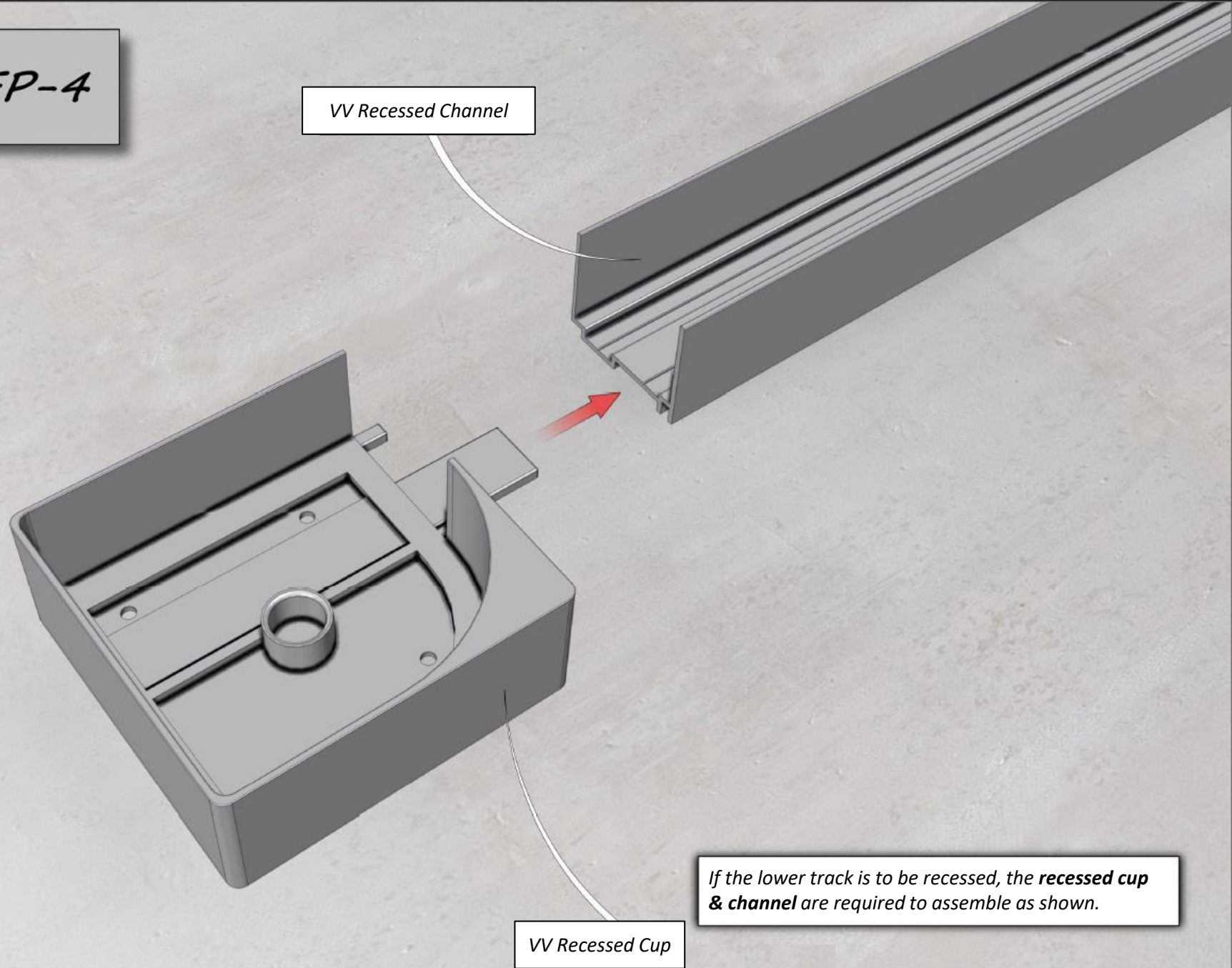

STEP-5

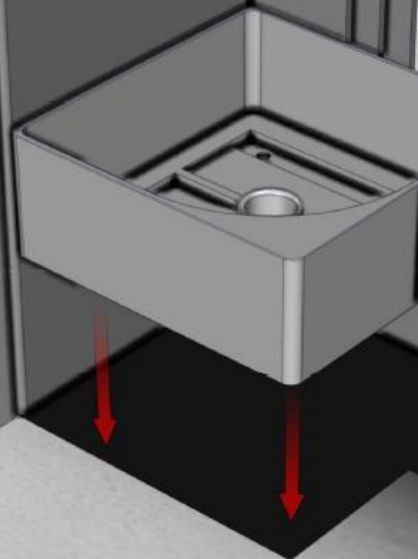

Install the assembled **recessed cup & channel** into pre-made floor cavity. Pack level and secure with silicone and/or screws.

STEP-6

VV+ Assembled Pull-bar

Housing
Endcap
Lug

Zipper

VV Track Guide A

Slide the **lower track** along the **pull-bar** and onto the **housing endcap lug**.

Carefully feed the **zipper** into the **track guide** without damaging.

STEP-7

DO NOT remove handle lock!

*Position the screen. Lower into **recessed cup & channel** if used.*

STEP-8

Housing Screw

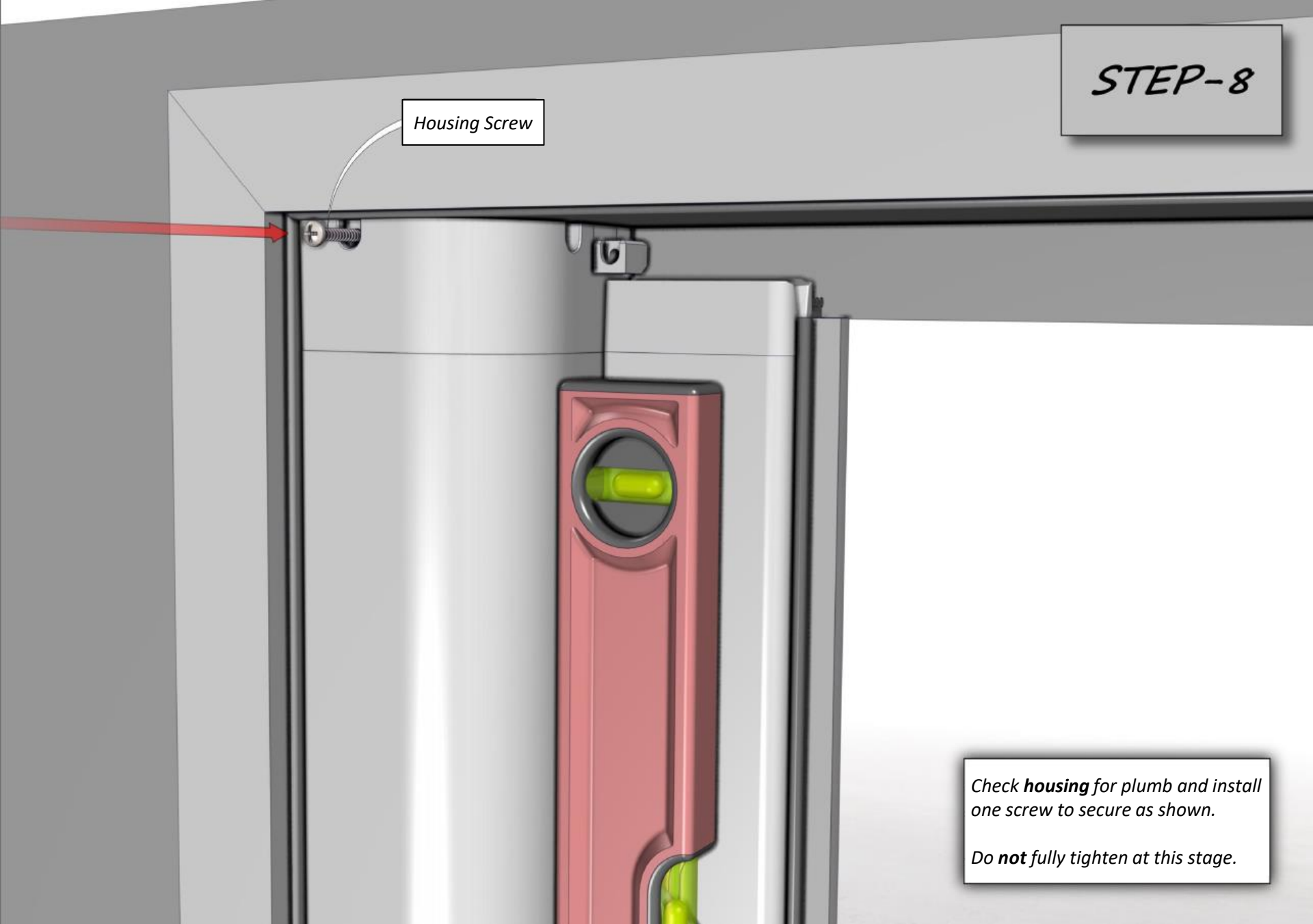

Check **housing** for plumb and install one screw to secure as shown.

Do **not** fully tighten at this stage.

STEP-9

DO NOT remove handle lock!

Ensure **lower track** is correctly positioned. Secure with provided #6 S/T screws.
Note: Do **not** screw the housing yet.

STEP-10

Housing Endcap Lug

DO NOT remove handle lock!

Slide the **upper track** along the **pull-bar** and onto the **housing endcap lug**, carefully feeding the **zipper** into the **track guide** without damaging.

STEP-11

Alternative screw groove

Fit receiver between **upper & lower latches**. Either lift the **upper track** over the spigots, or flex the **receiver** into position. Check that it sits flush, then screw.

STEP-12

VV Track

VV+ Latch B

VV Receiver

Ensure the **track**, **latch**, and **receiver** connections have no gaps. Then install the two screws as shown.

STEP-13

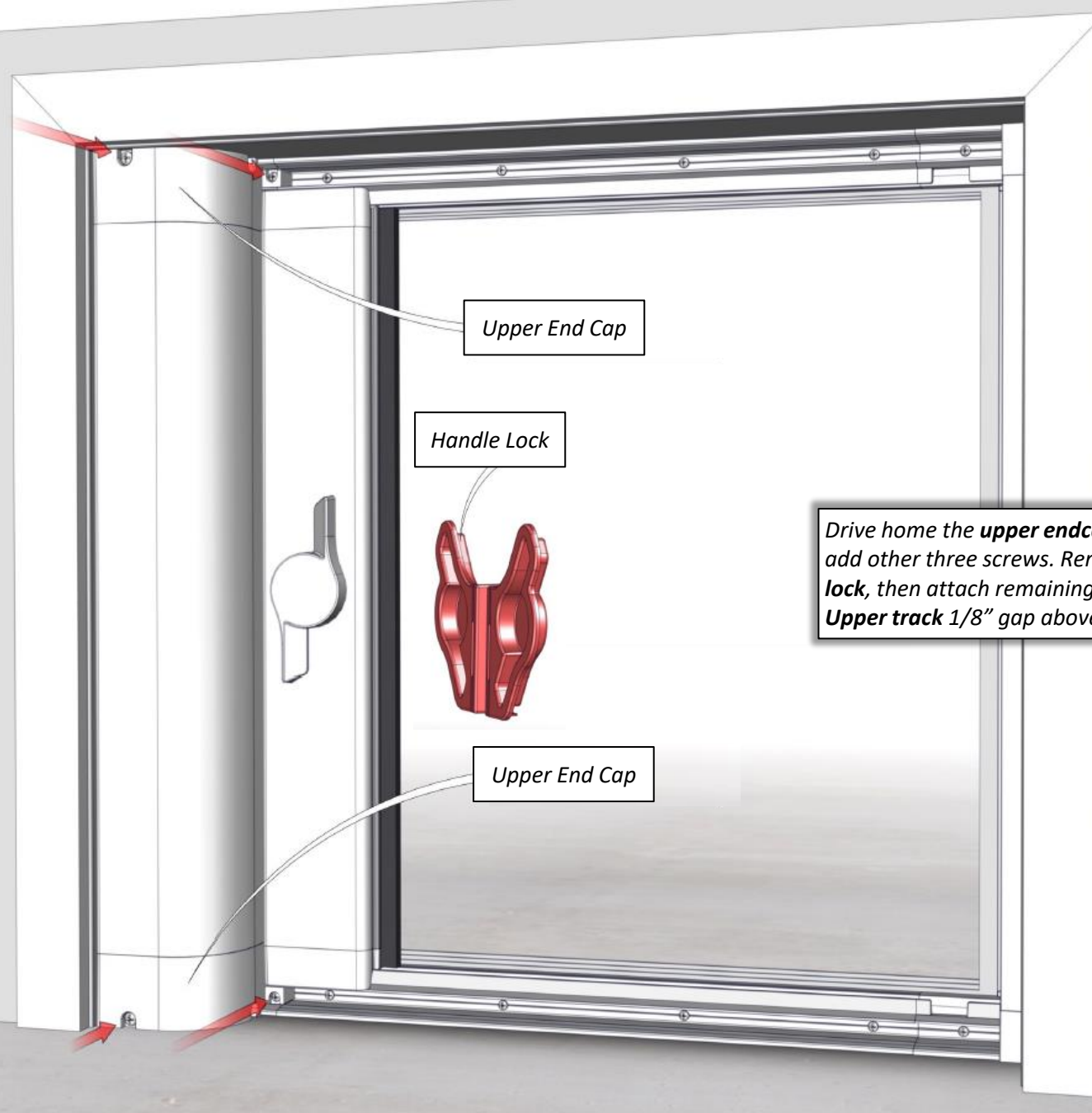

Drive home the **upper endcap screw**, then add other three screws. Remove **handle lock**, then attach remaining track screws. **Upper track** 1/8" gap above pull-bar.

STEP-14

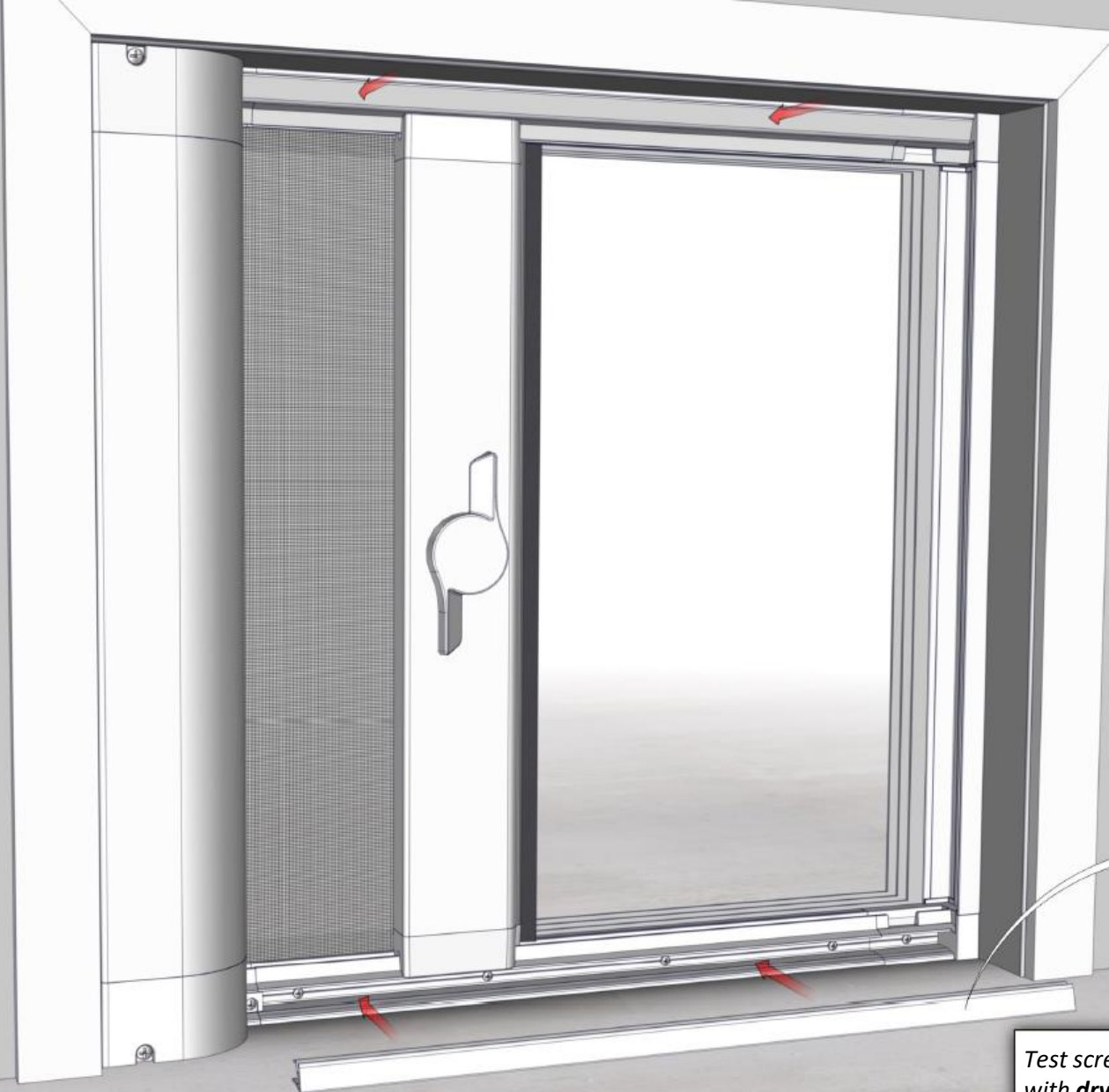

Optional Track Covers

*Test screen operation and lubricate with **dry silicone**. Install **optional track covers**. Installation is complete!*