

VistaView™ Plus 100 Low-Profile Install

STEP - 1

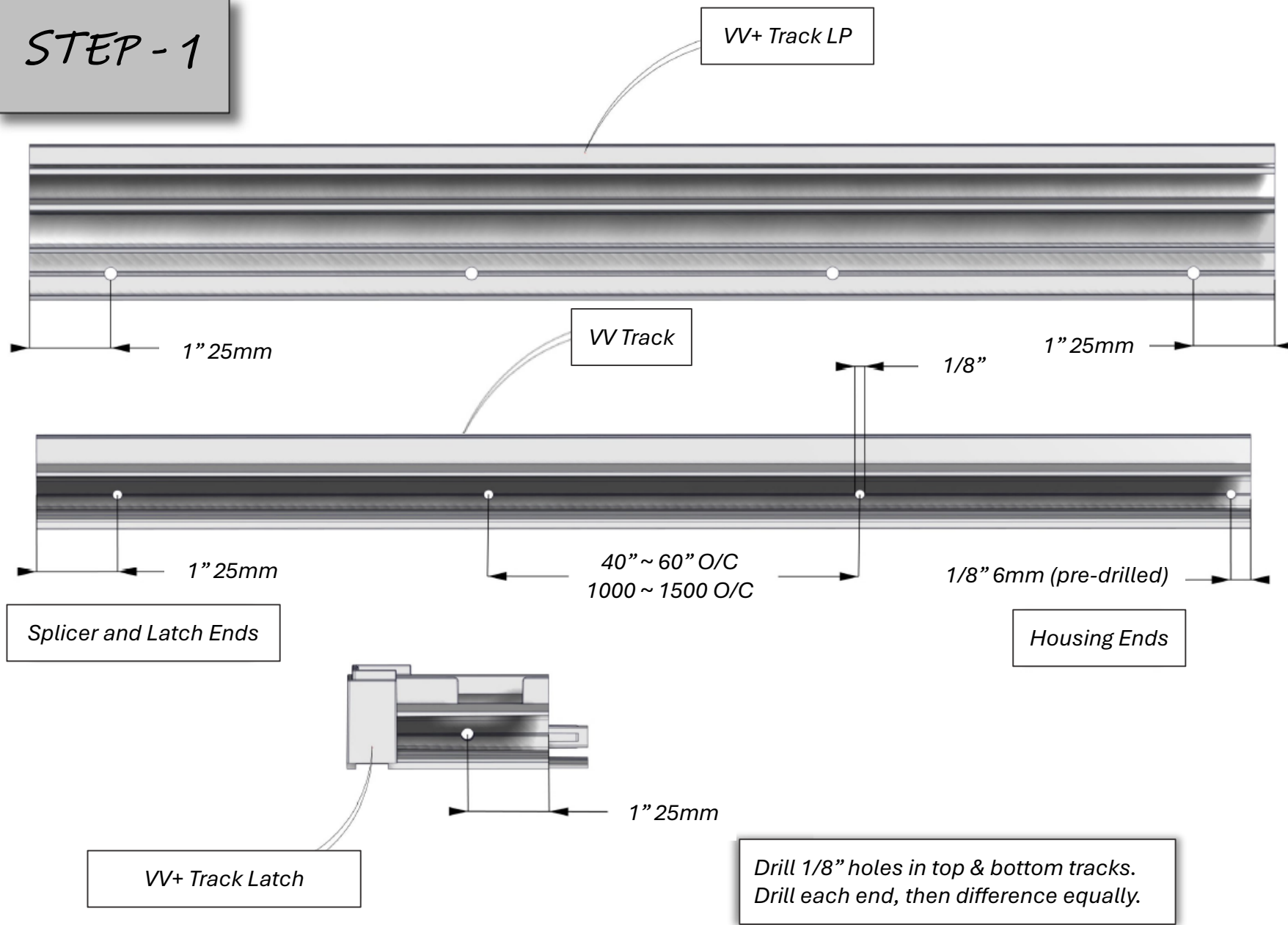

STEP - 2

Counter-sink entry end of zipper slot.

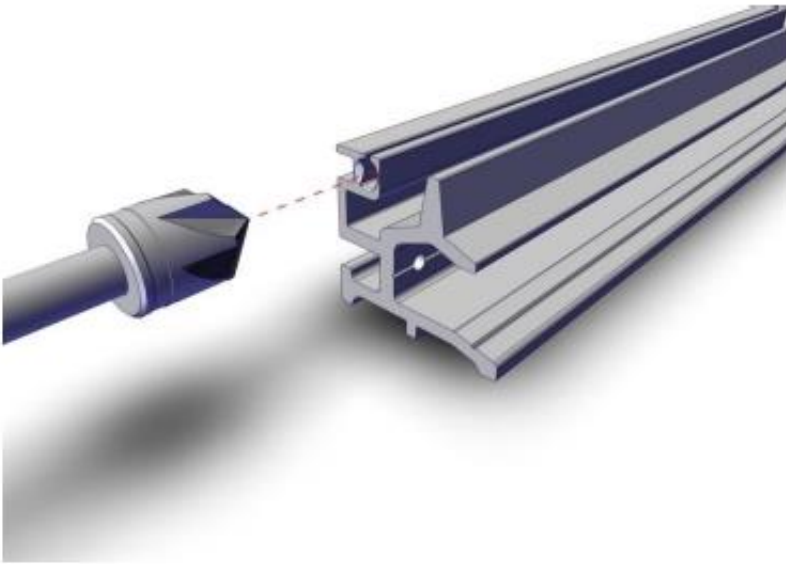

Use needle file to debur sharp corners on zipper slot.

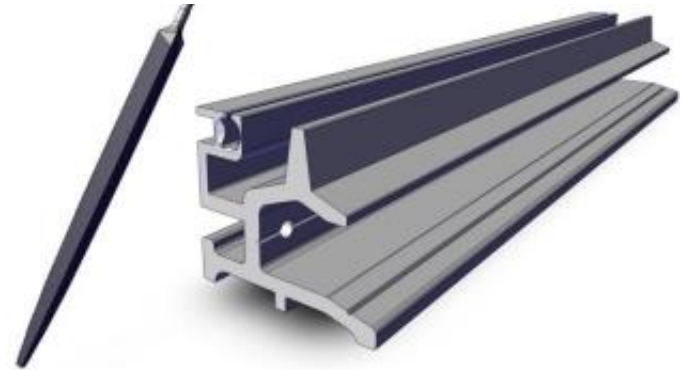

****Complete for both “STD Track ”
and “LP Track” (not shown)**

STEP - 3

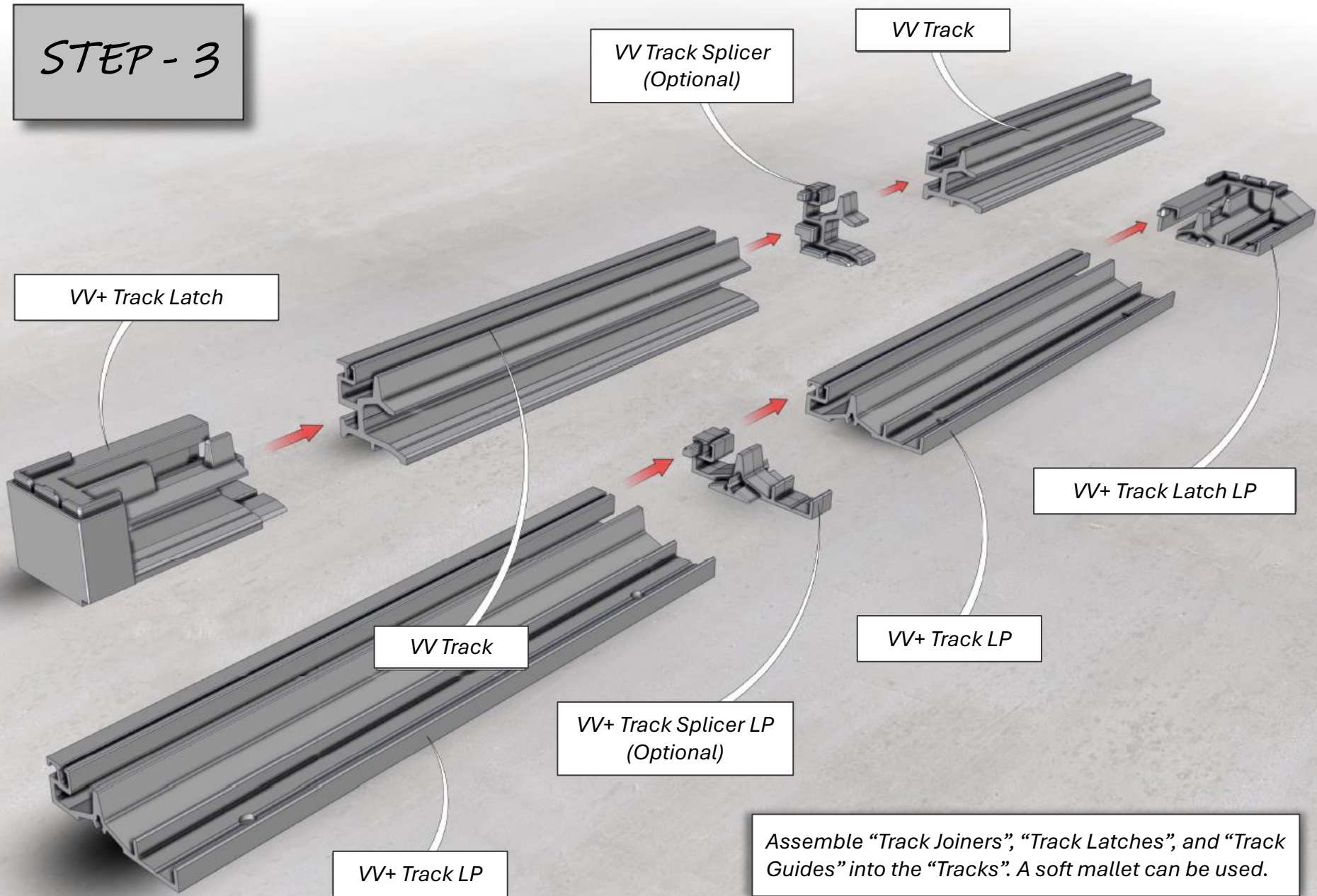

STEP - 4

VV+ Housing Mount LP

#6 Countersunk Screw

- 1) Install the 2 housing buttons, being careful not to over-tighten.
- 2) Lower housing assembly over the mounts, making sure it sits fully on floor.

STEP - 5

Screw Housing

Alternative Screw Location



Check "Housing" for level and install one screw to secure as shown.

Do not fully tighten at this stage.

STEP - 6

DO NOT remove handle lock!

VV+ Track LP

VV+ Track Splicer LP
(Optional)

*Ensure handle-lock remains on pull-bar until top and bottom tracks are installed.
Align first segment of lower track and feed onto pull-bar as shown in next step.*

STEP - 7

VV+ Assembled Pull-bar

Track Slot

Endcap Lug

Zipper

Feed bottom track along pull-bar, carefully feeding "Zipper" into "Track Guide" without damaging.

Continue to feed track up to housing and onto "Endcap lug"
"Doorframe not shown for clarity.

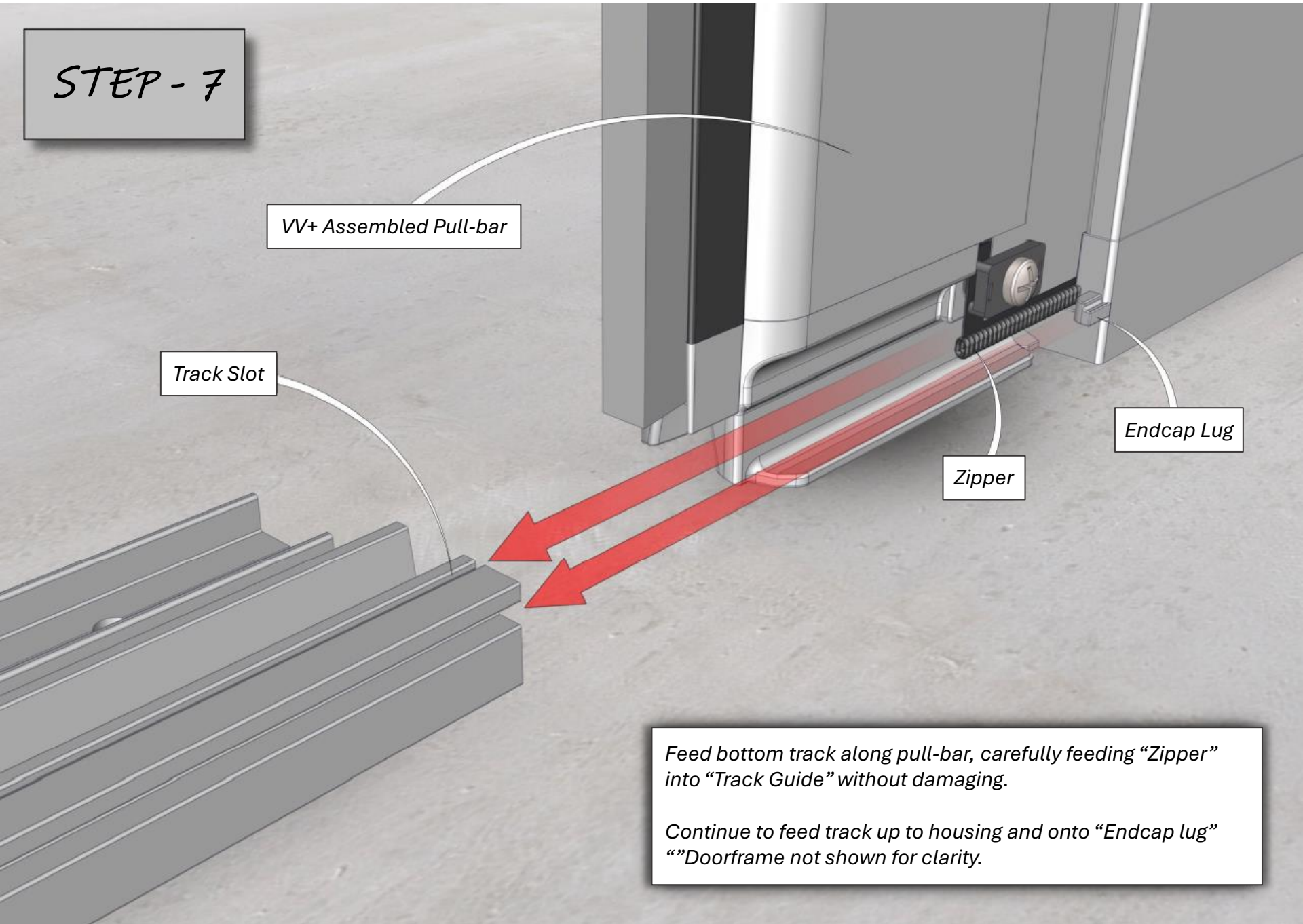

STEP - 8

DO NOT remove handle lock!

VV+ Track Latch LP

VV+ Track LP

Attach remaining segments of track. Final piece can be tilted into place if space is limited.

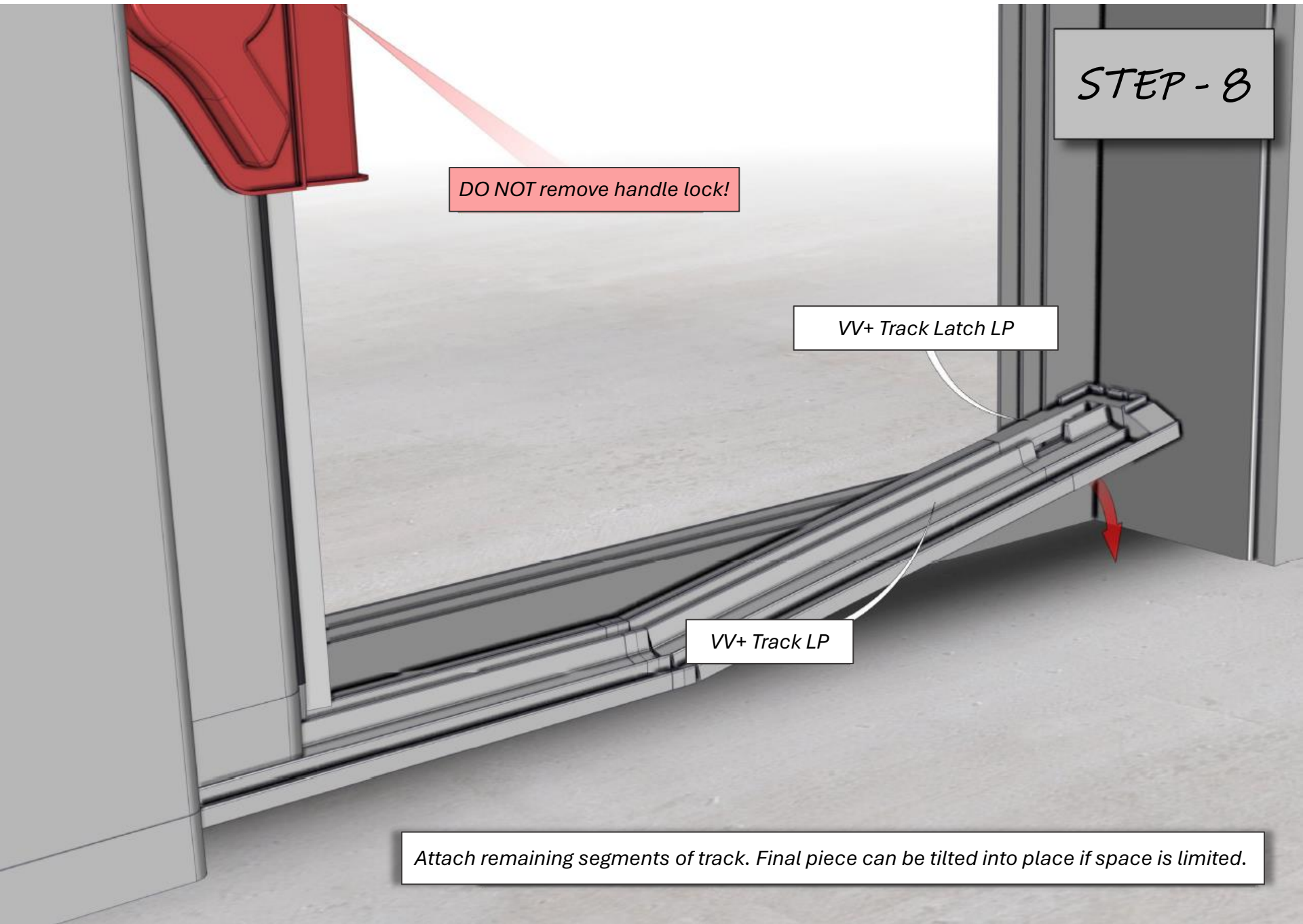

STEP - 9

DO NOT remove handle lock!

VV+ Track Cover Clip LP

VV+ Track Cover Clip LP

Ensure track is fully against housing, with no gaps at joints. Level track, placing packers under each screw location, if necessary. Secure "Track Cover Clips" with #6 screws into floor.

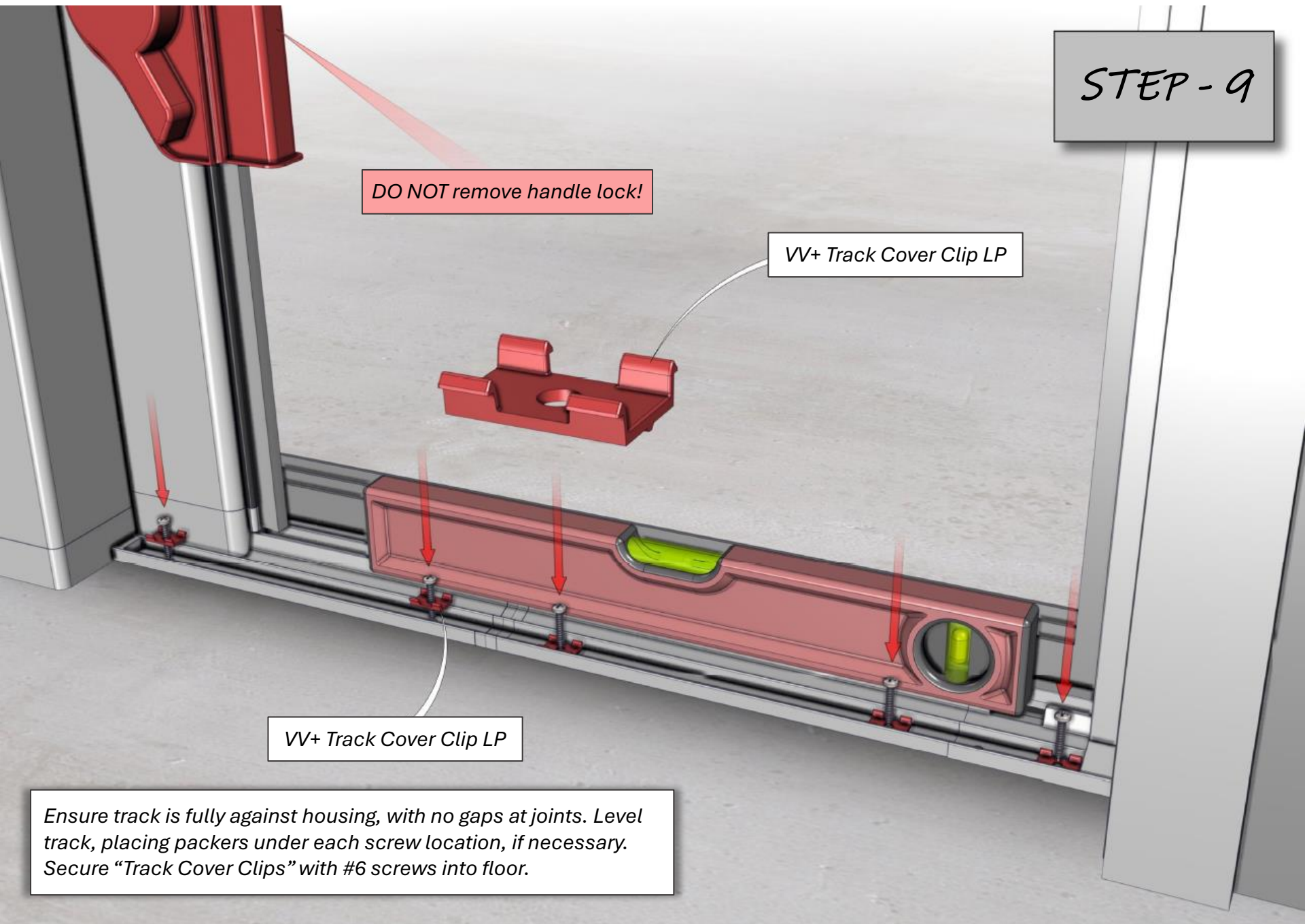

STEP - 10

Housing Lug

VV+ Track Splicer
(Optional)

VV Track

DO NOT remove handle lock!

*Feed bottom track along pull-bar, carefully feeding "Zipper" into
"Track Guide" without damaging.*

Continue to feed track up to housing and onto "Endcap lug".

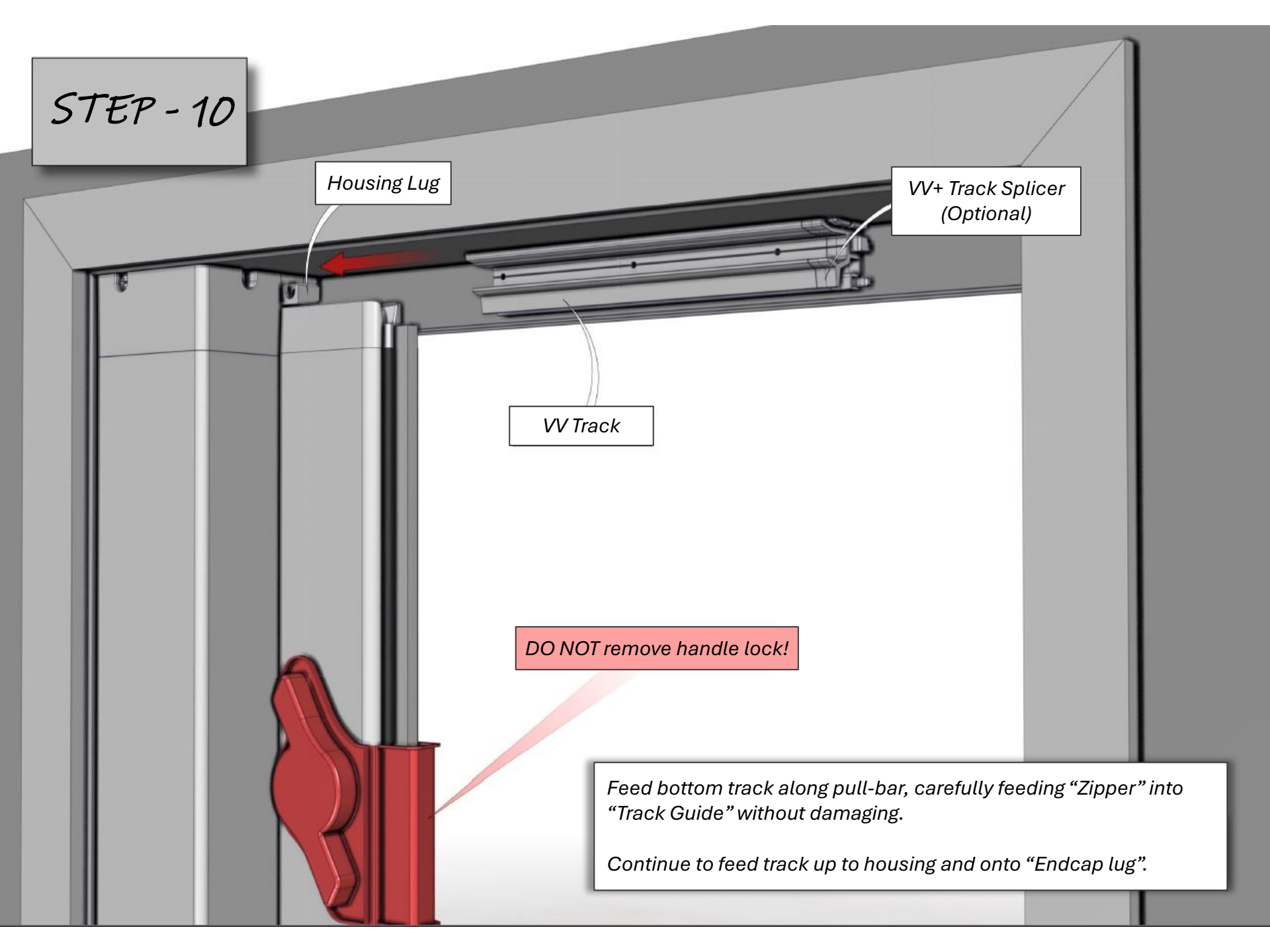

STEP - 11

VV+ Handle Lock



Handle rotates to brake position

Move pull-bar out to support end of top track segment, then remove "Handle Lock" to activate brake and maintain position.

STEP - 12

VV+ Track Latch

VV Receiver

Before fastening final "Track" segment, "Receiver" must be installed between top and bottom latches.

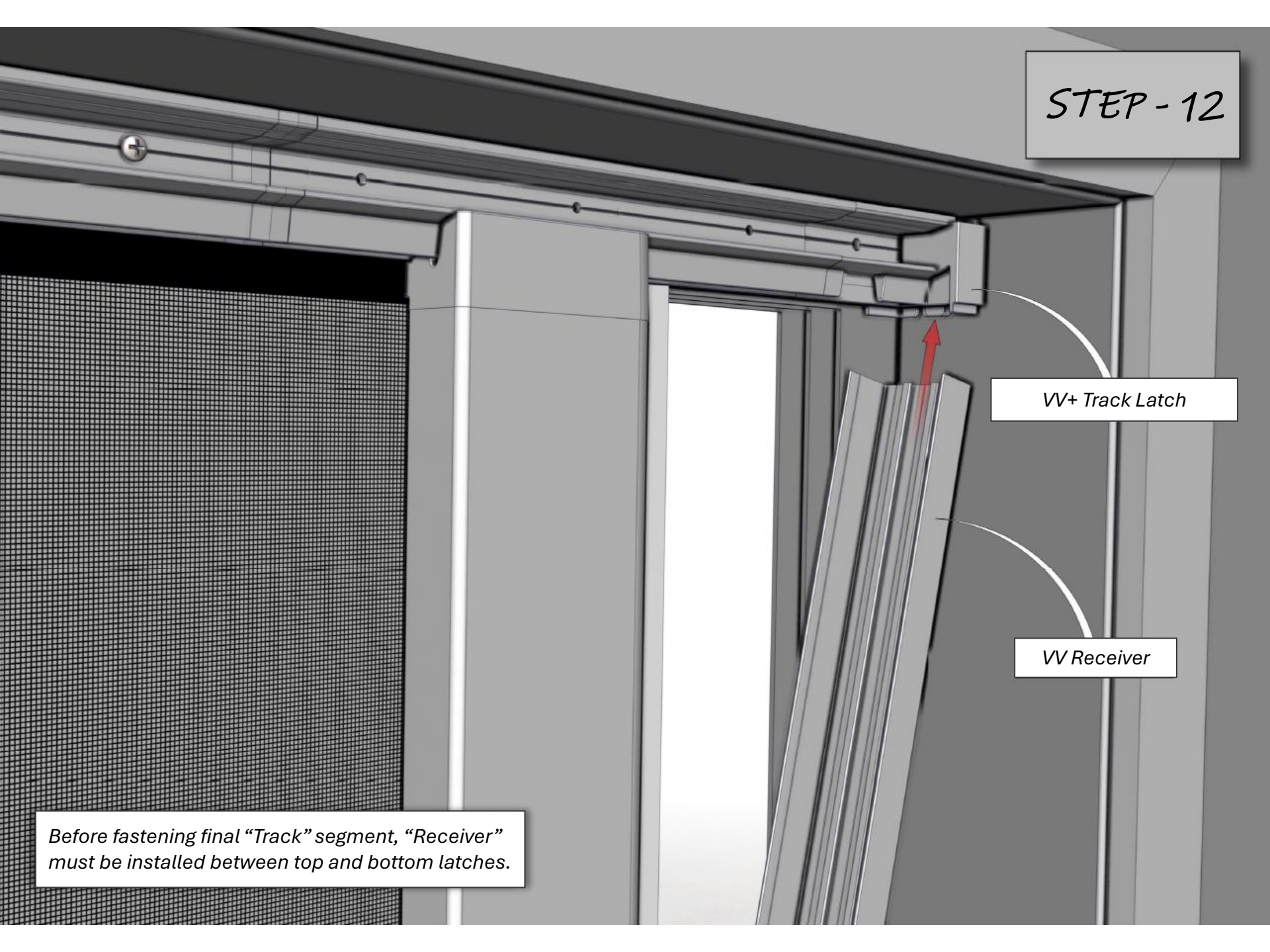

STEP - 13

VV Receiver

Fit "Receiver" between top and bottom "Track Latches". The top "Track" can be lifted over spigots, or receiver can be flexed into position (if no room).

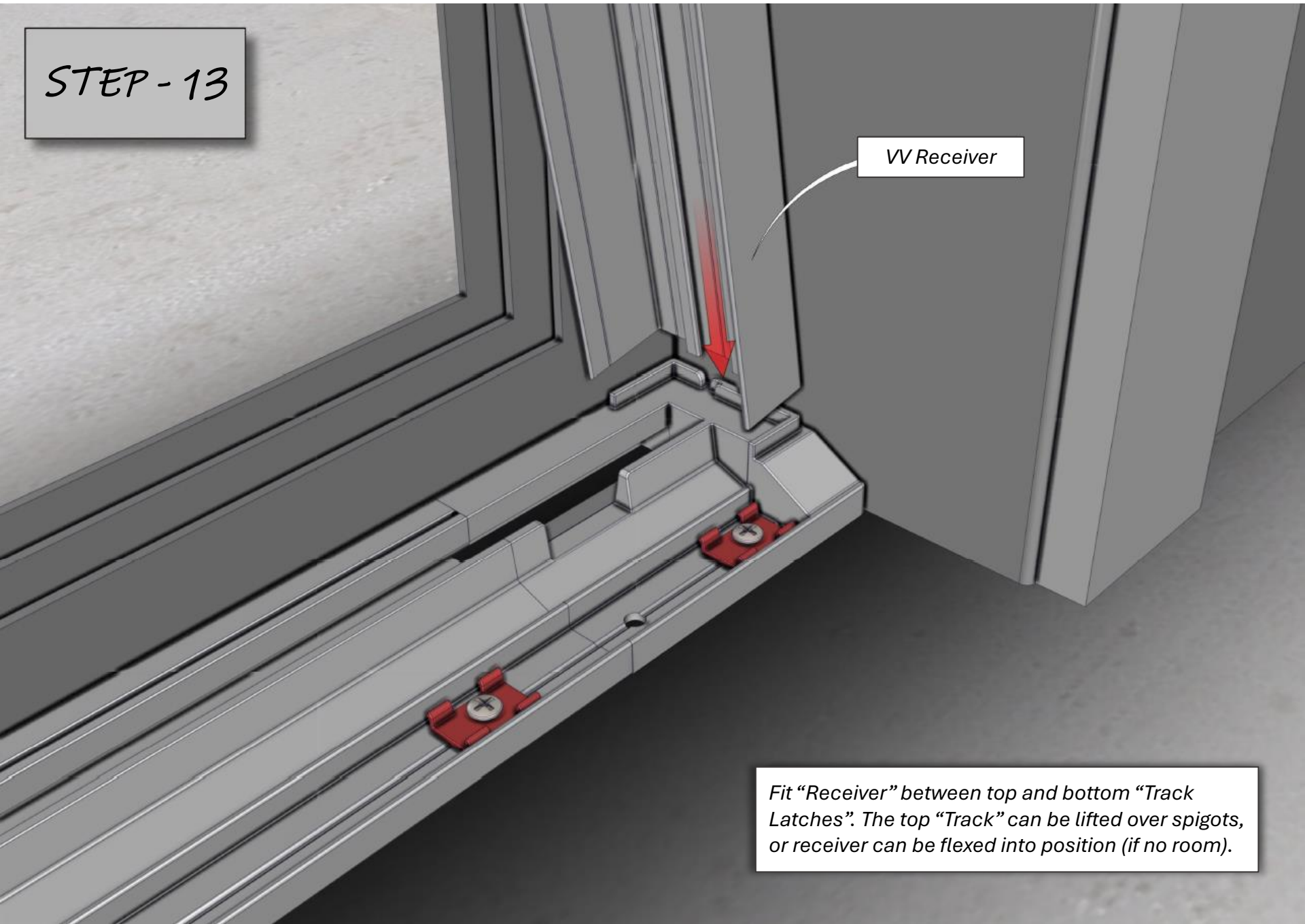

STEP - 14

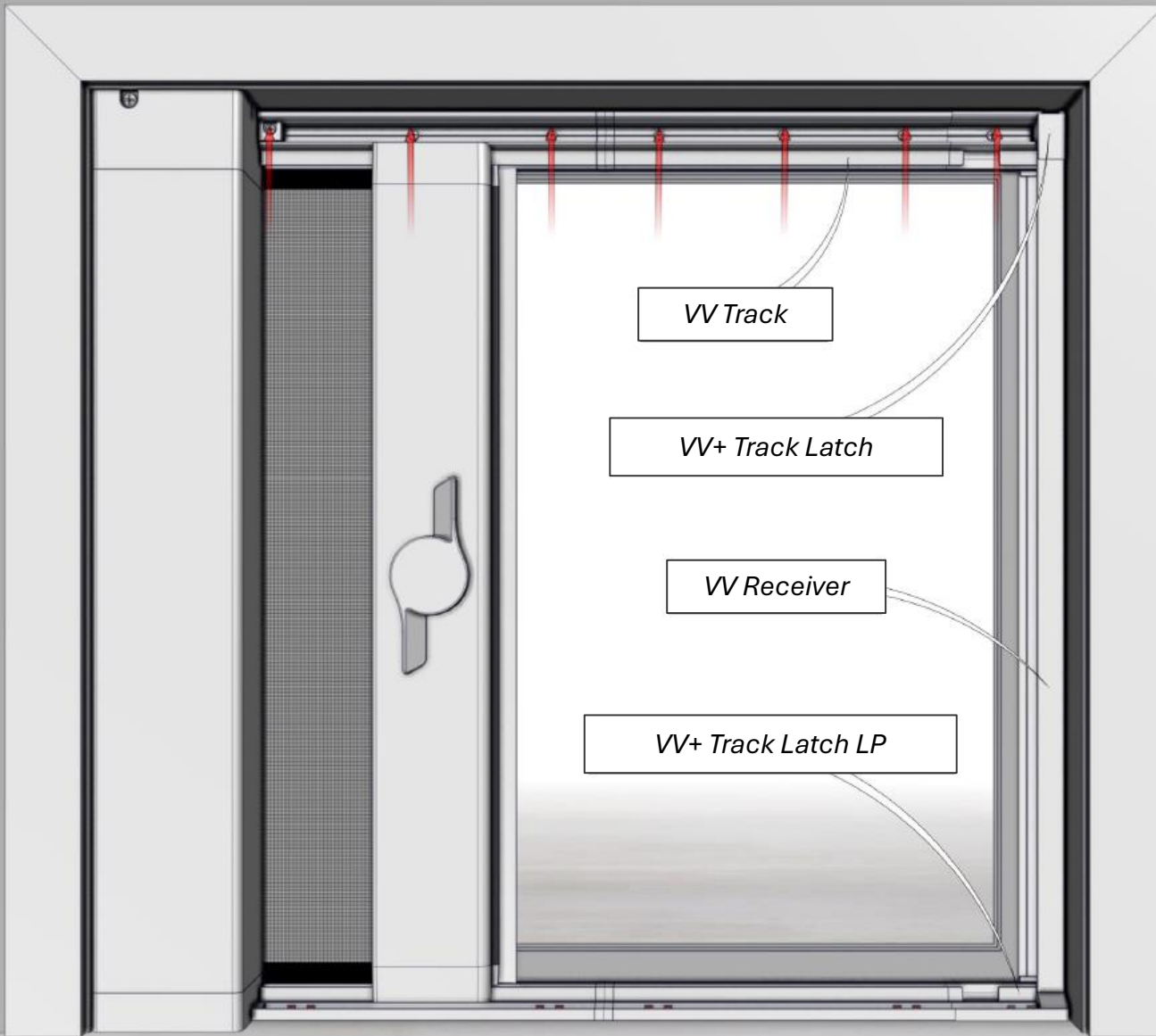

Ensure "Track", "Latch", and "Receiver" connections do NOT have gaps, then install remaining screws in upper "Track" and receiver.

STEP - 15

VV Track Cover
(Optional)

VV+ Track Cover LP

*Test screen operation and lubricate with
"Wizard Dry Silicone". Install "Track
Covers" top and bottom.*

