

VistaView™ & VistaView™ Plus

Track Splicer Guide

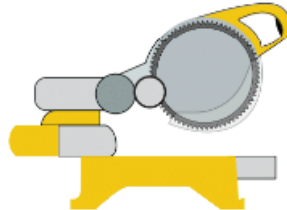

Chop Saw



Rubber Mallet



Level



Tape Measure

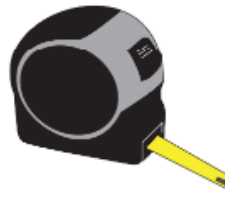

Pencil





VistaView™ Track Splicer



**| This page is applicable only if you |
| opted for tracks to be spliced. |**



***NOTE:** The **upper & lower tracks** will arrive cut *in-half* with extra. If you wish for the **track splicer** to be *centered*, you will need to follow **steps 1 & 2**.



1. For upper & lower **track pieces 1**, measure identical length & mark.

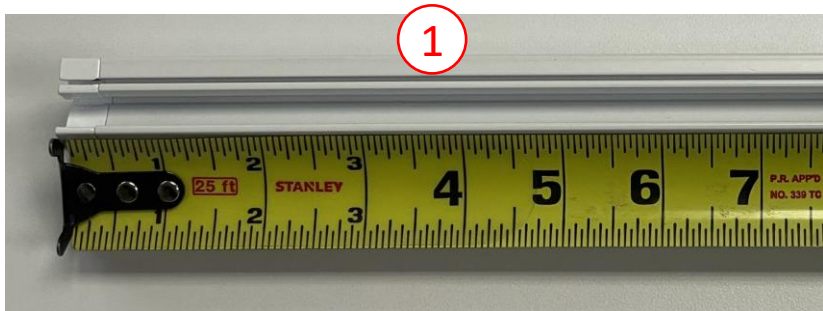

2. Cut lower & upper **track pieces 1**.



NEW
April 1
2025

VistaView™ Track Splicer

VistaView™

This page is applicable only if you opted for tracks to be spliced.

3. Mallet track splicers onto track pieces 1.

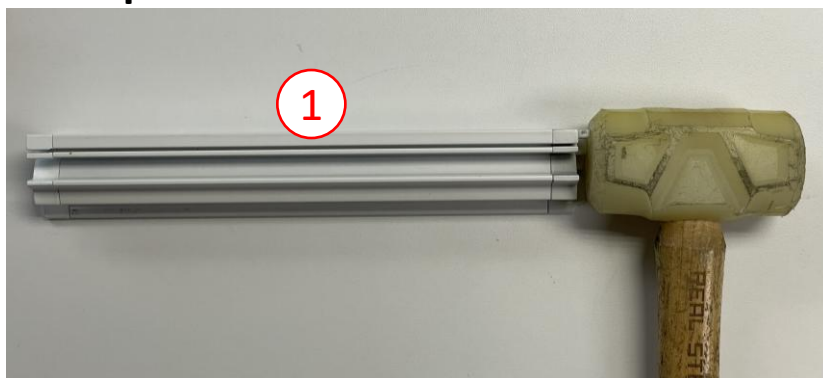

4. Connect track pieces 2.

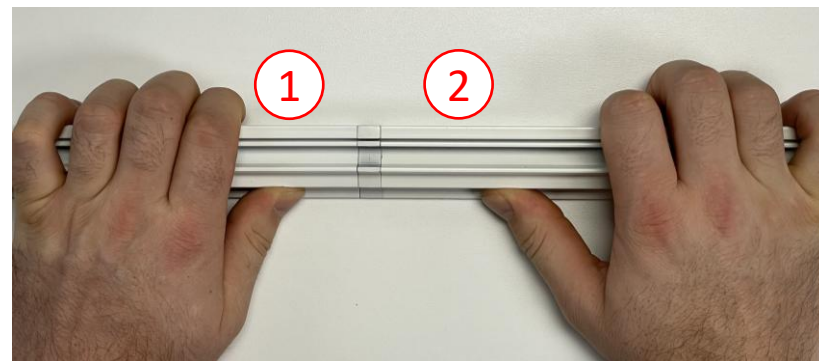

5. Measure connected track to desired length and mark.

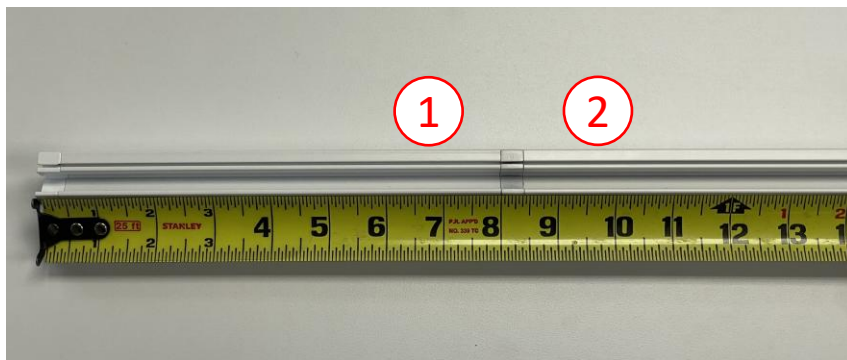

6. Cut connected track.

